



BEDFORD  
BOROUGH COUNCIL

## CA16 Application Form

### PART A

**Information relating to the applicant and land to which the application relates**  
*(all applicants must complete this Part)*

1. Name of appropriate authority to which the application is addressed:  
**Bedford Borough Council**

2. Name and full address (including postcode) of applicant:  
**A Brodie, Lower Dean, Huntingdon, Cambridgeshire, PE28 0LH**

3. Status of applicant (tick relevant box or boxes):

I A Brodie, am the owner of the land(s) described in paragraph 4.

4. Insert description of the land(s) to which the application relates (including full address and postcode):

**Lower Dean, Huntingdon, Cambridgeshire, PE28 0LH**  
**The land this application relates to is:**

**The field OS TL0569, Nat Grid Ref: 5376, known as Long March (Blue)**

This is the most north situated field with the 'Three Shire Way' bridle way running (DS/D22/A) west to east at the top of the field and the footpath, (DS/D18/A) running parallel on the opposite side of the field running up to the main road, the B645 which it meets at right angles

**The field OS TL0569, Nat Grid Ref: 7855 known as Pastures (Red)**

This is the field that neighbours the above field just to the south it butts up and joins the above field (Nat Grid Ref: 5376) and shares the footpath (DS/D18/A) with this neighbouring field. It's southern end borders the River Til

**The field OS TL0569, Nat Grid Ref: 5818 known as Packers Close.(Yellow)**

This field butts up to the village of Lower Dean and borders the River Til along it's northern border. It borders the village road coming out of Lower Dean. The footpath DS/D19/A3 and DS/D19/A2 cross this field at the corner next to the village and reaches up to the village road.

5. Ordnance Survey six-figure grid reference(s) of a point within the area of land(s) to which the application relates (if known):

**Long March ,      (marked Blue)      TL057697**  
**Pastures,            (marked Red)      TL058695**  
**Packers Close    (marked Yellow) TL055691**

6. This deposit comprises the following statement(s) and/or declarations (*delete Parts B, C, or D where not applicable*):

**PART B**

**Statement under section 31(6) of the Highways Act 1980**

I A Brodie am the owner of the land described in paragraph 4 of Part A of this form and shown Blue ,Red and Yellow on the map accompanying this statement.

Ways shown Green on the accompanying map are public bridleways.

Ways shown Brown on the accompanying map are public footpaths.

No other ways over the land shown Blue, Red and Yellow, on the accompanying map have been dedicated as highways.

**PART D**

**Statement under section 15A(1) of the Commons Act 2006**

I A Brodie am the owner of the land described in paragraph 4 of Part A of this form and shown Blue, Red and Yellow on the map accompanying this statement/deposited with Bedford Borough Council on Monday 7<sup>th</sup> November 2016.

I A Brodie wish to bring to an end any period during which persons may have indulged as of right in lawful sports and pastimes on the whole or any part of the land shown Blue, Red and Yellow on the accompanying map/map referenced above.

**PART F:**

**Statement of Truth**

**(all applicants must complete this Part)**

WARNING: If you dishonestly enter information or make a statement that you know is, or might be, untrue or misleading, and intend by doing so to make a gain for yourself or another person, or to cause loss or the risk of loss to another person, you may commit the offence of fraud under section 1 of the Fraud Act 2006, the maximum penalty for which is 10 years' imprisonment or an unlimited fine, or both.

I BELIEVE THAT THE FACTS AND MATTERS CONTAINED IN THIS FORM ARE TRUE

Signature (*of the person making the statement*)

Print full name:

Date: Monday 7<sup>th</sup> November 2016

You should keep a copy of the completed form

**Data Protection Act 1998 - Fair Processing Notice**

The purpose of this Fair Processing Notice is to inform you of the use that will be made of your personal data, as required by the Data Protection Act 1998.

The appropriate authority (see explanation of definition in above guidance notes) in England is the data controller in respect of any personal data that you provide when you complete this form.

The information that you provide will be used by the appropriate authority in its duties to process applications to deposit statements, maps and declarations under section 31(6) the Highways Act 1980 and statements under section 15A(1) of the Commons Act 2006. The information you provide will also be used by the appropriate authority in its duty to update the registers in which details of such deposits are recorded under the Dedicated Highways (Registers under Section 31A of the Highways Act 1980) (England) Regulations 2007 and the Commons (Registration of Town or Village Greens) and Dedicated Highways (Landowner Statements and Declarations) (England) Regulations 2013.

The appropriate authority is required by the legislation above to maintain a register which holds information provided in this form, which can be inspected online or in person by members of the public on request. It may also be required to release information, including personal data and commercial information, on request under the Environmental Information Regulations 2004 or the Freedom of Information Act 2000. However, the appropriate authority will not permit any unwarranted breach of confidentiality nor will they act in contravention of their obligations under the Data Protection Act 1998.

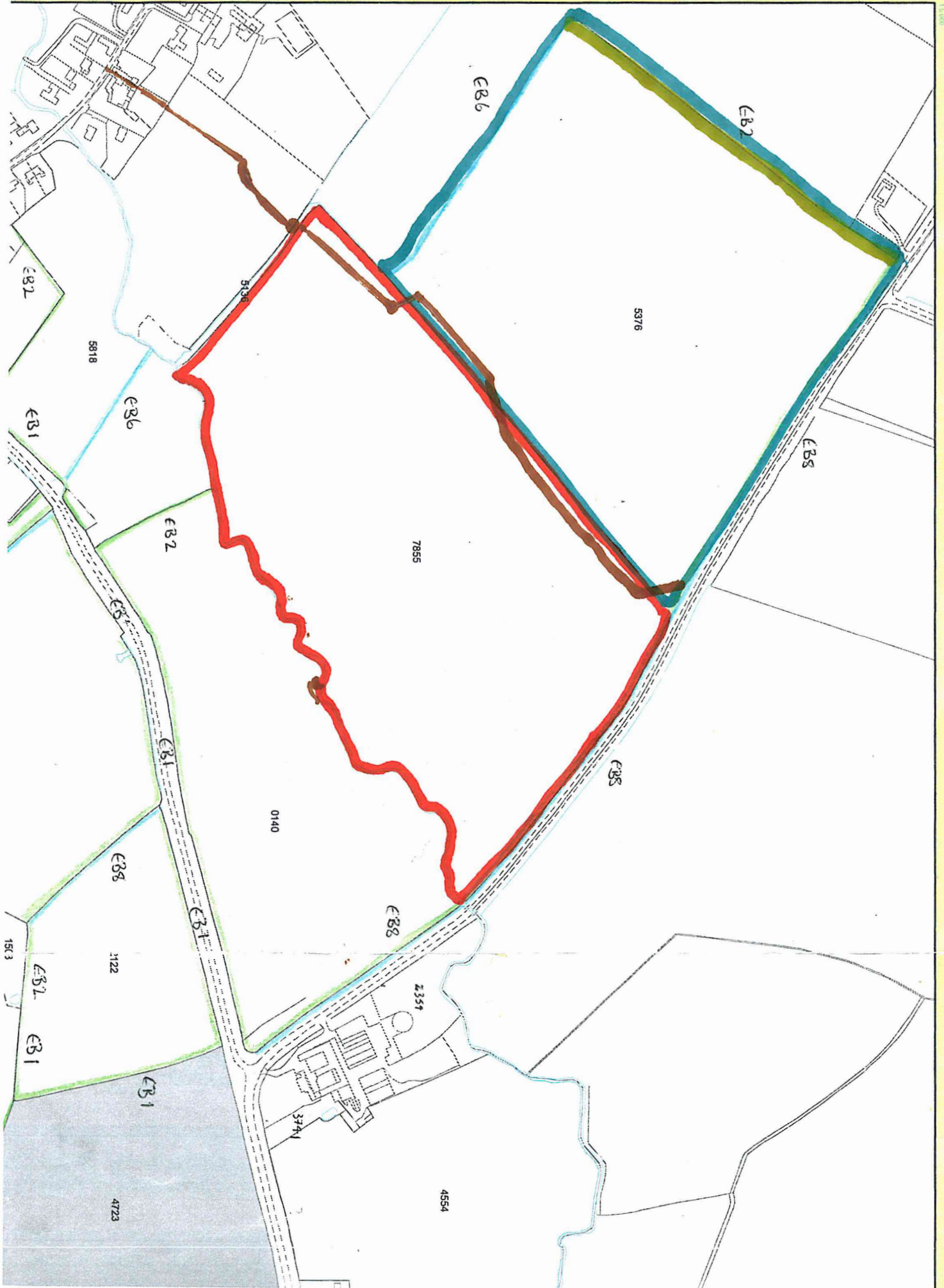



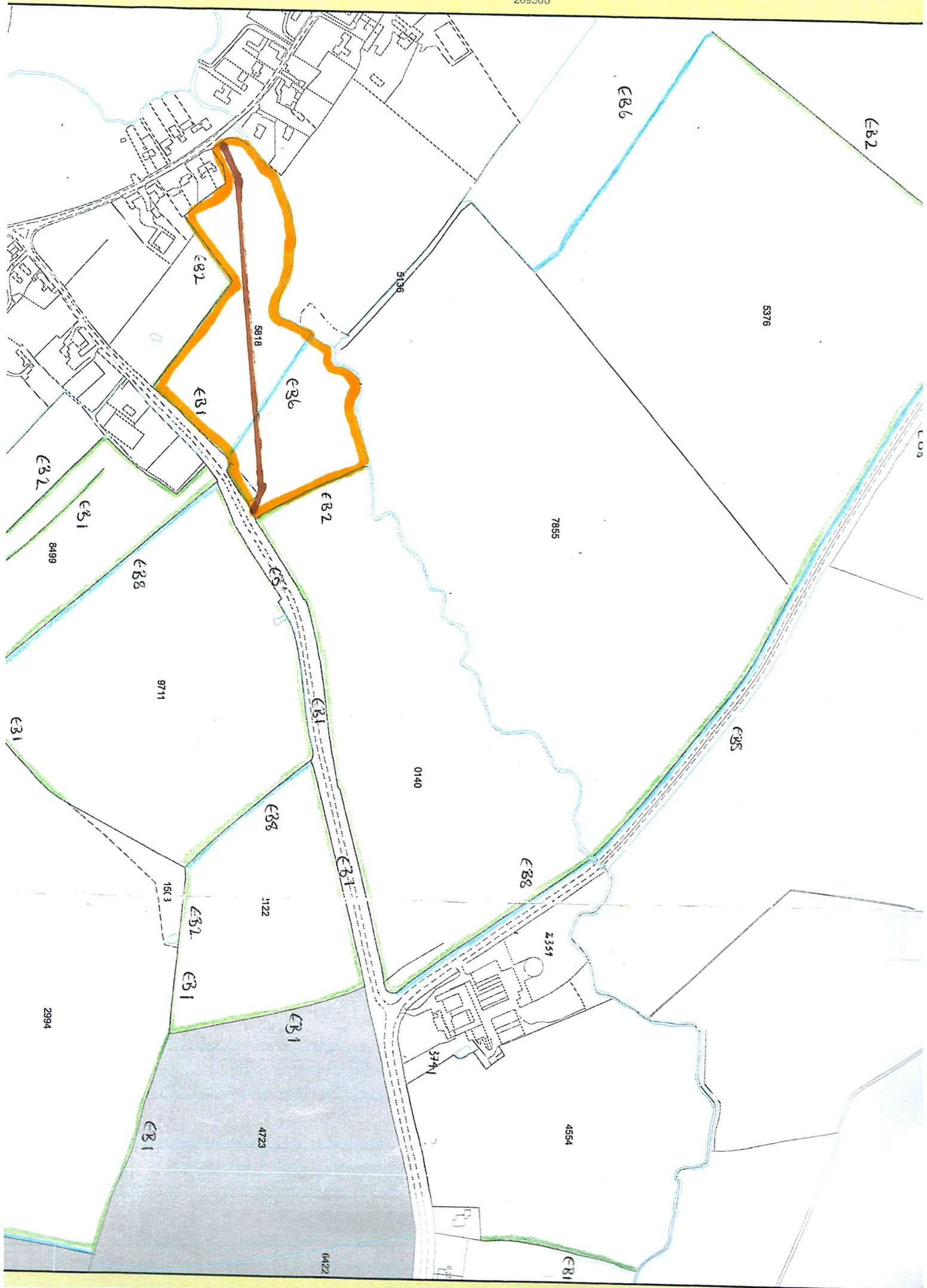



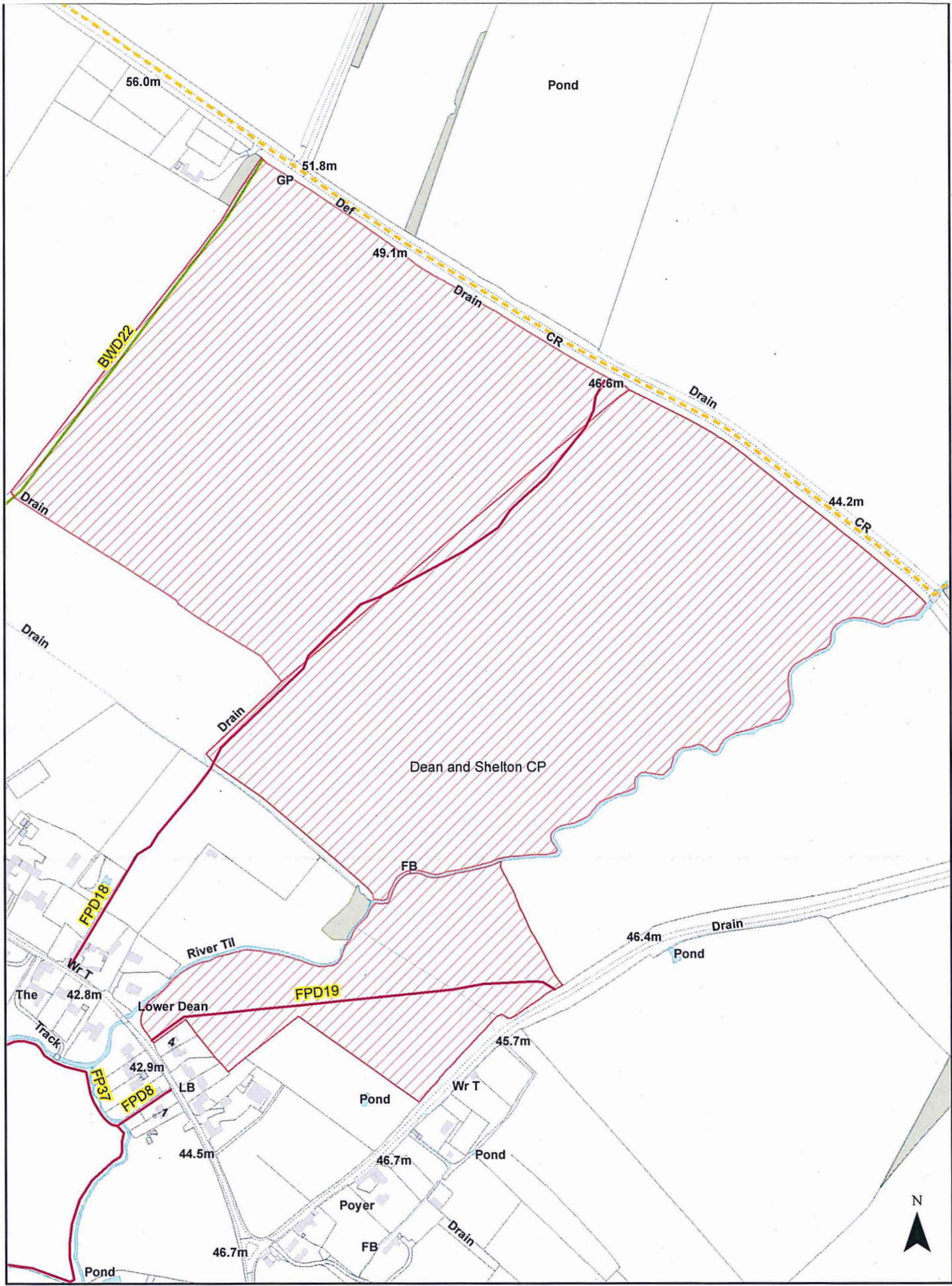

- PUBLIC FOOTPATH
- PUBLIC BRIDLEWAY
- BYWAY OPEN TO ALL TRAFFIC (BOAT)
- BEDFORD BOROUGH BOUNDARY
- PARISH BOUNDARY

Date: 29/11/2016  
 1:5,000  
 A4P



**S31 - MR BRODIE**