



PUBLIC NOTICE

BEDFORD BOROUGH COUNCIL PROPOSE TO INTRODUCE NEW PARKING RESTRICTIONS IN FOLKES ROAD ,ASHPOLE AVENUE & HARRIS WAY, WOOTTON

Reason for Proposal:

Bedford Borough Council proposes to introduce parking restrictions in Folkes Road, Ashpole Avenue, and Harris Way, and access restrictions in Folkes Road loop. The restrictions are deemed necessary to maintain safety for highway users of the main access roads into the development, and those attending the school in Harris Way.

Effect of the Order:

1. To introduce “No waiting at any time” restrictions (double yellow lines) on the following lengths of road:

A	Folkes Road, Wootton
(i)	On its western kerb, extending from a point approx. 13 metres south west of the projected south western wall of house no. 40 Folkes Road in a southerly direction to the northern loop of Folkes Road.
(ii)	On its eastern kerb, extending from a point approx. 8 metres south west of the projected south western wall of house no. 39 Folkes Road in a southerly direction to the northern loop of Folkes Road.
(iii)	On the north side of its northern loop, from the centre of Folkes Road for a distance of approx. 14 metres in a westerly direction.
(iv)	On the north east side of its northern loop, from the centre of Folkes Road extending in a southerly and then south westerly (clockwise) direction to a point approx. 50 metres south west of the centre of Harris Way.
(v)	On the south side of its northern loop, from a point approx. 14 metres west of the centre of Folkes Road extending in a southerly and then south westerly (clockwise) direction to Ashpole Avenue.
B	Ashpole Avenue, Wootton
(i)	On its north eastern kerb, extending from Folkes Road for a distance of approx. 10 metres in a north westerly direction.
(ii)	On its south western kerb, extending from Folkes Road for a distance of approx. 22.5 metres in a north westerly direction.
C	Harris Way, Wootton
(i)	At its south eastern end, on its south eastern kerb and then on its north eastern kerb extending from its south eastern end for a distance of approx. 63 metres in a north westerly direction.
(ii)	On its north eastern kerb extending from a point approx. 122.5 metres north west of its south eastern end to Folkes Road.
(iii)	On its south western kerb extending from a point approx. 122 metres north west of its south eastern end to Folkes Road.

1. To introduce ‘No waiting Mon – Fri 8am – 5pm’ restrictions (single yellow line) on the following length of road:

A	Harris Way, Wootton
(i)	On its north eastern kerb, extending from a point approx. 63 metres north west of the south eastern end of the road for a distance of approx. 59.5 metres in a north westerly direction.

2. To introduce “No stopping on entrance markings” restrictions on the following length of road:

A	Harris Way, Wootton
(i)	On its south western kerb, in 2 identical sections, extending from the south eastern end of the road for a combined distance of approx. 76 metres in a north westerly direction.

Relevant proposal documents are currently only available for viewing on the council’s website at www.bedford.gov.uk/proposedtro due to COVID-19 restrictions. The documents will be placed on deposit until 6 weeks after the Order is made or until it is decided not to continue with the proposal. For further information, please contact Julie Brockett at Bedford Borough Council on 01234 276691.

Comments supporting or objecting to the proposal should be put in an email, stating the grounds on which they are made, and sent no later than 11th May 2023 to highway.consultations@bedford.gov.uk.

Order Title if made will be:

1. Bedford Borough Council (Parish of Wootton, Bedford) (Prohibition and Restriction of Waiting, Loading and Stopping) Order 2016 (Amendment No.**)
Order 20**.

Dated: 13th April 2023

Borough Hall, Cauldwell Street
Bedford, MK42 9AP

Craig Austin
Director of Environment



BEDFORD
BOROUGH COUNCIL

BEDFORD BOROUGH COUNCIL

**(PARISH OF WOOTTON, BEDFORD) (PROHIBITION AND RESTRICTION OF
WAITING, LOADING AND STOPPING) ORDER 2016
(AMENDMENT NO.4) ORDER 2023**

BEDFORD BOROUGH COUNCIL (“the Council”) in exercise of the powers conferred by Sections 1(1), 2(1) to (3) and 4(2) of, and Part IV of Schedule 9 to, the Road Traffic Regulation Act 1984 (“the Act”) and of all other powers enabling them in that behalf, and after consultation with the Chief Officer of Police in accordance with Part III of Schedule 9 to the Act, hereby make the following Order:-

1. This Order may be cited as the “Bedford Borough Council (Parish of Wootton, Bedford) (Prohibition and Restriction of Waiting, Loading and Stopping) Order 2016 (Amendment No.4) Order 2023” and shall come into force on 5th June 2023.
2. As from the date upon which this Order comes into force the provisions of the Bedford Borough Council (Wootton) (Prohibition and Restriction of Waiting and Loading and Parking Places) (Consolidation) Order 2018 as amended shall be varied as follows:
 - (i) The new plan schedule reference “Grid Ref: G 9 Revision No: 0” shall be inserted.
 - (ii) The new plan schedule reference “Grid Ref: H 9 Revision No: 0” shall be inserted.
3. This Amendment shall be read and construed as one with the Bedford Borough Council (Wootton) (Prohibition and Restriction of Waiting and Loading and Parking Places) (Consolidation) Order 2018 as amended.

**THE COMMON SEAL of the
BEDFORD BOROUGH COUNCIL**

was hereunto affixed this

1st day of June 2023

in the presence of:



Authorised Signatory

**Wai K. Tsang
Solicitor
Legal Services
Bedford Borough Council**

A handwritten signature in black ink, appearing to read 'Wai K. Tsang'.

AUTHORITY FOR EXECUTION		
COUNCIL/COMMITTEE	MINUTE No.	DATE
DELEGATED POWER	By whom executed ENVIRONMENT	01/06/2023
	OFFICERS INITIALS	DATE
ORIGINATED AND CHECKED BY	GM	01/06/2023
APPROVED BY	AP	01/06/2023



BEDFORD BOROUGH COUNCIL
(PARISH OF WOOTTON, BEDFORD) (PROHIBITION AND RESTRICTION OF
WAITING, LOADING AND STOPPING) ORDER 2016
(AMENDMENT NO.4) ORDER 2023

STATEMENT OF REASONS

Bedford Borough Council proposes to introduce parking restrictions in Folkes Road, Ashpole Avenue, and Harris Way, and access restrictions in Folkes Road loop. The restrictions are deemed necessary to maintain safety for highway users of the main access roads into the development, and those attending the school in Harris Way.

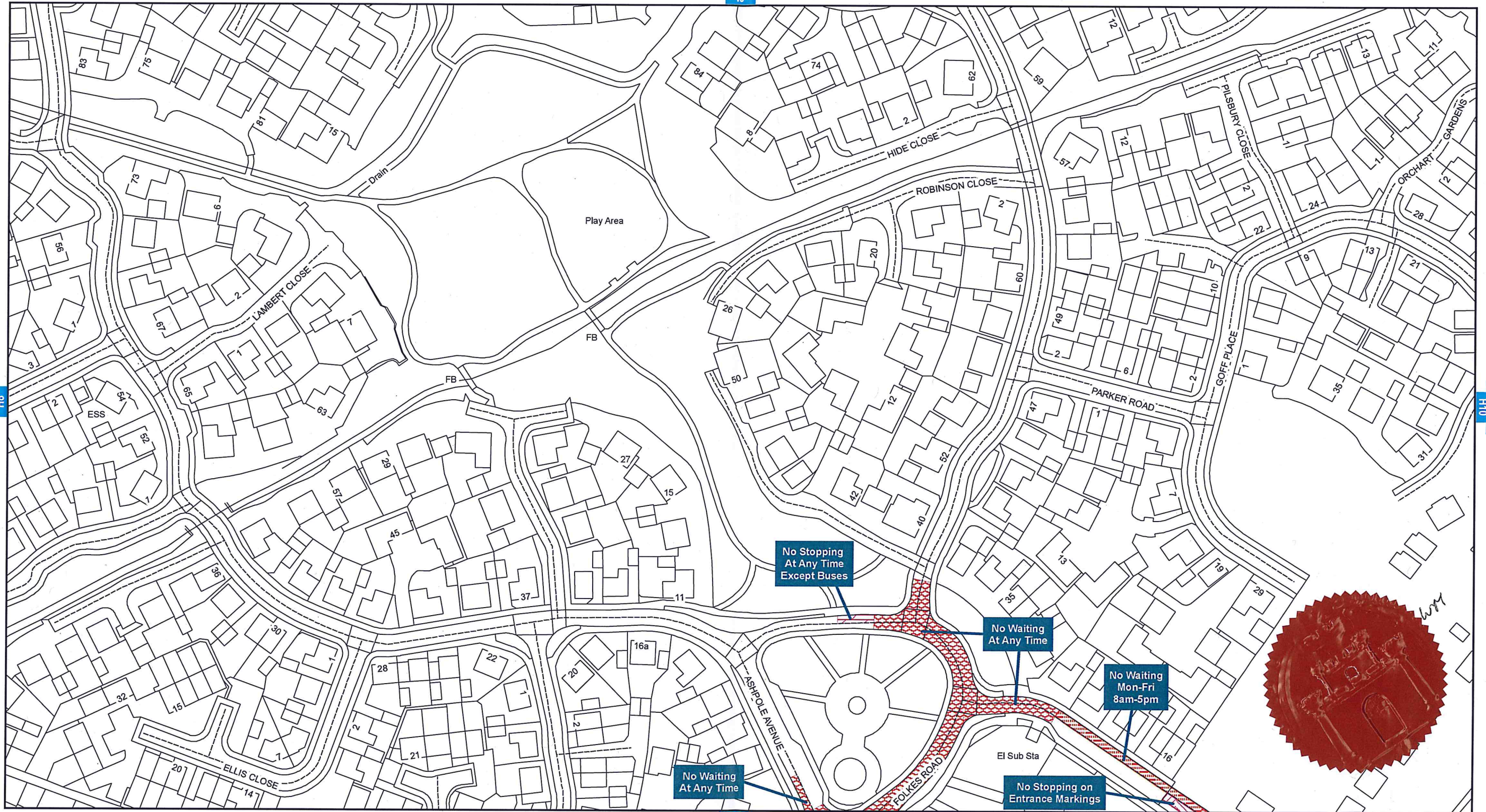

**BEDFORD BOROUGH COUNCIL (PARISH OF WOOTTON, BEDFORD)
(PROHIBITION AND RESTRICTION OF WAITING, LOADING AND STOPPING)
ORDER 2016**

**Bedford Borough Council
Borough Hall
Cauldwell Street
Bedford MK42 9AP**

Reproduced from the Ordnance Survey map with the permission of Her Majesty's Stationary Office © Crown Copyright Licence No. LA077127 (2021). Unauthorised reproduction infringes Crown Copyright and may lead to prosecution or civil proceedings.

Scale - 1:1,250 @ A3



Grid Ref: G9

Revision No: 0
Date: 5th June 2023

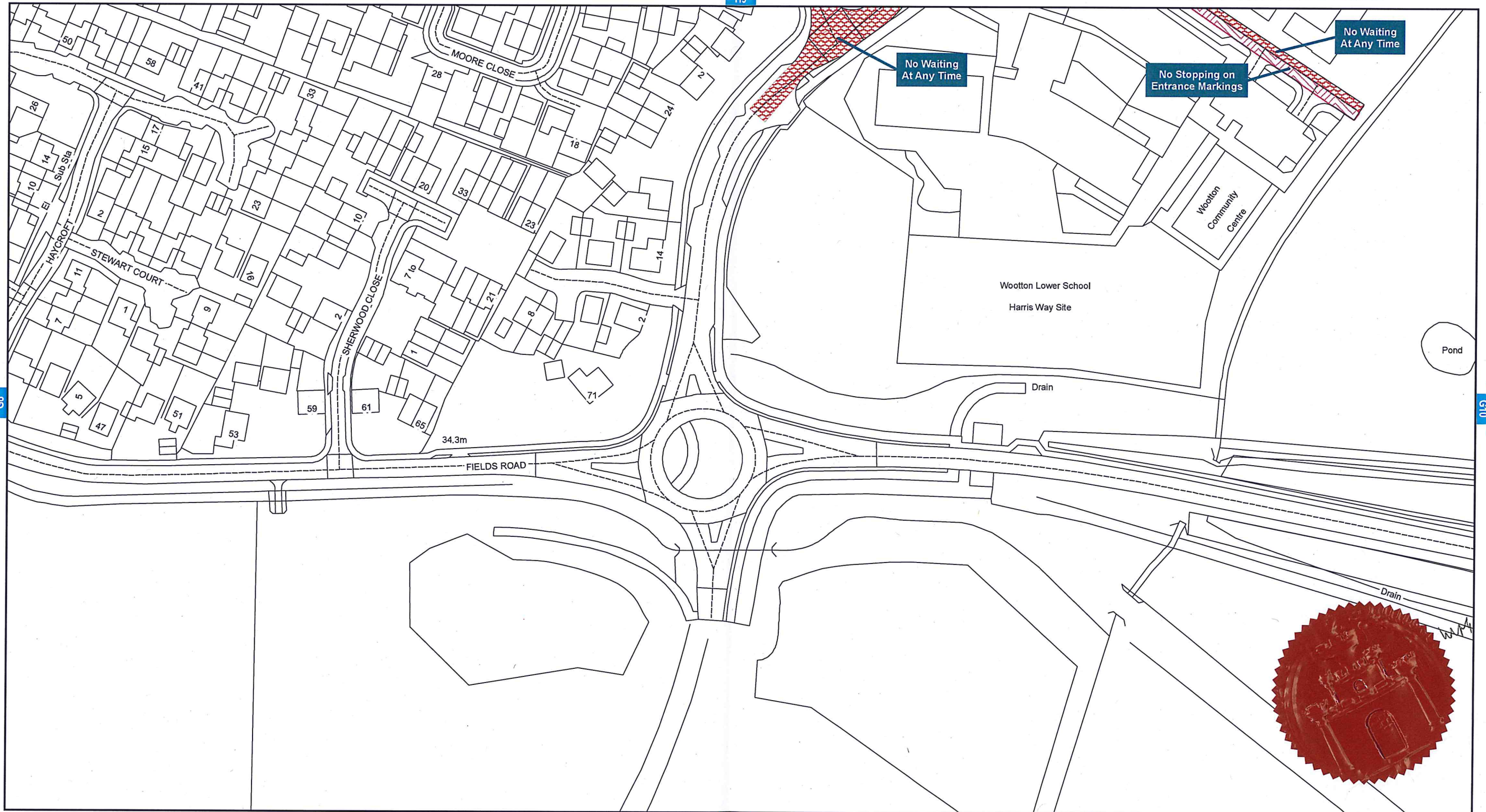

**BEDFORD BOROUGH COUNCIL (PARISH OF WOOTTON, BEDFORD)
(PROHIBITION AND RESTRICTION OF WAITING, LOADING AND STOPPING)
ORDER 2016**

**Bedford Borough Council
Borough Hall
Cauldwell Street
Bedford MK42 9AP**

Reproduced from the Ordnance Survey map with the permission of Her Majesty's Stationary Office © Crown Copyright Licence No. LA077127 (2021). Unauthorised reproduction infringes Crown Copyright and may lead to prosecution or civil proceedings.

Scale - 1:1,250 @ A3



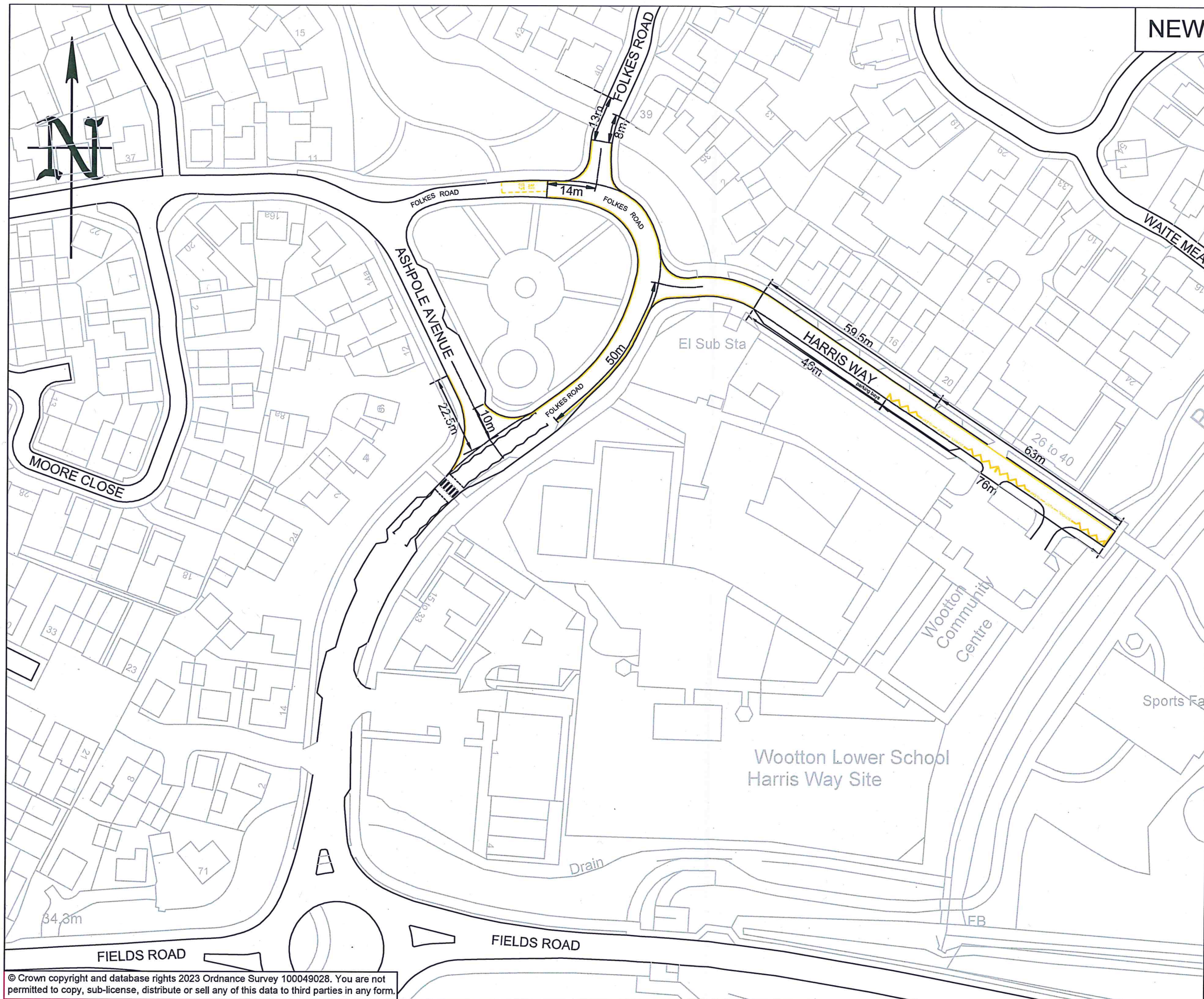

NEW

PRINTS FROM THIS DRAWING ARE UNCONTROLLED UNLESS OTHERWISE STATED **A3**

- KEY:**
- New School Keep Clear markings
 - New 75mm wide single yellow line
 - New 75mm wide double yellow lines

NOTES

New School Keep Clear markings to Diagram 1027.1, 2 sets, each set approx. 37.56m length as shown. Nominal 100mm gap between each set of zig zag markings and commencement of double yellow lines.

Double yellow lines to Diagram 1018.1, single yellow lines to Diagram 1017, all in accordance with the Traffic Signs Regulations and General Directions 2016.



31/05/2023	TRO	1	GM
28/03/2023	First Issue	0	GM
DATE	AMENDMENTS	REV	BY



Traffic Management
 BOROUGH HALL, CAULDWELL ST, BEDFORD, MK42 9AP
 Tel. (01234) 267422

CLIENT
Environment

SCHEME
Fields Road, Wootton

DRAWING TITLE
New 'School Keep Clear' markings and 'No waiting' restrictions

(Single and Double Yellow Lines)

DRG STATUS
TRO

SCALE @ A3	DATE	DRAWN	CHECKED
NTS	28/03/2023	GM	AP

© Crown copyright and database rights 2023 Ordnance Survey 100049028. You are not permitted to copy, sub-license, distribute or sell any of this data to third parties in any form.