



PUBLIC NOTICE

BEDFORD BOROUGH COUNCIL PROPOSE TO INTRODUCE NEW PARKING RESTRICTIONS IN VARIOUS ROADS AND JUNCTIONS IN THE PUTNOE LANE AREA, BEDFORD

Reason for Proposal:

Bedford Borough Council has received a request from Ward councillors for new parking restrictions at junctions of various roads off Putnoe Lane, Bedford. This is in response to concerns raised over inconsiderate parking at these locations which affects visibility and safety, so these restrictions are intended to remedy that.

Effect of the Order:

1. To introduce “No waiting at any time” restrictions (double yellow lines) on the following lengths of road:

A	Bamburgh Drive, Bedford
(i)	On its north-western kerb, extending from a point approx. 14.5 metres from the centre of Belvoir Walk for a distance of approx. 5 metres in a south-westerly direction.
(ii)	On its south-eastern kerb, extending from a point approx. 13 metres from the centre of Flint Way for a distance of approx. 2 metres in a south-westerly direction.
B	Dover Crescent (eastern arm), Bedford
(i)	On its north-western kerb, from the south-west side of Wentworth Drive extending for a distance of approx. 15 metres in a south-westerly direction.
(ii)	On its south-eastern kerb, from the south-west side of Wentworth Drive to the north-east side of the southern arm of Wentworth Drive.
C	Wentworth Drive, Bedford
(i)	On its south-western kerb, extending from the centre of the eastern arm of Dover Crescent for a distance of approx. 20 metres in both north-westerly and south-easterly directions.
D	Wentworth Drive (south-east arm), Bedford
(i)	On its north-eastern kerb, from the south-east side of the eastern arm of Dover Crescent for a distance of approx. 17 metres in a south-easterly direction.

Relevant proposal documents are currently only available for viewing on the council's website at www.bedford.gov.uk/proposedtro due to COVID-19 restrictions. The documents will be placed on deposit until 6 weeks after the Order is made or until it is decided not to continue with the proposal. For further information, please contact Julie Brockett at Bedford Borough Council on 01234 276691.

Comments supporting or objecting to the proposal should be put in an email, stating the grounds on which they are made, and sent no later than 13th April 2023 to highway.consultations@bedford.gov.uk.

Order Title if made will be:

1. Bedford Borough Council (Bedford Urban Area (North of the River Excluding Queens Park and CPZ Areas)) (Prohibition and Restriction of Waiting and Loading and Parking Places) Order 2009 (Amendment No.95) Order 2023.

Dated: 16th March 2023

Borough Hall, Cauldwell Street
Bedford, MK42 9AP

Craig Austin
Director of Environment



BEDFORD BOROUGH COUNCIL
(BEDFORD URBAN AREA (NORTH OF THE RIVER EXCLUDING QUEENS PARK
AND CPZ AREAS)) (PROHIBITION AND RESTRICTION OF WAITING AND
LOADING AND PARKING PLACES) ORDER 2009
(AMENDMENT NO.95) ORDER 2023

BEDFORD BOROUGH COUNCIL (“the Council”) in exercise of the powers conferred by Sections 1(1), 2(1) to (3) and 4(2) of, and Part IV of Schedule 9 to, the Road Traffic Regulation Act 1984 (“the Act”) and of all other powers enabling them in that behalf, and after consultation with the Chief Officer of Police in accordance with Part III of Schedule 9 to the Act, hereby make the following Order:-

1. This Order may be cited as the “Bedford Borough Council (Bedford Urban Area (North of the River Excluding Queens Park and CPZ Areas)) (Prohibition and Restriction of Waiting and Loading and Parking Places) Order 2009 (Amendment No.95) Order 2023” and shall come into force on 9th May 2023.
2. As from the date upon which this Order comes into force the provisions of the Bedford Borough Council (Bedford Urban Area (North of the River Excluding Queens Park and CPZ Areas)) (Prohibition and Restriction of Waiting and Loading and Parking Places) Order 2009 as amended shall be varied as follows:
 - (i) The plan schedule reference “Grid Ref: O 19 Revision No: 2” shall be deleted and the plan schedule reference “Grid Ref: O 19 Revision No: 3” shall be inserted.
 - (ii) The plan schedule reference “Grid Ref: P 18 Revision No: 2” shall apply.
3. This Amendment shall be read and construed as one with the Bedford Borough Council (Bedford Urban Area (North of the River Excluding Queens Park and CPZ Areas)) (Prohibition and Restriction of Waiting and Loading and Parking Places) Order 2009 as amended.

**THE COMMON SEAL of the
BEDFORD BOROUGH COUNCIL**
was hereunto affixed this
4th day of May 2023
in the presence of:



**Wai K. Tsang
Solicitor
Legal Services
Bedford Borough Council**

Authorised Signatory

A handwritten signature in black ink that reads "Wai K. Tsang" followed by a stylized flourish.

AUTHORITY FOR EXECUTION		
COUNCIL/COMMITTEE	MINUTE No.	DATE
DELEGATED POWER	By whom executed ENVIRONMENT	04/05/2023
	OFFICERS INITIALS	DATE
ORIGINATED AND CHECKED BY	GM	04/05/2023
APPROVED BY	AP	04/05/2023



BEDFORD BOROUGH COUNCIL
(BEDFORD URBAN AREA (NORTH OF THE RIVER EXCLUDING QUEENS PARK
AND CPZ AREAS)) (PROHIBITION AND RESTRICTION OF WAITING AND
LOADING AND PARKING PLACES) ORDER 2009
(AMENDMENT NO.95) ORDER 2023

STATEMENT OF REASONS

Bedford Borough Council has received a request from Ward councillors for new parking restrictions at junctions of various roads off Putnoe Lane, Bedford. This is in response to concerns raised over inconsiderate parking at these locations which affects visibility and safety, so these restrictions are intended to remedy that.

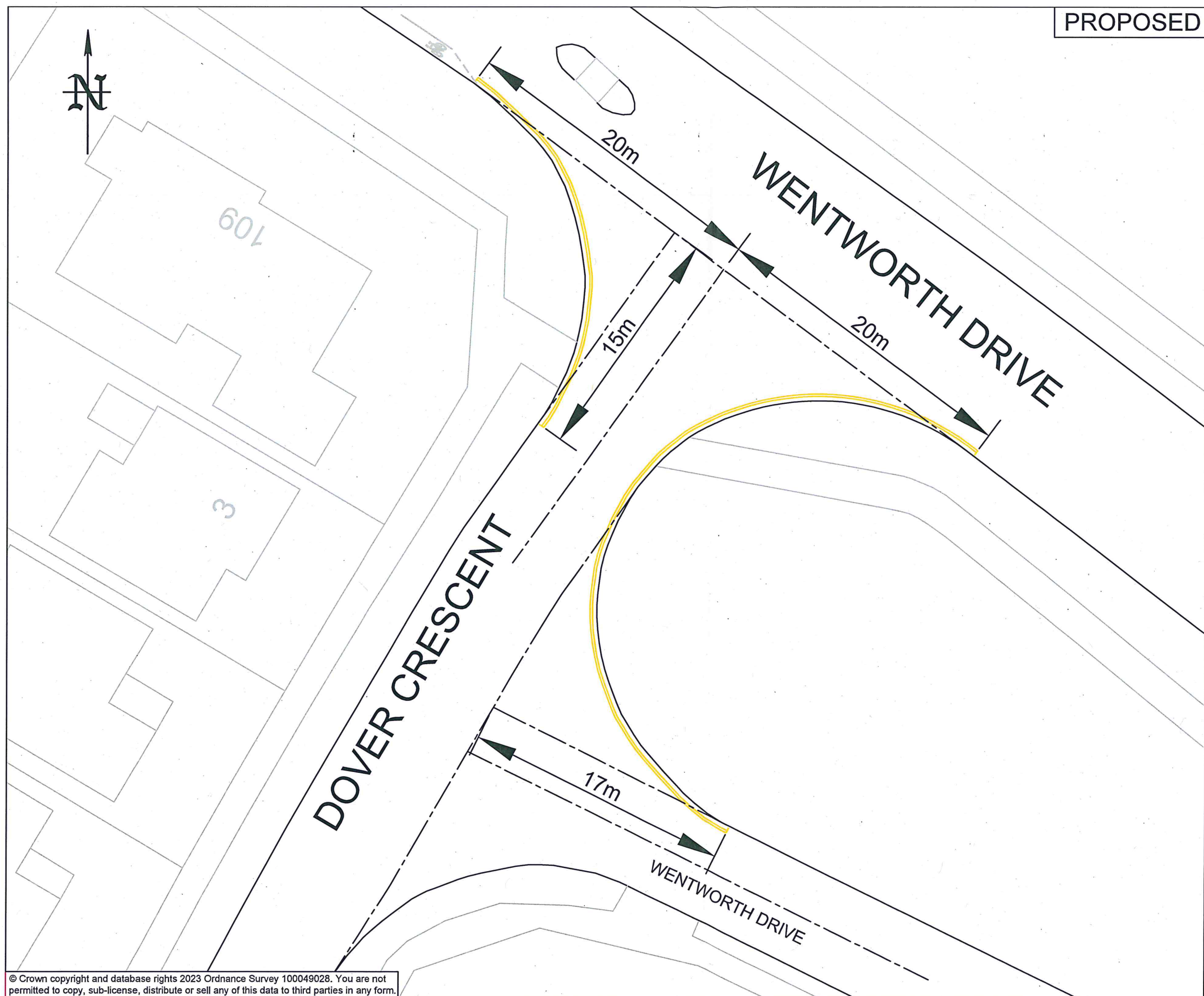

KEY:

- Existing road markings
- New 75mm wide double yellow lines

NOTES

New 75mm wide double yellow lines to Diagram 1018.1 of the Traffic Signs Regulations and General Directions 2016.



wvt

07/02/2023	Consultation	1	GM
26/07/2022	First Issue	0	GM
DATE	AMENDMENTS	REV	BY



BEDFORD
BOROUGH COUNCIL

Traffic Management

BOROUGH HALL, CAULDWELL ST, BEDFORD, MK42 9AP
Tel. (01234) 267422

CLIENT

Environment

SCHEME

Wentworth Drive /
Dover Crescent, Bedford

DRAWING TITLE

Proposed 'No waiting at any time'
(Double Yellow Lines)

DRG STATUS

Consultation



SCALE @ A3	DATE	DRAWN	CHECKED
NTS	26/07/2022	GM	AP



BELVOIR WALK

BAMBURGH DRIVE

FLINT WAY

- KEY:**
-  Existing double yellow lines
 -  New 75mm wide double yellow lines to Diagram 1018.1 of the Traffic Signs Regulations and General Directions 2016



W167.

08/03/2023	Consultation	1	GM
19/08/2022	First Issue	0	GM
DATE	AMENDMENTS	REV	BY



Traffic Management
 BOROUGH HALL, CAULDWELL ST, BEDFORD, MK42 9AP
 Tel. (01234) 267422

CLIENT
 Environment

SCHEME
 Bamburgh Drive, Bedford

DRAWING TITLE
 Proposed 'No waiting at any time'
 (Double Yellow Lines)

DRG STATUS
 Consultation

SCALE @ A3	DATE	DRAWN	CHECKED
NTS	19/08/2022	GM	AP

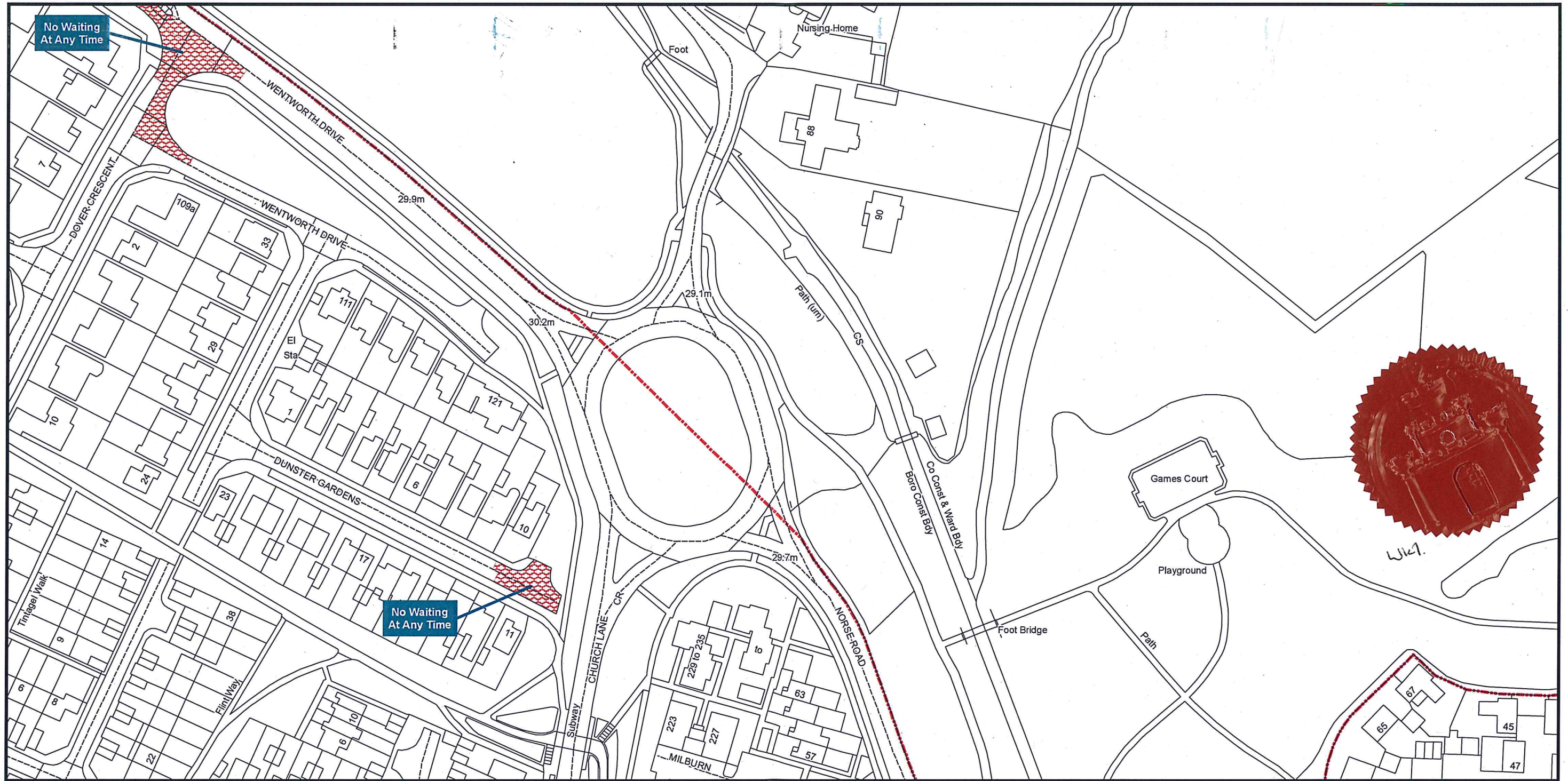

Bedford Borough Council (Bedford Urban Area (North of the River excluding Queens Park and CPZ areas)) (Prohibition and Restriction of Waiting and Loading and Parking Places) Order 2009



Bedford Borough Council
Borough Hall
Cauldwell Street
Bedford MK42 9AP

Reproduced from the Ordnance Survey map with the permission of Her Majesty's Stationary Office © Crown Copyright Licence No. LA077127 (2023). Unauthorised reproduction infringes Crown Copyright and may lead to prosecution or civil proceedings.

Scale - 1:1,250



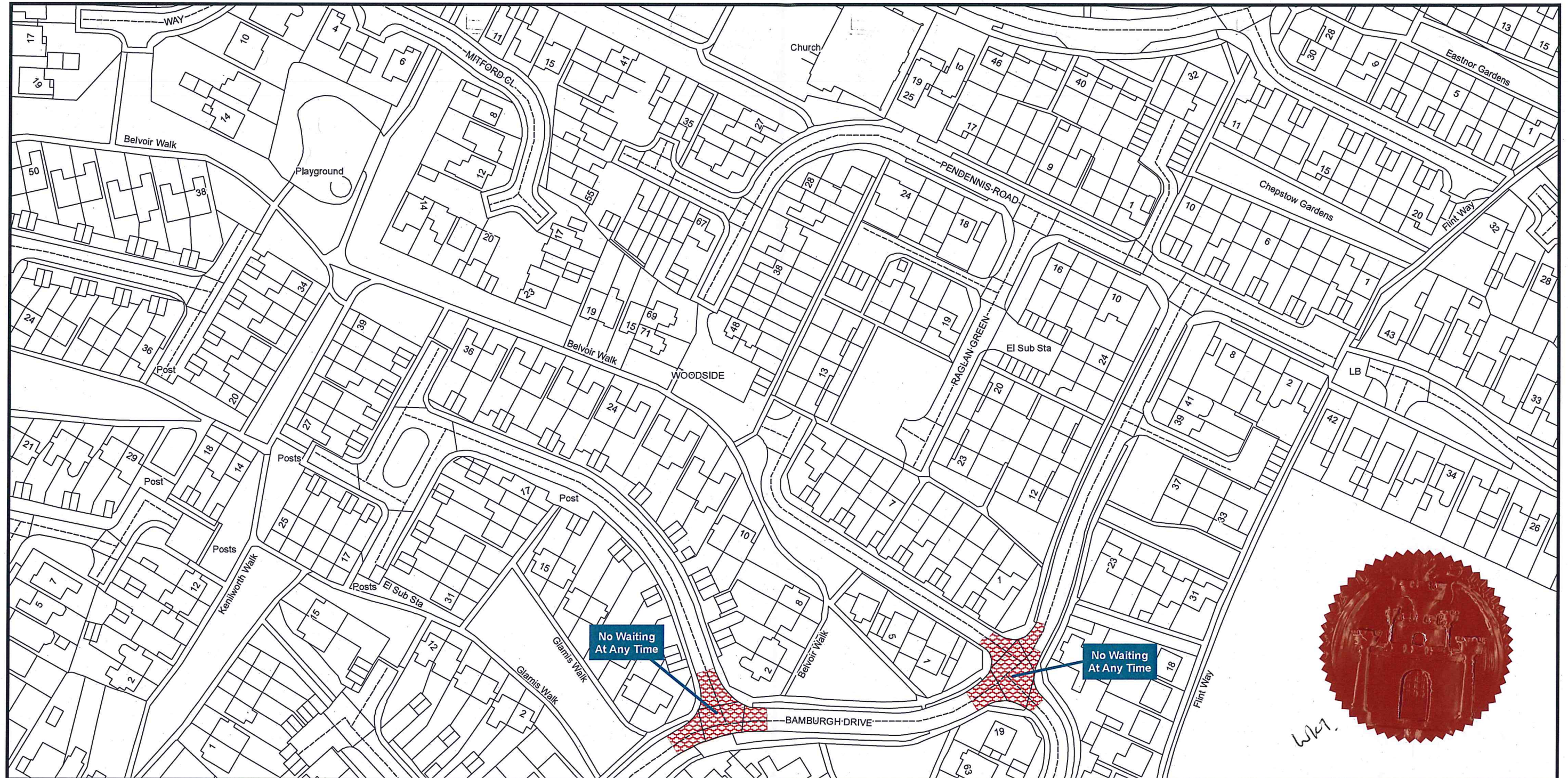

Bedford Borough Council (Bedford Urban Area (North of the River excluding Queens Park and CPZ areas)) (Prohibition and Restriction of Waiting and Loading and Parking Places) Order 2009



Bedford Borough Council
Borough Hall
Cauldwell Street
Bedford MK42 9AP

