



BEDFORD
BOROUGH COUNCIL

BEDFORD BOROUGH COUNCIL

**(GREAT DENHAM CONTROLLED PARKING ZONE AND PROHIBITION AND
RESTRICTION OF WAITING, LOADING AND STOPPING) ORDER 2017
(AMENDMENT NO.5) ORDER 2023**

STATEMENT OF REASONS

Bedford Borough Council has received a request from Great Denham Parish Council for some parking restrictions in Great Portway and Woodville Drive, Gt Denham, following concerns raised about inconsiderate parking at these locations.

These restrictions will help keep these areas clear of parked vehicles, thus improving visibility for vehicles and helping to provide a safer road network for all highway users, including cyclists and pedestrians.



BEDFORD
BOROUGH COUNCIL

BEDFORD BOROUGH COUNCIL
(GREAT DENHAM CONTROLLED PARKING ZONE AND PROHIBITION AND
RESTRICTION OF WAITING, LOADING AND STOPPING) ORDER 2017
(AMENDMENT NO.5) ORDER 2023

BEDFORD BOROUGH COUNCIL (“the Council”) in exercise of the powers conferred by Sections 1(1), 2(1) to (3) and 4(2) of, and Part IV of Schedule 9 to, the Road Traffic Regulation Act 1984 (“the Act”) and of all other powers enabling them in that behalf, and after consultation with the Chief Officer of Police in accordance with Part III of Schedule 9 to the Act, hereby make the following Order:-

1. This Order may be cited as the “Bedford Borough Council (Great Denham Controlled Parking Zone and Prohibition and Restriction of Waiting, Loading and Stopping) Order 2017 (Amendment No.5) Order 2023” and shall come into force on 6th March 2023.
2. As from the date upon which this Order comes into force the provisions of the Bedford Borough Council (Great Denham Controlled Parking Zone and Prohibition and Restriction of Waiting, Loading and Stopping) Order 2017 as amended shall be varied as follows:
 - (i) The plan schedule reference “Grid Ref: D 31 Revision No: 1” shall be deleted and the plan schedule reference “Grid Ref: D 31 Revision No: 2” shall be inserted.
 - (ii) The plan schedule reference “Grid Ref: D 32 Revision No: 2” shall be deleted and the plan schedule reference “Grid Ref: D 32 Revision No: 3” shall be inserted.
3. This Amendment shall be read and construed as one with the Bedford Borough Council (Great Denham Controlled Parking Zone and Prohibition and Restriction of Waiting, Loading and Stopping) Order 2017 as amended.

**THE COMMON SEAL of the
BEDFORD BOROUGH COUNCIL**

was hereunto affixed this

2nd day of March 2023

in the presence of:



A handwritten signature in black ink, appearing to read 'David Doorne'.

Authorised Signatory

David Doorne
Solicitor
Service Manager (GPPL)
Legal Services
Bedford Borough Council

AUTHORITY FOR EXECUTION		
COUNCIL/COMMITTEE	MINUTE No.	DATE
DELEGATED POWER	By whom executed ENVIRONMENT	02/03/2023
	OFFICERS INITIALS	DATE
ORIGINATED AND CHECKED BY	GM	02/03/2023
APPROVED BY	AP	02/03/2023

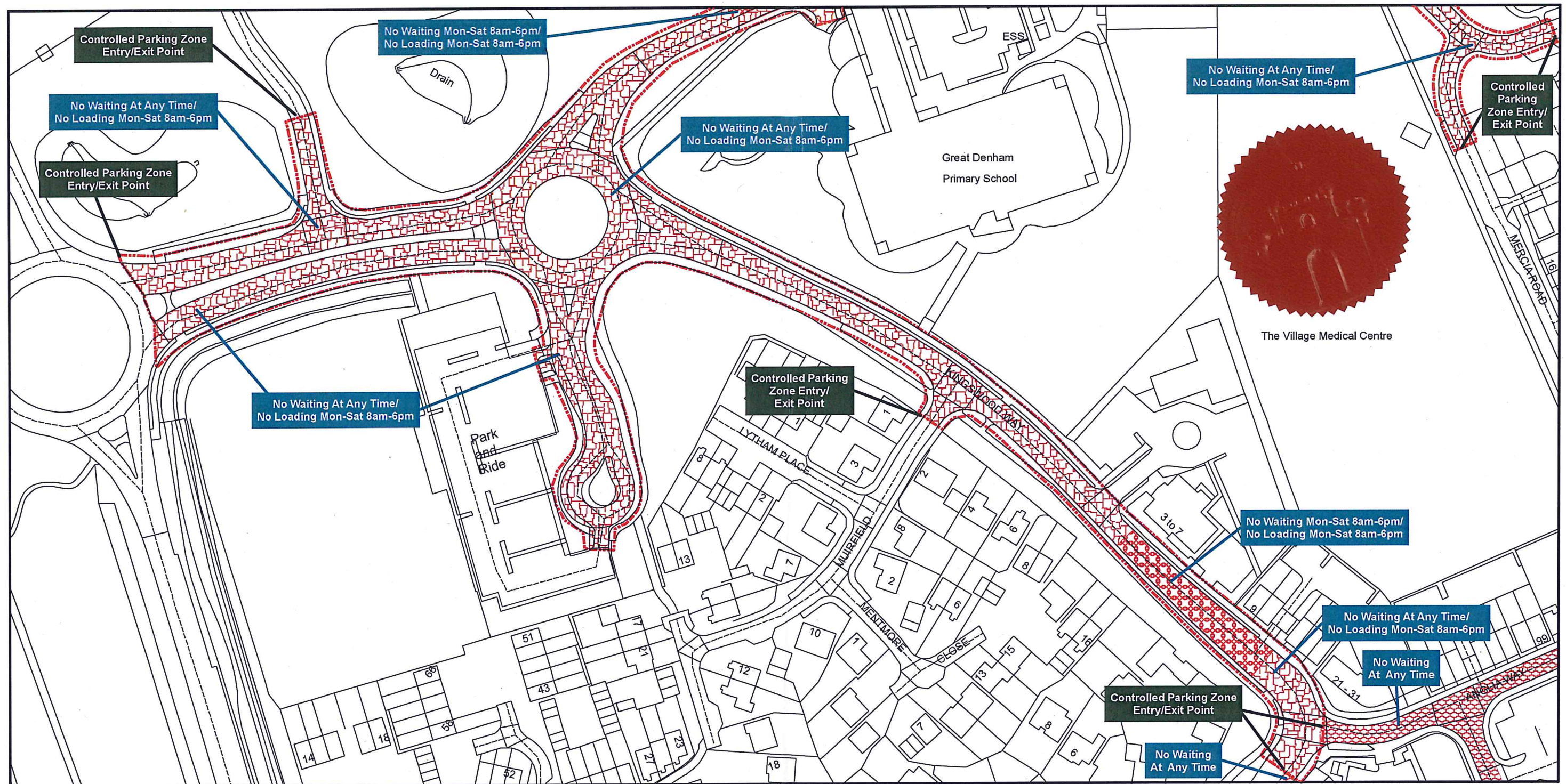

Bedford Borough Council (Great Denham Controlled Parking Zone and Restriction of Waiting, Loading and Stopping) Order 2017

Bedford Borough Council
Borough Hall
Cauldwell Street
Bedford MK42 9AP





Reproduced from the Ordnance Survey map with the permission of Her Majesty's Stationary Office © Crown Copyright Licence No. LA077127 (2016). Unauthorised reproduction infringes Crown Copyright and may lead to prosecution or civil proceedings.

Scale - 1:1,250



KEY:

-  Existing double yellow lines
-  New 75mm wide double yellow lines

NOTES

Extend existing double yellow lines in Great Portway at the Saxon Way junction by 21m, as shown.
 New double yellow lines to Diagram 1018.1 of the Traffic Signs Regulations and General Directions 2016.



RED

01/03/2023	TRO	1	GM
30/08/2022	First Issue	0	GM
DATE	AMENDMENTS	REV	BY



Traffic Management
 BOROUGH HALL, CAULDWELL ST, BEDFORD, MK42 9AP
 Tel. (01234) 267422

CLIENT
Environment

SCHEME
Great Portway, Great Denham

DRAWING TITLE
Proposed 'No waiting at any time' restriction (Double Yellow Lines)

DRG STATUS		TRO	
SCALE @ A3	DATE	DRAWN	CHECKED
NTS	30/08/2022	GM	AP

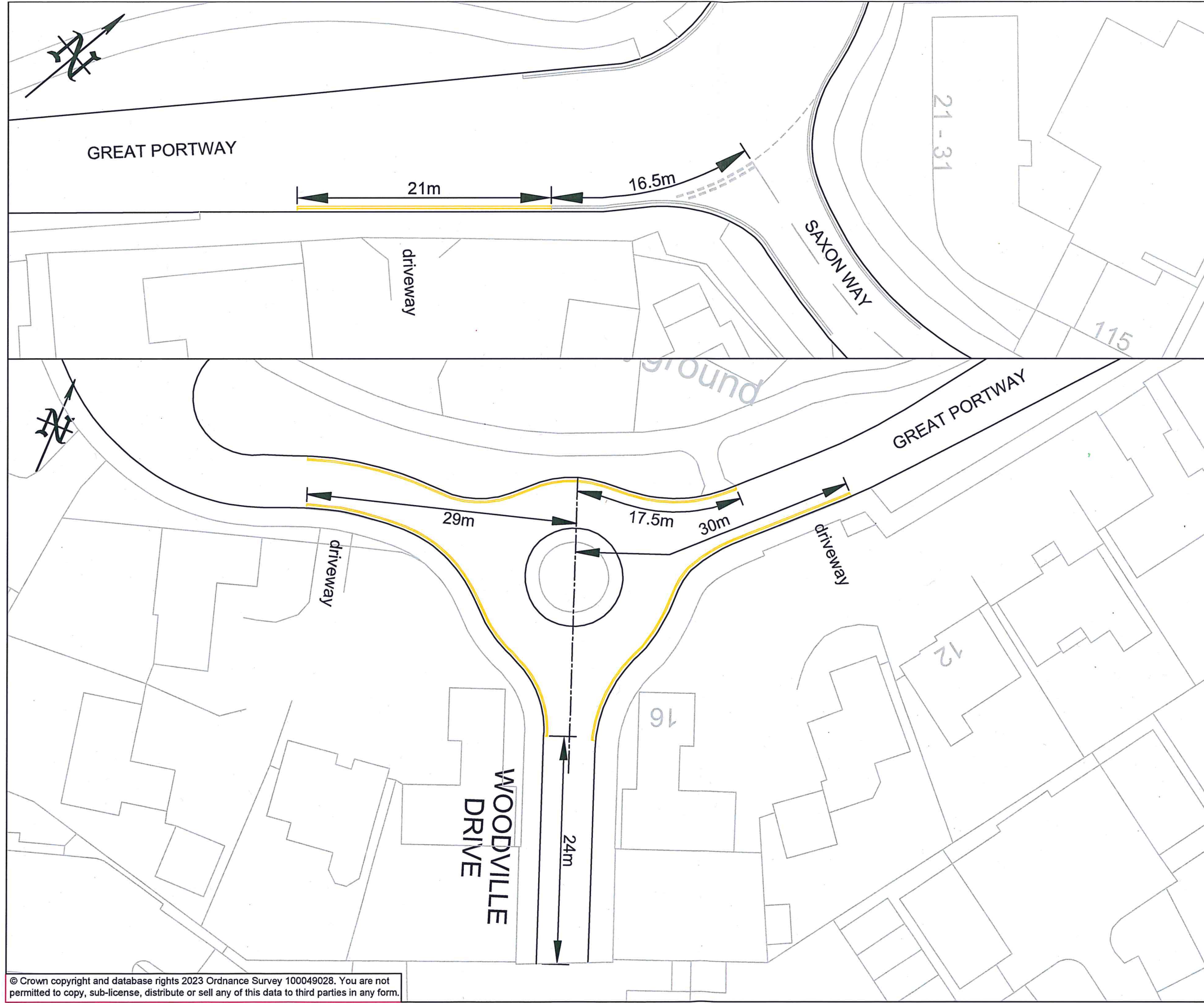

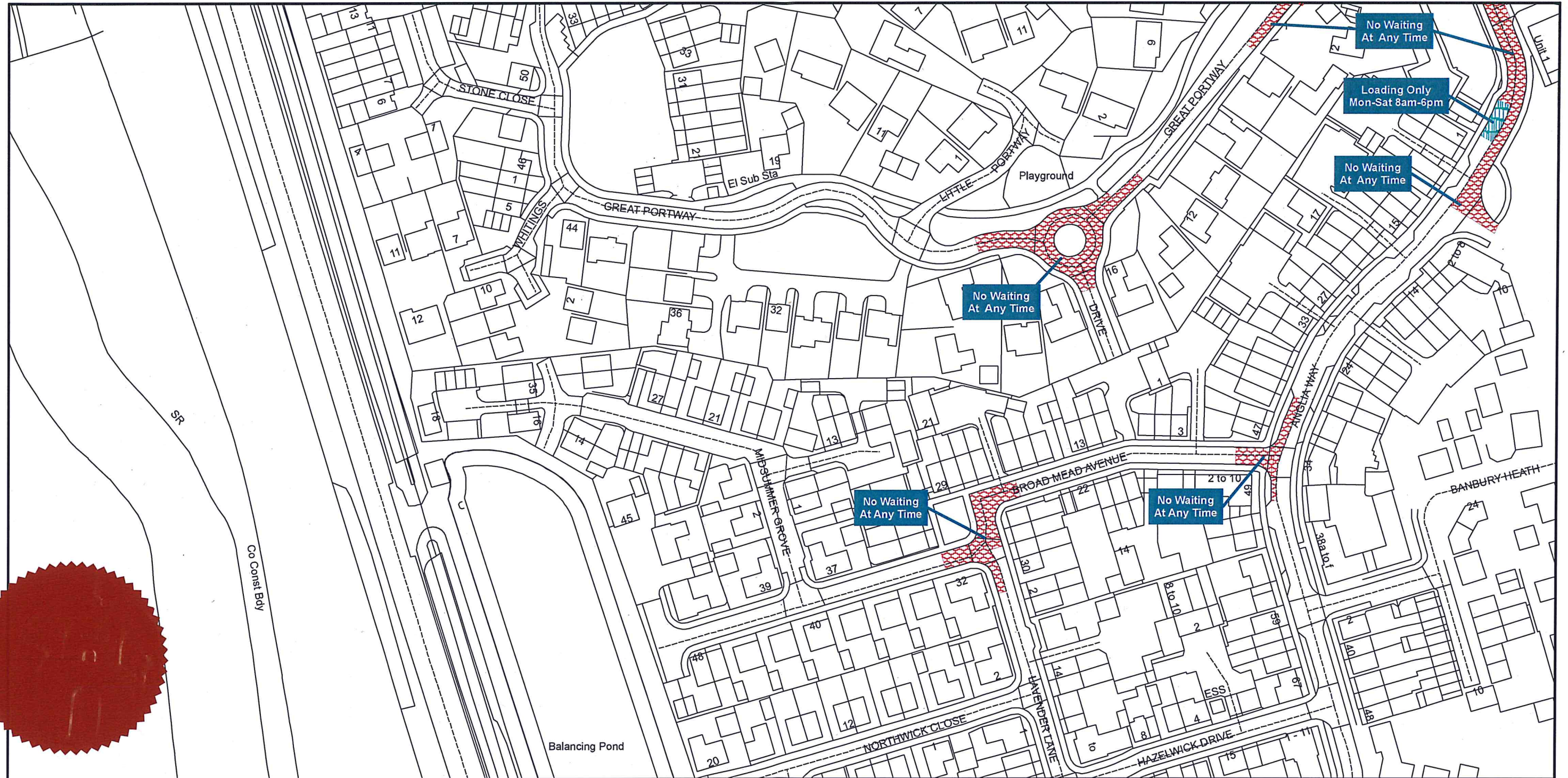

**Bedford Borough Council (Great Denham Controlled
Parking Zone and Restriction of Waiting, Loading
and Stopping) Order 2017**

Bedford Borough Council
Borough Hall
Cauldwell Street
Bedford MK42 9AP

