



BEDFORD BOROUGH COUNCIL
(THE PARISH OF RISELEY) (PROHIBITION OF WAITING)
ORDER 2023

STATEMENT OF REASONS

Bedford Borough Council proposes to rectify existing incorrect School Keep Clear markings and introduce parking restrictions in the vicinity of Riseley Primary School in High Street, Riseley. The corrections and further restrictions are deemed necessary to maintain safety for both those attending the school and other highway users in the area.



BEDFORD BOROUGH COUNCIL
(THE PARISH OF RISELEY) (PROHIBITION OF WAITING)
ORDER 2023

BEDFORD BOROUGH COUNCIL ("the Council") in exercise of the powers conferred by Sections 1(1), 2(1) to (3) and 4(2) of, and Part IV of Schedule 9 to, the Road Traffic Regulation Act 1984 as amended ("the Act") and of all other powers enabling them in that behalf, and after consultation with the Chief Officer of Police in accordance with Part III of Schedule 9 to the Act, hereby make the following Order:-

1. This Order may be cited as the "Bedford Borough Council (The Parish of Thurleigh) (Prohibition of Waiting) Order 2023 and shall come into force on 27th February 2023.
2. Except where otherwise stated and referenced in this Order a number or Schedule is a reference to the Article or Schedule bearing that number in this Order.
3. Save as provided in Articles 4, 5 and 6 of this Order no person shall, except upon the direction or with the permission of a Police Constable in uniform or a Civil Enforcement Officer as defined by the Traffic Management Act 2004, cause or permit any vehicle to wait in any length of road specified in the Schedule to this Order at any time.
4. (i) Nothing in Article 3 shall render it unlawful to cause or permit any vehicle to wait in any length of road specified in the Schedule to this Order for so long as may be necessary to enable:-
 - (a) a person to board or alight from the vehicle; or
 - (b) the vehicle if it cannot conveniently be used for such purpose in any other road to be used in connection with any building operation or demolition, the removal of any obstruction to traffic, the maintenance improvement or reconstruction of any of the lengths of road so referred to or in the laying, erection, alteration or repair in or near the said lengths of road of any sewer or main pipe or apparatus for the supply of gas, water or electricity or of any telegraphic line as described in the Telegraph Act 1878; or
 - (c) the vehicle to be loaded or unloaded while it is in actual use in connection with the removal of furniture from one office or dwelling house to another or the removal of furniture between such premises and its depository; or
 - (d) the vehicle if it is in the service of or employed by a universal service provider (as defined in Section 65 of the Postal Services Act 2011) to be used for the purpose of delivering and/or collecting postal packets (as defined in Section 125(1) of the Postal Services Act 2011); or
 - (e) the vehicle to be used for fire brigade, ambulance, police or special forces purposes; or

- (f) the vehicle if it cannot conveniently be used for such purposes in any other road to be used of a Local Authority in pursuance of Statutory Powers or duties; or
 - (g) the vehicle to wait at or near to any premises situated on or adjacent to the said lengths of road for so long as such waiting by that vehicle is reasonably necessary in connection with any wedding or funeral; or
 - (h) the person in control of the vehicle if required by law to stop, or if obliged to do so in order to avoid an accident, or if prevented from proceeding by circumstances beyond their control.
- (ii) Nothing in Article 3 shall render it unlawful to cause or permit any vehicle to wait in any length of road specified in the Schedule to this Order for so long as may be necessary to enable goods to be loaded or unloaded from the vehicle.
5. Nothing in Article 3 shall render it unlawful to cause or permit a vehicle which lawfully displays in the relevant position a disabled persons badge and parking disc (on which the driver of the vehicle has marked the time at which the waiting began) to wait in any length of road specified in the Schedule to this Order.
6. (i) For the purposes of Article 5 "disabled persons badge" and "parking disc" have the same meanings as in "The Local Authorities' Traffic Orders (Exemptions for Disabled Persons) (England) Regulations 2000".
- (ii) For the purpose of this Order a vehicle shall be regarded as displaying:-
- (a) a disabled persons badge in the relevant position when:
 - (i) in the case of a vehicle fitted with a front windscreen the badge is exhibited thereon with the obverse side facing forwards on the nearside of and immediately behind the windscreen and with its front facing forward so as to be legible from outside the vehicle; or
 - (ii) in the case of a vehicle not fitted with a front windscreen the badge is exhibited in a conspicuous position on the front nearside of the vehicle.
 - (b) a parking disc in the relevant position when the disc is exhibited thereon with the side which shows the time facing forwards or outwards and immediately behind the windscreen or side window nearest to the kerb.
7. As from the date upon which this Order comes into force any previous Order made under the Act which relates to waiting in any length of road specified in the Schedule to this Order shall be revoked in whole or in part as appropriate.

**THE COMMON SEAL of the
BEDFORD BOROUGH COUNCIL**

was hereunto affixed this
23rd day of February 2023
in the presence of:



A handwritten signature in black ink, appearing to read 'David Doorne'.

David Doorne
Solicitor
Service Manager (GPPL)
Legal Services
Bedford Borough Council

SCHEDULE

1. Lengths of road upon which 'No waiting at any time' restrictions (double yellow lines) shall apply:

A	High Street, Riseley
(i)	On its north western and western kerb, extending from a point approx. 3 metres south west of the projected north eastern boundary of White Gates for a distance of approx. 179 metres in a north easterly and then northern direction.
(ii)	On its south eastern and eastern kerb, extending from a point approx. 3 metres south west of the projected north eastern boundary of White Gates for a distance of approx. 32.5 metres in a north easterly direction.
(iii)	On its eastern kerb, from a point approx. 116.5 metres north of the projected north eastern boundary of White Gates for a distance of approx. 61 metres in a northerly direction.

2. To introduce "No stopping on entrance markings" restrictions on the following length of road:

A	High Street, Riseley
(i)	On its eastern kerb, in 2 identical sections, extending from a point approx. 29.5 metres north east of the projected north eastern boundary of White Gates for a combined distance of approx. 87 metres in a north easterly and then northern direction.

Handwritten notes in the top left corner, including the number '13' and some illegible scribbles.

Faint, illegible text or a stamp located in the upper middle section of the page.

AUTHORITY FOR EXECUTION		
COUNCIL/COMMITTEE	MINUTE No.	DATE
DELEGATED POWER	By whom executed ENVIRONMENT	23/02/2023
	OFFICERS INITIALS	DATE
ORIGINATED AND CHECKED BY	GM	23/02/2023
APPROVED BY	AP	23/02/2023

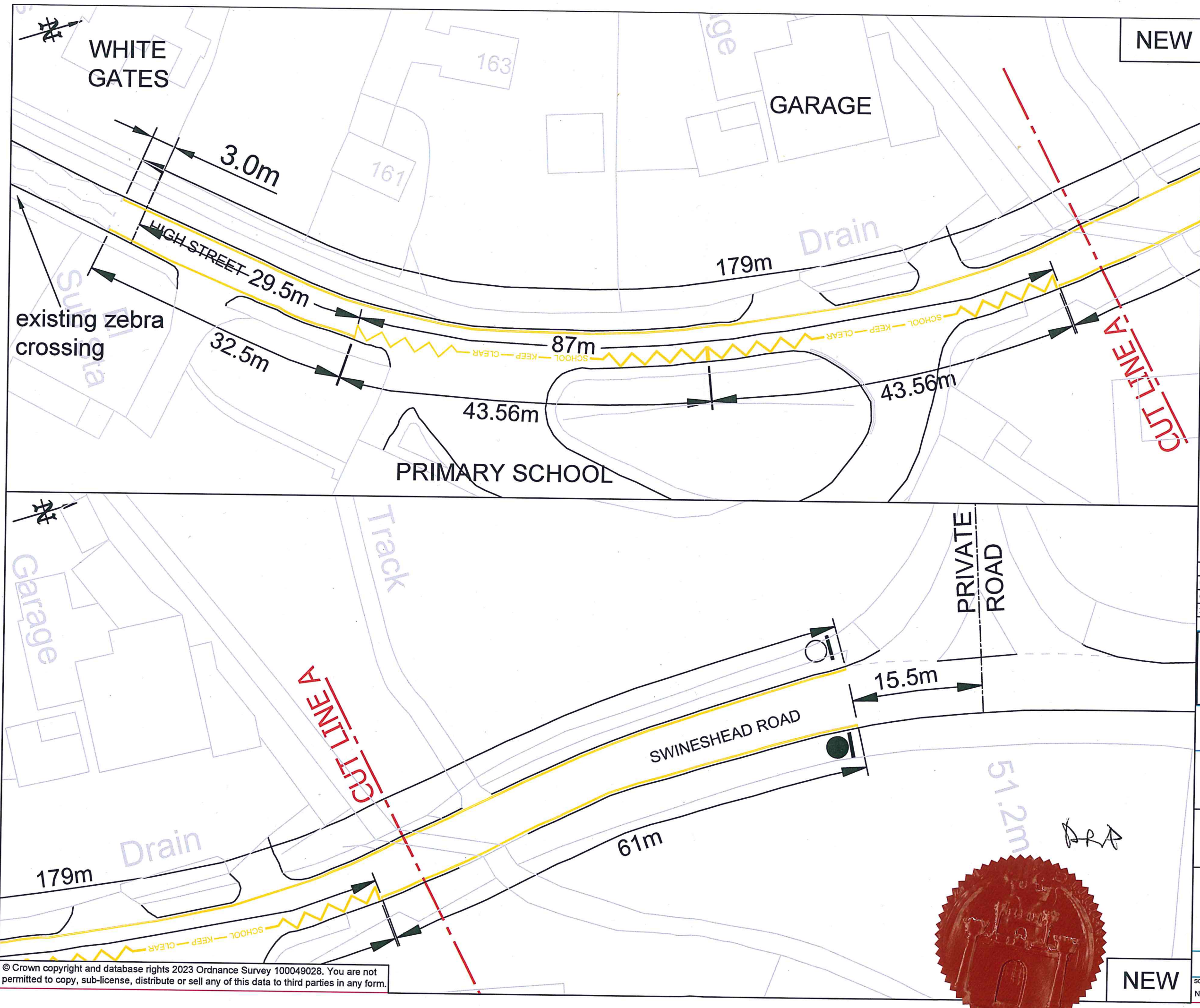

NEW

PRINTS FROM THIS DRAWING ARE UNCONTROLLED UNLESS OTHERWISE STATED **A3**

- KEY:**
- New School Keep Clear markings
 - New 75mm wide double yellow lines
 - Existing double yellow lines

NOTES

Erase existing School Keep Clear markings and replace with new markings as shown. New markings to commence 100mm from end of existing zebra crossing markings. Nominal 100mm gap between each set of zig zag markings and commencement of double yellow lines. School Keep Clear zig zag markings to Diagram 1027.1, double yellow lines to Diagram 1018.1 of the Traffic Signs Regulations and General Directions 2016.

DATE	AMENDMENTS	REV	BY
09/02/2023	TRO	3	GM
06/12/2022	Third Issue	2	GM
01/12/2022	Second Issue	1	GM
28/07/2022	First Issue	0	GM



Traffic Management
 BOROUGH HALL, CAULDWELL ST, BEDFORD, MK42 9AP
 Tel. (01234) 267422

CLIENT
Environment

SCHEME
Riseley Primary School

DRAWING TITLE
New 'School Keep Clear' markings and 'No waiting at any time' restriction (Double Yellow Lines)

DRG STATUS
TRO

SCALE @ A3	DATE	DRAWN	CHECKED
NTS	28/07/2022	GM	AP

© Crown copyright and database rights 2023 Ordnance Survey 100049028. You are not permitted to copy, sub-license, distribute or sell any of this data to third parties in any form.

NEW