



BEDFORD BOROUGH COUNCIL
(BEDFORD URBAN AREA (NORTH OF THE RIVER EXCLUDING QUEENS PARK
AND CPZ AREAS)) (PROHIBITION AND RESTRICTION OF WAITING AND
LOADING AND PARKING PLACES) ORDER 2009
(AMENDMENT NO.94) ORDER 2023

STATEMENT OF REASONS

Bedford Borough Council has received a request from Ward councillors for new parking restrictions at junctions of various roads off Putnoe Lane, Bedford. This is in response to concerns raised over inconsiderate parking at these locations which affects visibility and safety, so these restrictions are intended to remedy that.



PUBLIC NOTICE

BEDFORD BOROUGH COUNCIL PROPOSE TO INTRODUCE NEW PARKING RESTRICTIONS IN VARIOUS ROADS AND JUNCTIONS IN THE PUTNOE LANE AREA, BEDFORD

Reason for Proposal:

Bedford Borough Council has received a request from Ward councillors for new parking restrictions at junctions of various roads off Putnoe Lane, Bedford. This is in response to concerns raised over inconsiderate parking at these locations which affects visibility and safety, so these restrictions are intended to remedy that.

Effect of the Order:

1. To introduce “No waiting at any time” restrictions (double yellow lines) on the following lengths of road:

A	Bamburgh Drive, Bedford
(i)	On its north-western kerb, extending from the centre of Belvoir Walk for a distance of approx. 13 metres in a north-easterly direction and approx. 14 metres in a south-westerly direction.
(ii)	On its south-eastern kerb, extending from the centre of Flint Way for a distance of approx. 13 metres in both a north-easterly and south-westerly direction.
B	Belvoir Walk, Bedford
(i)	On both sides of the road, from the north-west side of Bamburgh Drive extending for a distance of approx. 10 metres in a north-westerly direction.
C	Flint Way, Bedford
(i)	On both sides of the road, from the south-east side of Bamburgh Drive extending for a distance of approx. 10 metres in a south-easterly direction.
C	Birkdale Road, Bedford
(i)	On its northern kerb, extending from a point approx. 9 metres south of the northern end of its eastern arm for a distance of approx. 26 metres in a westerly direction.
D	Brecon Way, Bedford
(i)	On its north-eastern kerb, extending from the centre of Tweedsmuir Road for a distance of approx. 20 metres in a north-westerly direction and approx. 12.8 metres in a south-easterly direction.
E	Tweedsmuir Road, Bedford
(i)	On both sides of the road, from the north-east side of Brecon Way extending for a distance of approx. 10 metres in a north-easterly direction.
F	Lowther Road, Bedford
(i)	On both sides of the road, from the north side of Rowallan Drive extending for a distance of approx. 10 metres in a northerly direction.
G	Harrington Drive, Bedford
(i)	On both sides of the road, from the south side of Rowallan Drive extending for a distance of approx. 10 metres in a southerly direction.
H	Rowallan Drive, Bedford
(i)	On its northern kerb, extending from the centre of Lowther Road for a

	distance of approx. 13 metres in a westerly direction and approx. 21 metres in an easterly direction.
(ii)	On its southern kerb, extending from the centre of Harrington Drive for a distance of approx. 22 metres in a westerly direction, and approx. 14 metres in an easterly direction.
J	Queen's Crescent, Bedford
(i)	On both sides of the road, from the south-western side of Queen's Drive extending for a distance of approx. 14 metres in a south-westerly direction.
K	Queen's Drive, Bedford
(i)	On its south-western kerb, extending from the centre of Queen's Crescent for a distance of approx. 15 metres in both a north-westerly and south-easterly direction.
L	Greenacres, Bedford
(i)	On its south-western kerb, extending from the centre of Hartshill for a distance of approx. 13 metres in both a north-westerly and south-easterly direction.
(ii)	On both sides of the south-western arm of the oval, from the south-eastern side of Hartshill extending for a distance of approx. 10 metres in a south-easterly direction.
(iii)	On both sides of the road, from a point approx. 16 metres south-east of the south-east side of Putnoe Lane extending for a distance of approx. 10 metres in a south-easterly direction.
M	Hartshill, Bedford
(i)	On its north-western kerb, extending from the south-western side of the north-eastern arm of the Greenacres oval for a distance of approx. 10 metres in a south-westerly direction.
(ii)	On its south-eastern kerb, extending from the south-western side of the north-eastern arm of the Greenacres oval for a distance of approx. 32 metres in a south-westerly direction.
N	Devizes Avenue, Bedford
(i)	On its north-western kerb, extending from the north-eastern side of Dover Crescent for a distance of approx. 11 metres in a north-easterly direction.
(ii)	On its south-eastern kerb, extending from the north-eastern side of Dover Crescent for a distance of approx. 39 metres in a north-easterly and then northerly direction.
O	Dover Crescent, Bedford
(i)	On its north-eastern kerb, extending from the centre of Devizes Avenue for a distance of approx. 13 metres in both a north-westerly and south-easterly direction.

Relevant proposal documents are currently only available for viewing on the council's website at www.bedford.gov.uk/proposedtro due to COVID-19 restrictions. The documents will be placed on deposit until 6 weeks after the Order is made or until it is decided not to continue with the proposal. For further information, please contact Julie Brockett at Bedford Borough Council on 01234 276691.

Comments supporting or objecting to the proposal should be put in an email, stating the grounds on which they are made, and sent no later than 16th March 2023 to highway.consultations@bedford.gov.uk.

Order Title if made will be:

1. Bedford Borough Council (Bedford Urban Area (North of the River Excluding Queens Park and CPZ Areas)) (Prohibition and Restriction of Waiting and Loading and Parking Places) Order 2009 (Amendment No.94) Order 2023.

Dated: 16th February 2023

Borough Hall, Cauldwell Street
Bedford, MK42 9AP

Craig Austin
Director of Environment



BEDFORD
BOROUGH COUNCIL

BEDFORD BOROUGH COUNCIL
(BEDFORD URBAN AREA (NORTH OF THE RIVER EXCLUDING QUEENS PARK
AND CPZ AREAS)) (PROHIBITION AND RESTRICTION OF WAITING AND
LOADING AND PARKING PLACES) ORDER 2009
(AMENDMENT NO.94) ORDER 2023

BEDFORD BOROUGH COUNCIL (“the Council”) in exercise of the powers conferred by Sections 1(1), 2(1) to (3) and 4(2) of, and Part IV of Schedule 9 to, the Road Traffic Regulation Act 1984 (“the Act”) and of all other powers enabling them in that behalf, and after consultation with the Chief Officer of Police in accordance with Part III of Schedule 9 to the Act, hereby make the following Order:-

1. This Order may be cited as the “Bedford Borough Council (Bedford Urban Area (North of the River Excluding Queens Park and CPZ Areas)) (Prohibition and Restriction of Waiting and Loading and Parking Places) Order 2009 (Amendment No.94) Order 2023” and shall come into force on 11th April 2023.

2. As from the date upon which this Order comes into force the provisions of the Bedford Borough Council (Bedford Urban Area (North of the River Excluding Queens Park and CPZ Areas)) (Prohibition and Restriction of Waiting and Loading and Parking Places) Order 2009 as amended shall be varied as follows:
 - (i) The new plan schedule reference “Grid Ref: M 17 Revision No: 0” shall be inserted.

 - (ii) The new plan schedule reference “Grid Ref: M 18 Revision No: 0” shall be inserted.

 - (iii) The plan schedule reference “Grid Ref: M 20 Revision No: 3” shall be deleted and the plan schedule reference “Grid Ref: M 20 Revision No: 4” shall be inserted.

 - (iv) The plan schedule reference “Grid Ref: N 19 Revision No: 4” shall be deleted and the plan schedule reference “Grid Ref: N 19 Revision No: 5” shall be inserted.

- (v) The plan schedule reference "Grid Ref: N 20 Revision No: 1" shall be deleted and the plan schedule reference "Grid Ref: N 20 Revision No: 2" shall be inserted.
 - (vi) The plan schedule reference "Grid Ref: O 18 Revision No: 4" shall be deleted and the plan schedule reference "Grid Ref: O 18 Revision No: 5" shall be inserted.
 - (vii) The plan schedule reference "Grid Ref: O 19 Revision No: 1" shall be deleted and the plan schedule reference "Grid Ref: O 19 Revision No: 2" shall be inserted.
 - (viii) The plan schedule reference "Grid Ref: P 18 Revision No: 1" shall be deleted and the plan schedule reference "Grid Ref: P 18 Revision No: 2" shall be inserted.
3. This Amendment shall be read and construed as one with the Bedford Borough Council (Bedford Urban Area (North of the River Excluding Queens Park and CPZ Areas)) (Prohibition and Restriction of Waiting and Loading and Parking Places) Order 2009 as amended.

**THE COMMON SEAL of the
BEDFORD BOROUGH COUNCIL**

was hereunto affixed this
6th day of April 2023
in the presence of:



**Wai K. Tsang
Solicitor
Legal Services
Bedford Borough Council**

Authorised Signatory

Wai K. Tsang

AUTHORITY FOR EXECUTION		
COUNCIL/COMMITTEE	MINUTE No.	DATE
DELEGATED POWER	By whom executed ENVIRONMENT	6/04/2023
	OFFICERS INITIALS	DATE
ORIGINATED AND CHECKED BY	GM	6/04/2023
APPROVED BY	AP	6/04/2023

1000

W. J. H. H. W.
 2. H. H. H.
 Legal Services
 Bedford Borough Council

NEW

PRINTS FROM THIS DRAWING ARE UNCONTROLLED UNLESS OTHERWISE STATED

A3

KEY:

New 75mm wide double yellow lines to Diagram 1018.1 of the Traffic Signs Regulations and General Directions 2016

NOTES

Double yellow lines at the start of both Lowther Road and Harrington Drive extend for a distance of 10 metres respectively from the perpendiculars of the junctions.



WKL

06/04/2023	TRO	3	GM
07/02/2023	Consultation	2	GM
11/11/2022	Double yellow lines extended.	1	GM
05/07/2022	First Issue	0	GM
DATE	AMENDMENTS	REV	BY



BEDFORD
BOROUGH COUNCIL

Traffic Management

BOROUGH HALL, CAULDWELL ST, BEDFORD, MK42 9AP
Tel. (01234) 267422

CLIENT

Environment

SCHEME

Rowallan Drive / Lowther Road & Harrington Drive, Bedford

DRAWING TITLE

Proposed 'No waiting at any time' (Double Yellow Lines)

DRG STATUS

TRO

SCALE @ A3	DATE	DRAWN	CHECKED
NTS	05/07/2022	GM	AP

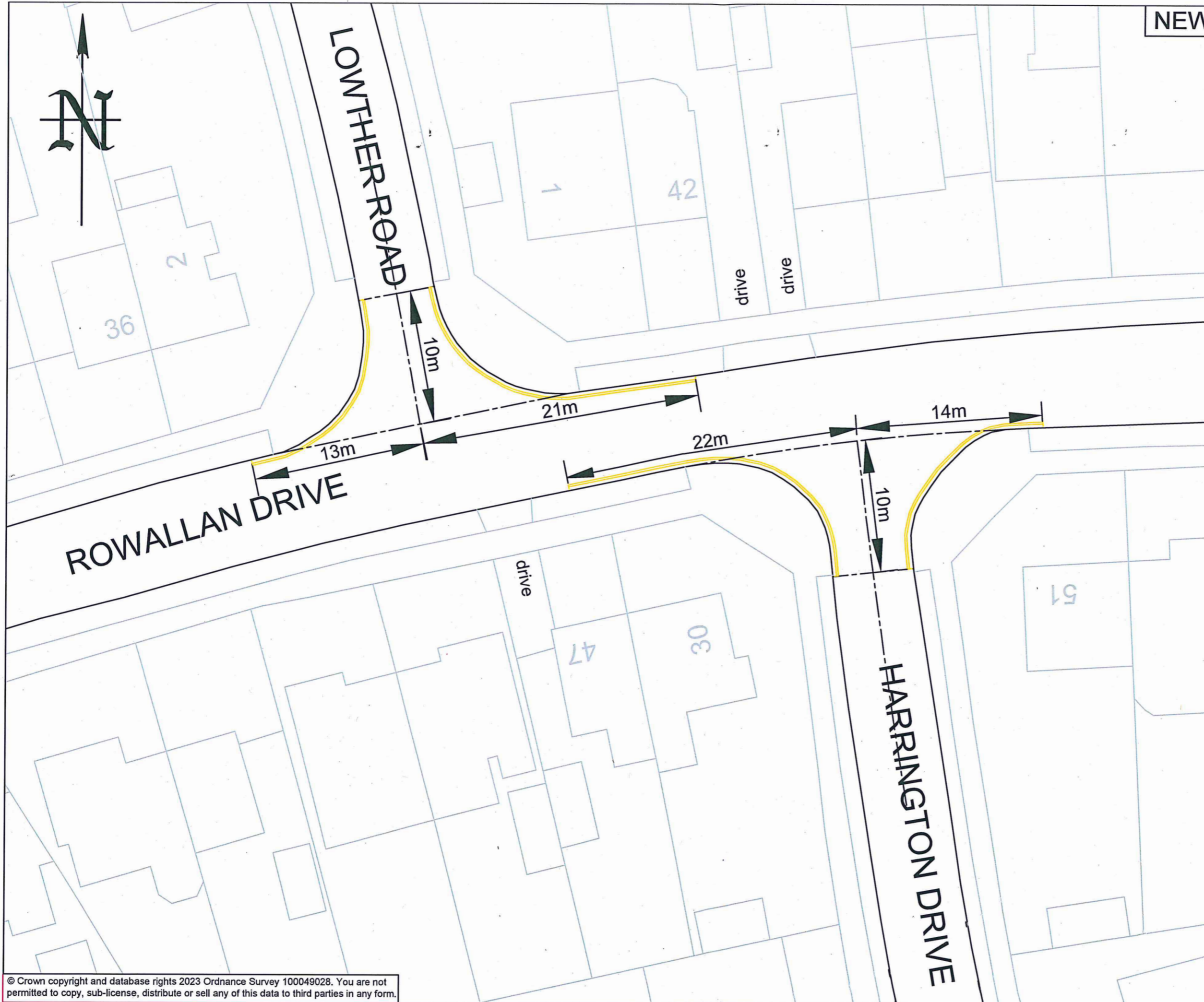

NEW

PRINTS FROM THIS DRAWING ARE UNCONTROLLED UNLESS OTHERWISE STATED

A3



QUEEN'S DRIVE

QUEEN'S CRESCENT

KEY:

- Existing road markings
- New 75mm wide double yellow lines to Diagram 1018.1 of the Traffic Signs Regulations and General Directions 2016

NOTES

Double yellow lines at the start of Queen's Crescent extend for a distance of 14 metres from the perpendicular of the junction.



06/04/2023	TRO	2	GM
07/02/2023	Consultation	1	GM
23/08/2022	First Issue	0	GM
DATE	AMENDMENTS	REV	BY



Traffic Management
BOROUGH HALL, CAULDWELL ST, BEDFORD, MK42 9AP
Tel. (01234) 267422

CLIENT
Environment

SCHEME
**Queens Drive /
Queens Crescent, Bedford**

DRAWING TITLE
**Proposed 'No waiting at any time'
(Double Yellow Lines)**

DRG STATUS TRO			
SCALE @ A3 NTS	DATE 23/08/2022	DRAWN GM	CHECKED AP

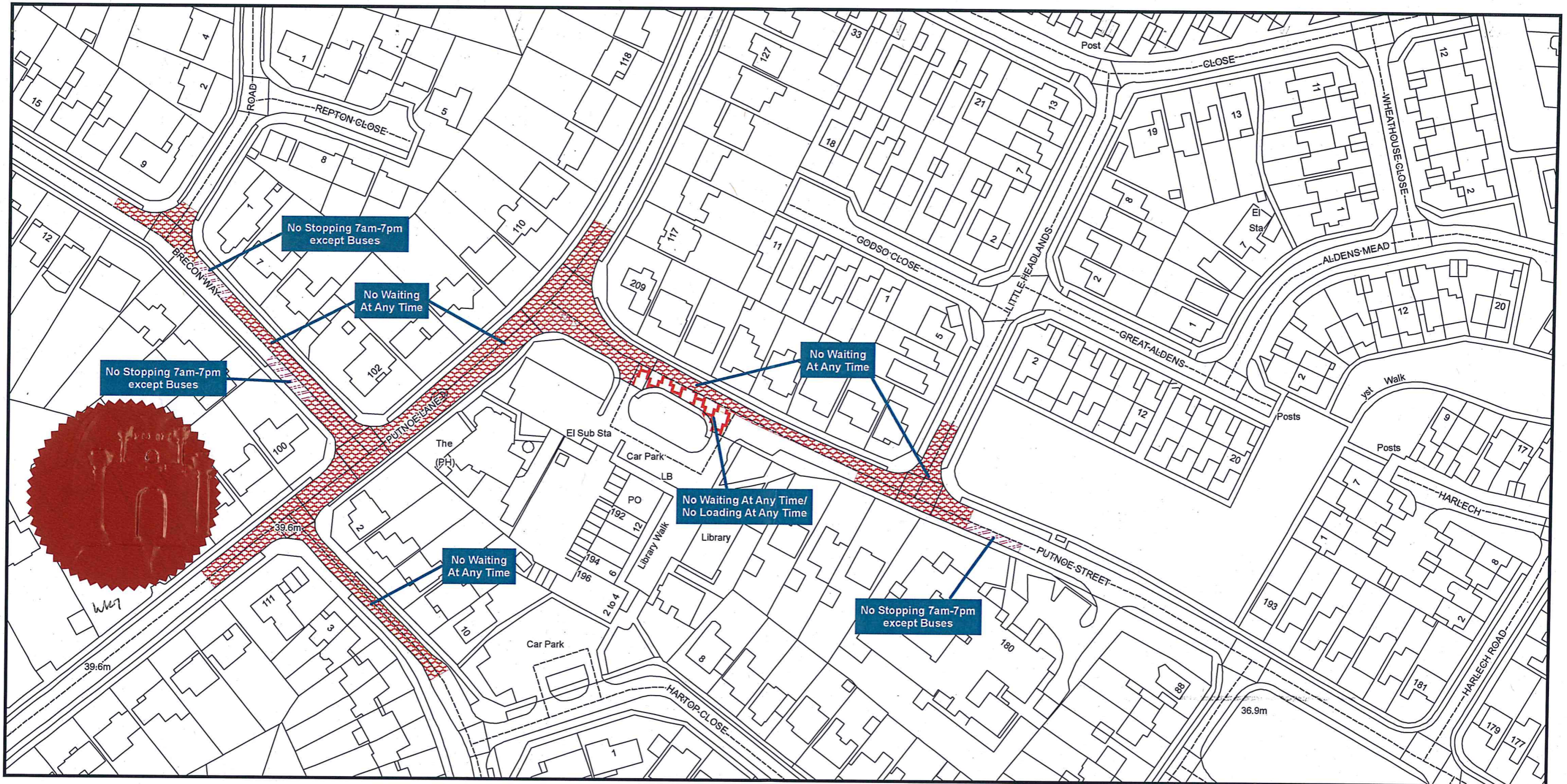

Bedford Borough Council (Bedford Urban Area (North of the River excluding Queens Park and CPZ areas)) (Prohibition and Restriction of Waiting and Loading and Parking Places) Order 2009



Bedford Borough Council
Borough Hall
Cauldwell Street
Bedford MK42 9AP

Reproduced from the Ordnance Survey map with the permission of Her Majesty's Stationary Office © Crown Copyright Licence No. LA077127 (2023). Unauthorised reproduction infringes Crown Copyright and may lead to prosecution or civil proceedings.

Scale - 1:1,250



NEW

PRINTS FROM THIS DRAWING ARE UNCONTROLLED UNLESS OTHERWISE STATED

A3

KEY:

— New 75mm wide double yellow lines to Diagram 1018.1 of the Traffic Signs Regulations and General Directions 2016



WTP

06/04/2023	TRO	2	GM
08/03/2023	Consultation	1	GM
19/08/2022	First Issue	0	GM
DATE	AMENDMENTS	REV	BY



Traffic Management
BOROUGH HALL, CAULDWELL ST, BEDFORD, MK42 9AP
Tel. (01234) 267422

CLIENT
Environment

SCHEME
Bamburgh Drive, Bedford

DRAWING TITLE
**Proposed 'No waiting at any time'
(Double Yellow Lines)**

DRG STATUS
TRO

SCALE @ A3	DATE	DRAWN	CHECKED
NTS	19/08/2022	GM	AP

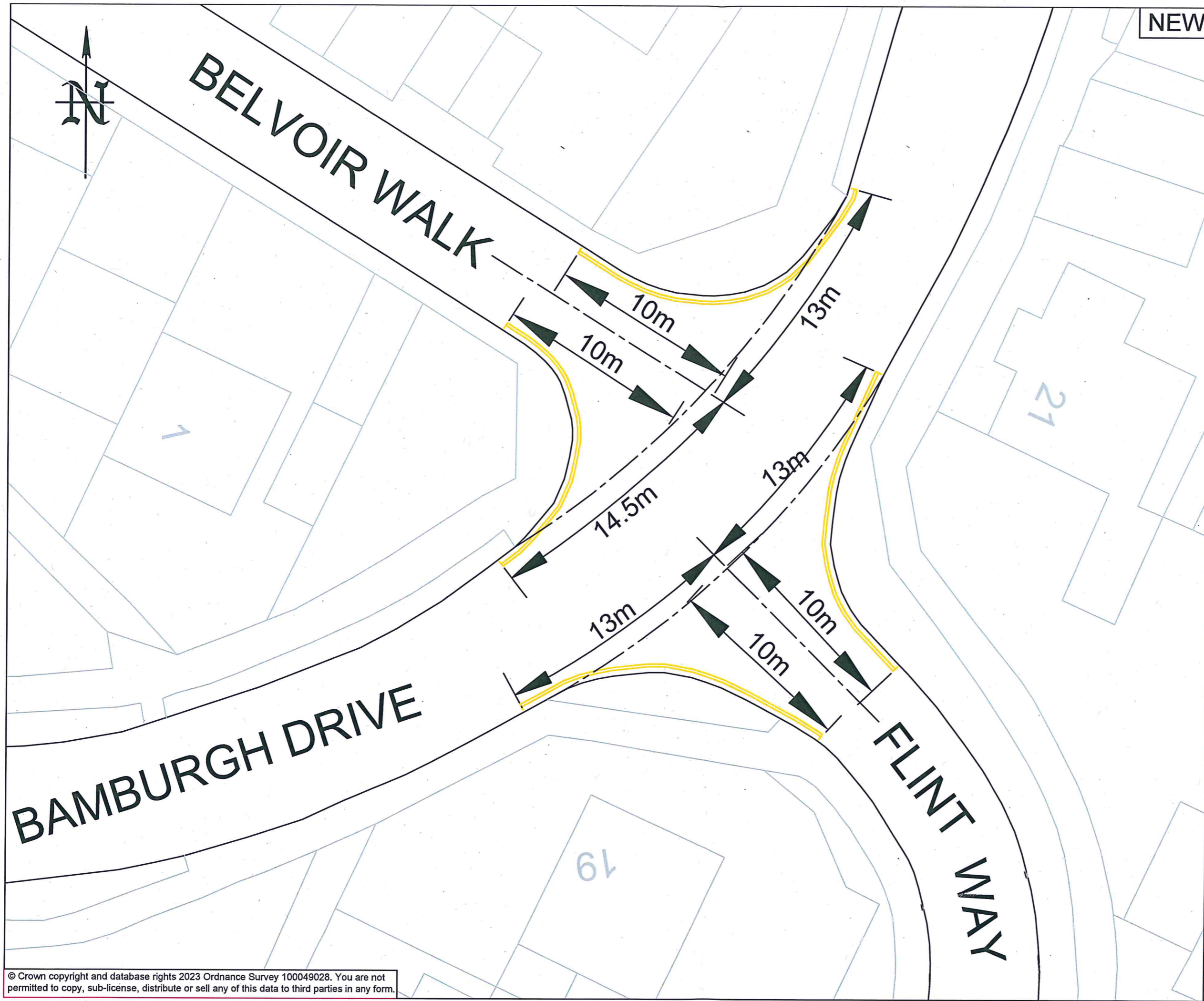

© Crown copyright and database rights 2023 Ordnance Survey 100049028. You are not permitted to copy, sub-license, distribute or sell any of this data to third parties in any form.

NEW

PRINTS FROM THIS DRAWING ARE UNCONTROLLED UNLESS OTHERWISE STATED

A3



KEY:

- Existing road markings
- New 75mm wide double yellow lines to Diagram 1018.1 of the Traffic Signs Regulations and General Directions 2016.



W.M.

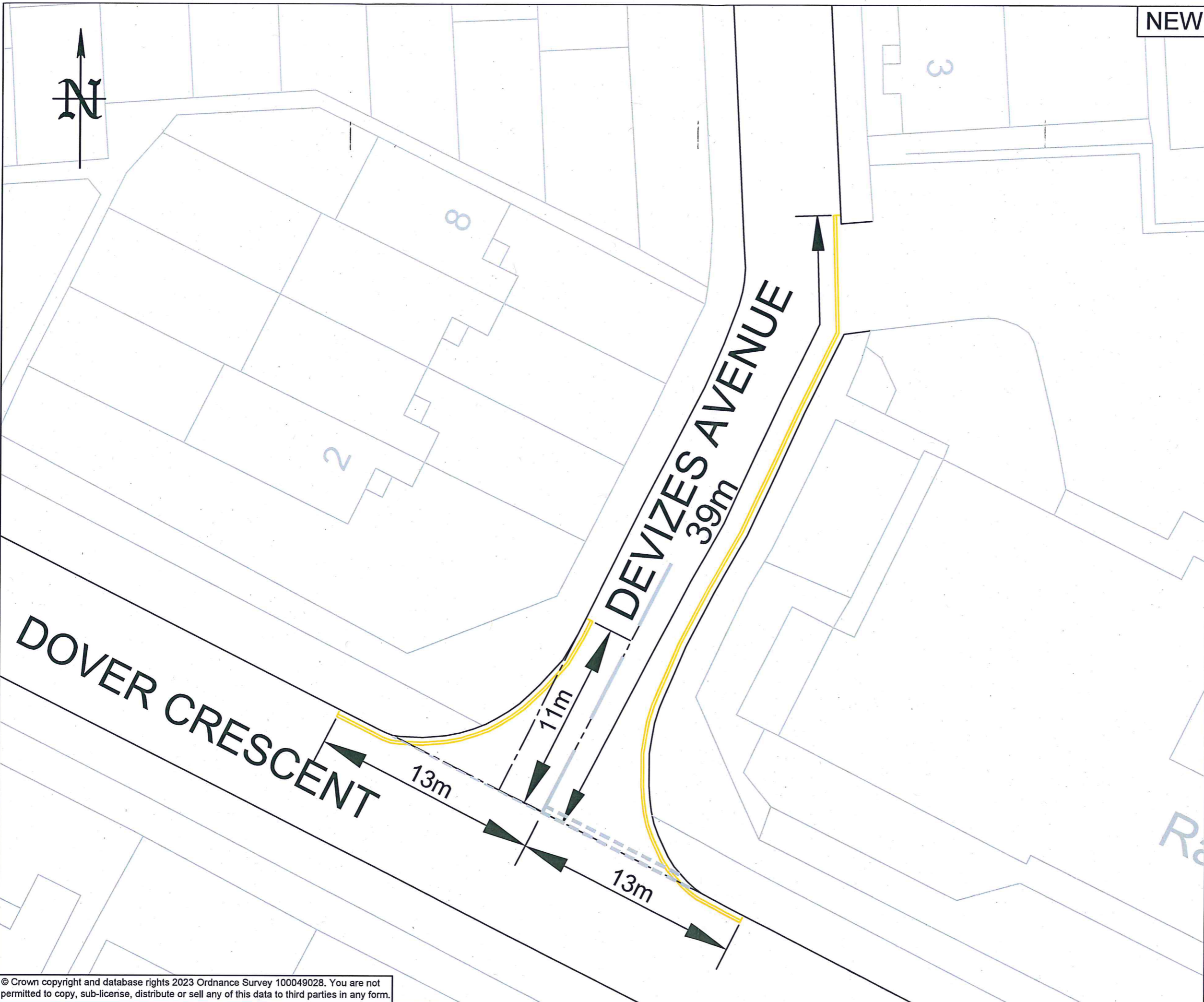

06/04/2023	TRO	2	GM
07/02/2023	Consultation	1	GM
26/07/2022	First Issue	0	GM
DATE	AMENDMENTS	REV	BY



Traffic Management
 BOROUGH HALL, CAULDWELL ST, BEDFORD, MK42 9AP
 Tel. (01234) 267422

CLIENT
Environment

SCHEME
**Dover Crescent /
 Devizes Avenue, Bedford**

DRAWING TITLE
**Proposed 'No waiting at any time'
 (Double Yellow Lines)**

DRG STATUS
TRO

SCALE @ A3	DATE	DRAWN	CHECKED
NTS	26/07/2022	GM	AP

© Crown copyright and database rights 2023 Ordnance Survey 100049028. You are not permitted to copy, sub-license, distribute or sell any of this data to third parties in any form.

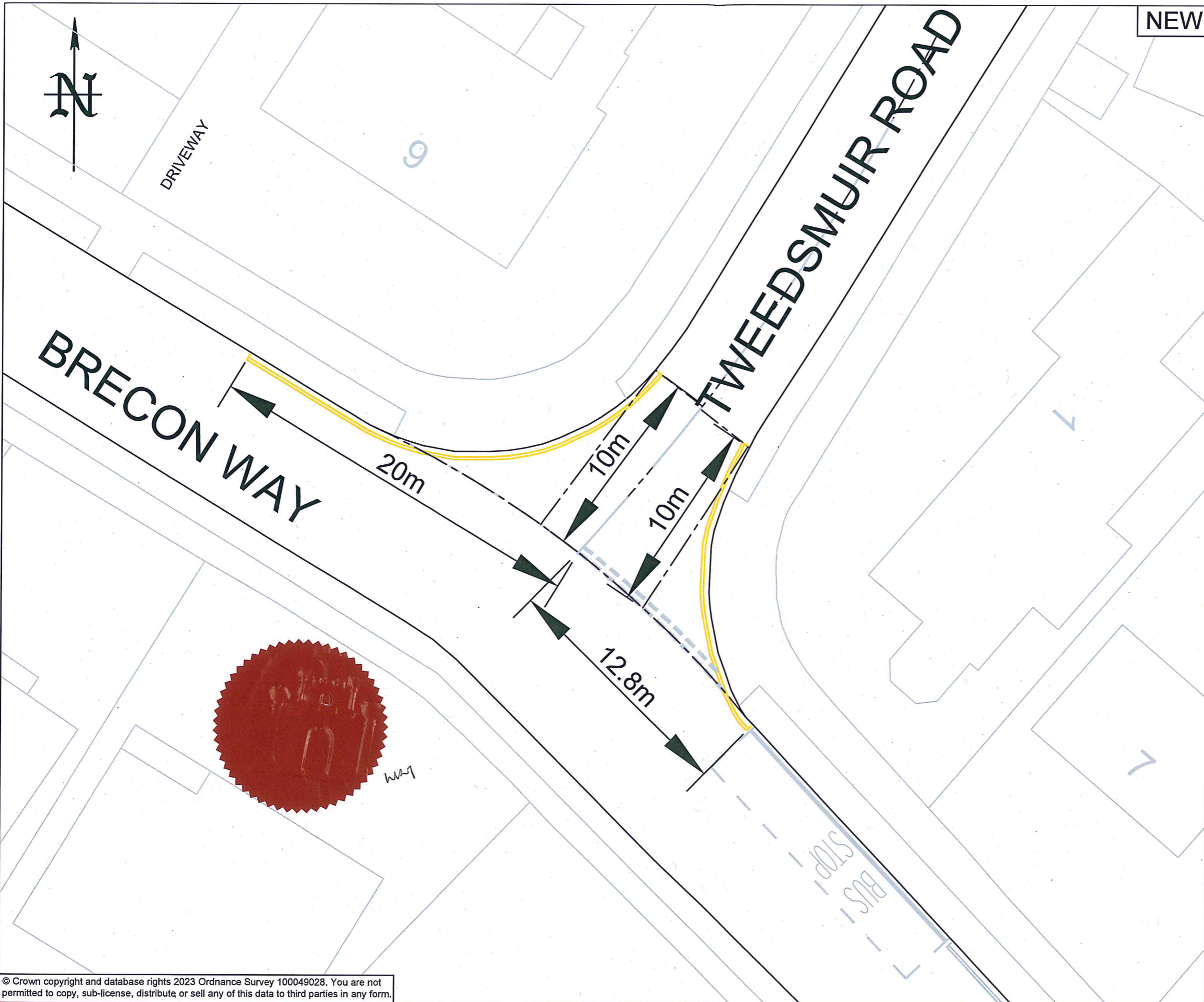



NEW

PRINTS FROM THIS DRAWING ARE UNCONTROLLED UNLESS OTHERWISE STATED

A3

KEY:

-  Existing road markings
-  New 75mm wide double yellow lines to Diagram 1018.1 of the Traffic Signs Regulations and General Directions 2016

NOTES

Double yellow lines at the start of Tweedsmuir Road extend for a distance of 10 metres from the perpendicular of the junction. The double yellow lines on the north-east side of Brecon Way extend in a south-easterly direction for a distance of approximately 12.8m from the centre line of Tweedsmuir Road up to the start of the existing Bus Stop cage.

DATE	AMENDMENTS	REV	BY
06/04/2023	TRO	2	GM
07/02/2023	Consultation	1	GM
05/07/2022	First Issue	0	GM



Traffic Management
BOROUGH HALL, CAULDWELL ST, BEDFORD, MK42 9AP
Tel. (01234) 267422

CLIENT
Environment

SCHEME
**Brecon Way /
Tweedsmuir Road, Bedford**

DRAWING TITLE
**Proposed 'No waiting at any time'
(Double Yellow Lines)**

DRG STATUS
TRO

SCALE @ A3	DATE	DRAWN	CHECKED
NTS	05/07/2022	GM	AP



Bedford Borough Council (Bedford Urban Area (North of the River excluding Queens Park and CPZ areas)) (Prohibition and Restriction of Waiting and Loading and Parking Places) Order 2009

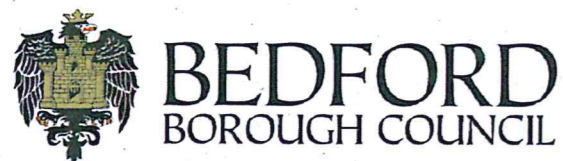

Bedford Borough Council
Borough Hall
Cauldwell Street
Bedford MK42 9AP

Reproduced from the Ordnance Survey map with the permission of Her Majesty's Stationary Office © Crown Copyright Licence No. LA077127 (2023). Unauthorised reproduction infringes Crown Copyright and may lead to prosecution or civil proceedings.

Scale - 1:1,250



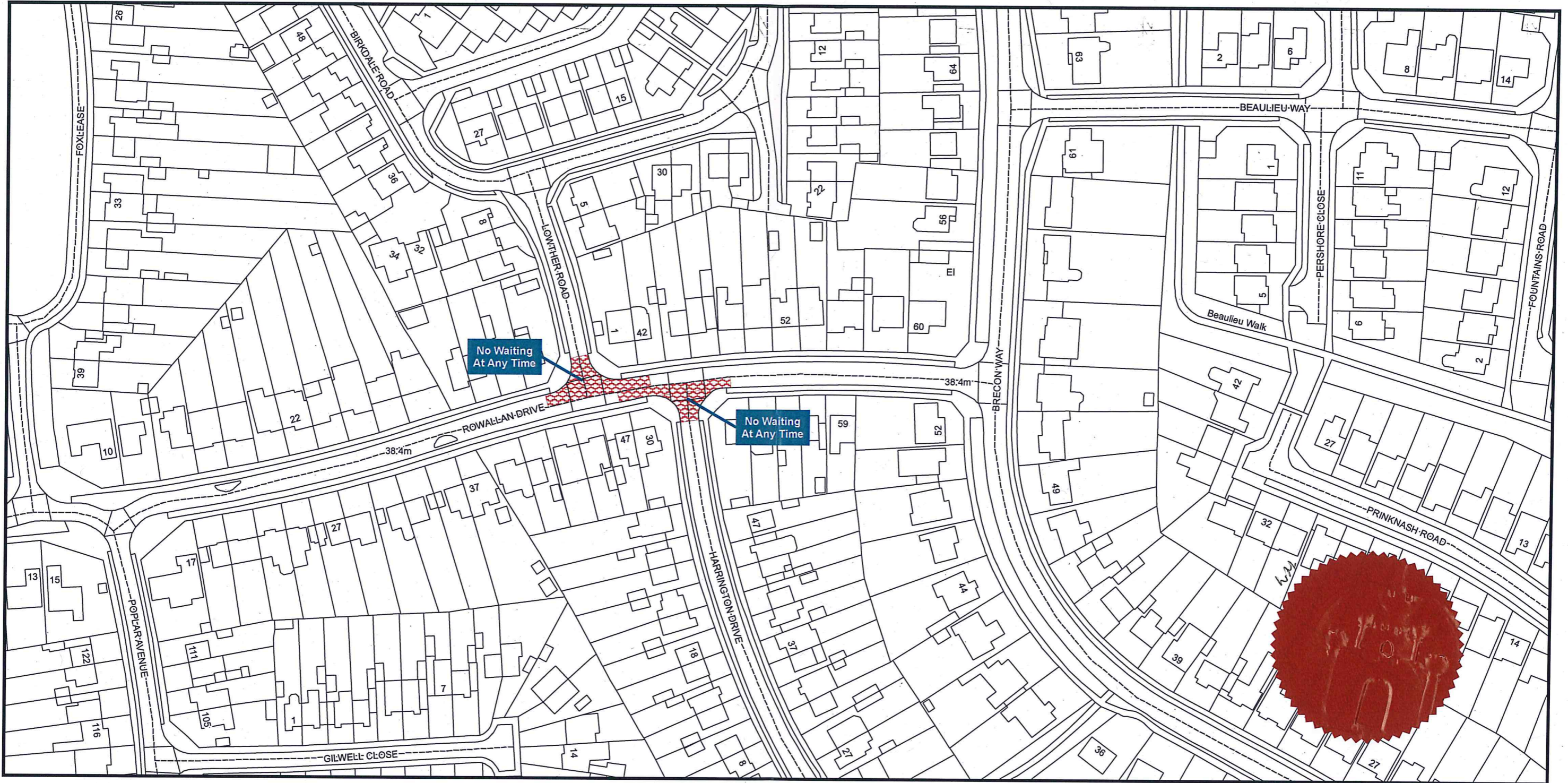

Bedford Borough Council (Bedford Urban Area (North of the River excluding Queens Park and CPZ areas)) (Prohibition and Restriction of Waiting and Loading and Parking Places) Order 2009



Bedford Borough Council
Borough Hall
Cauldwell Street
Bedford MK42 9AP

Reproduced from the Ordnance Survey map with the permission of Her Majesty's Stationary Office © Crown Copyright Licence No. LA077127 (2023). Unauthorised reproduction infringes Crown Copyright and may lead to prosecution or civil proceedings.

Scale - 1:1,250



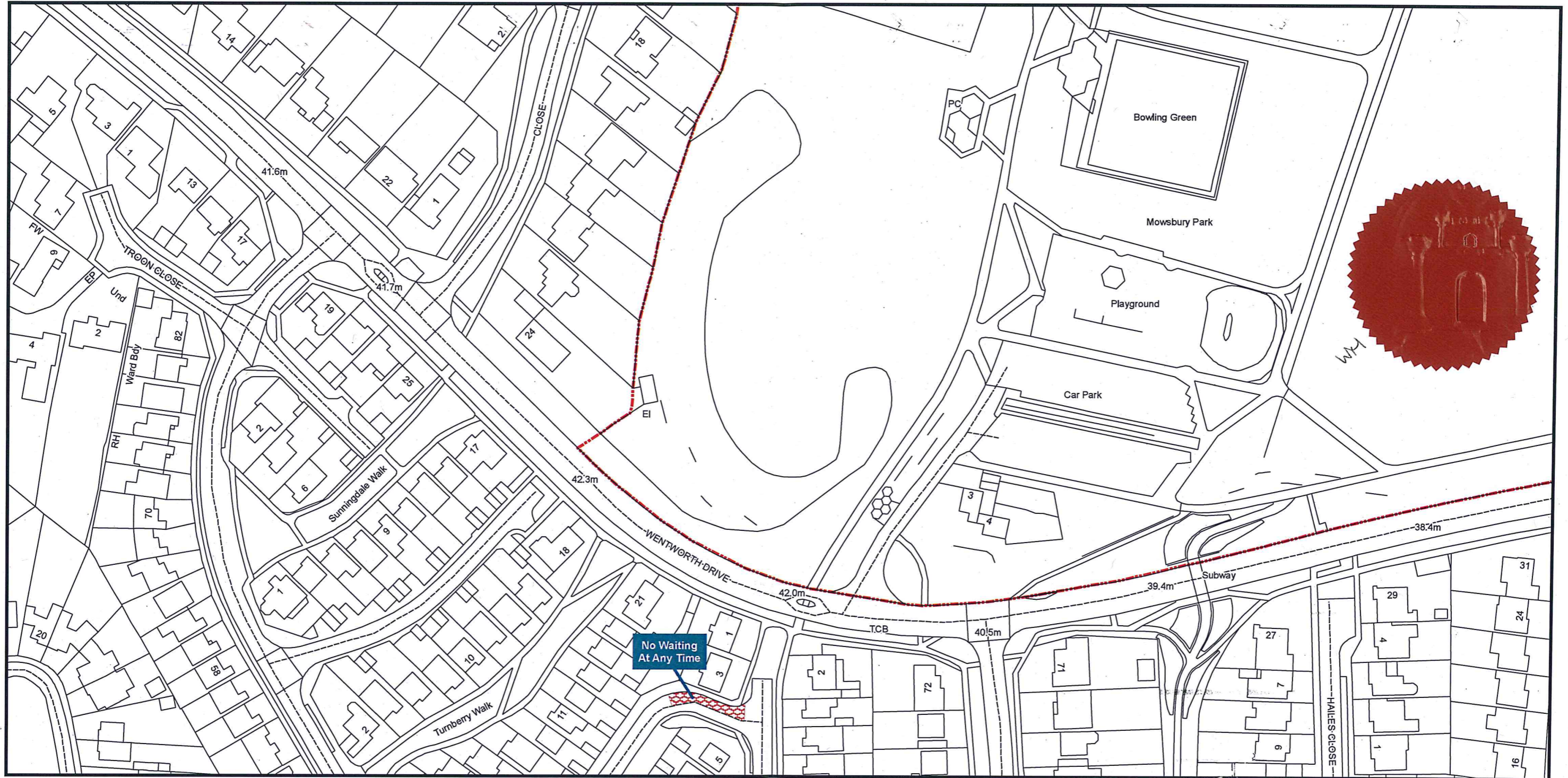

Bedford Borough Council (Bedford Urban Area (North of the River excluding Queens Park and CPZ areas)) (Prohibition and Restriction of Waiting and Loading and Parking Places) Order 2009

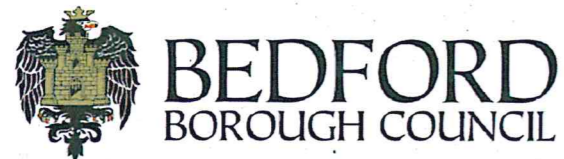

Bedford Borough Council
Borough Hall
Cauldwell Street
Bedford MK42 9AP



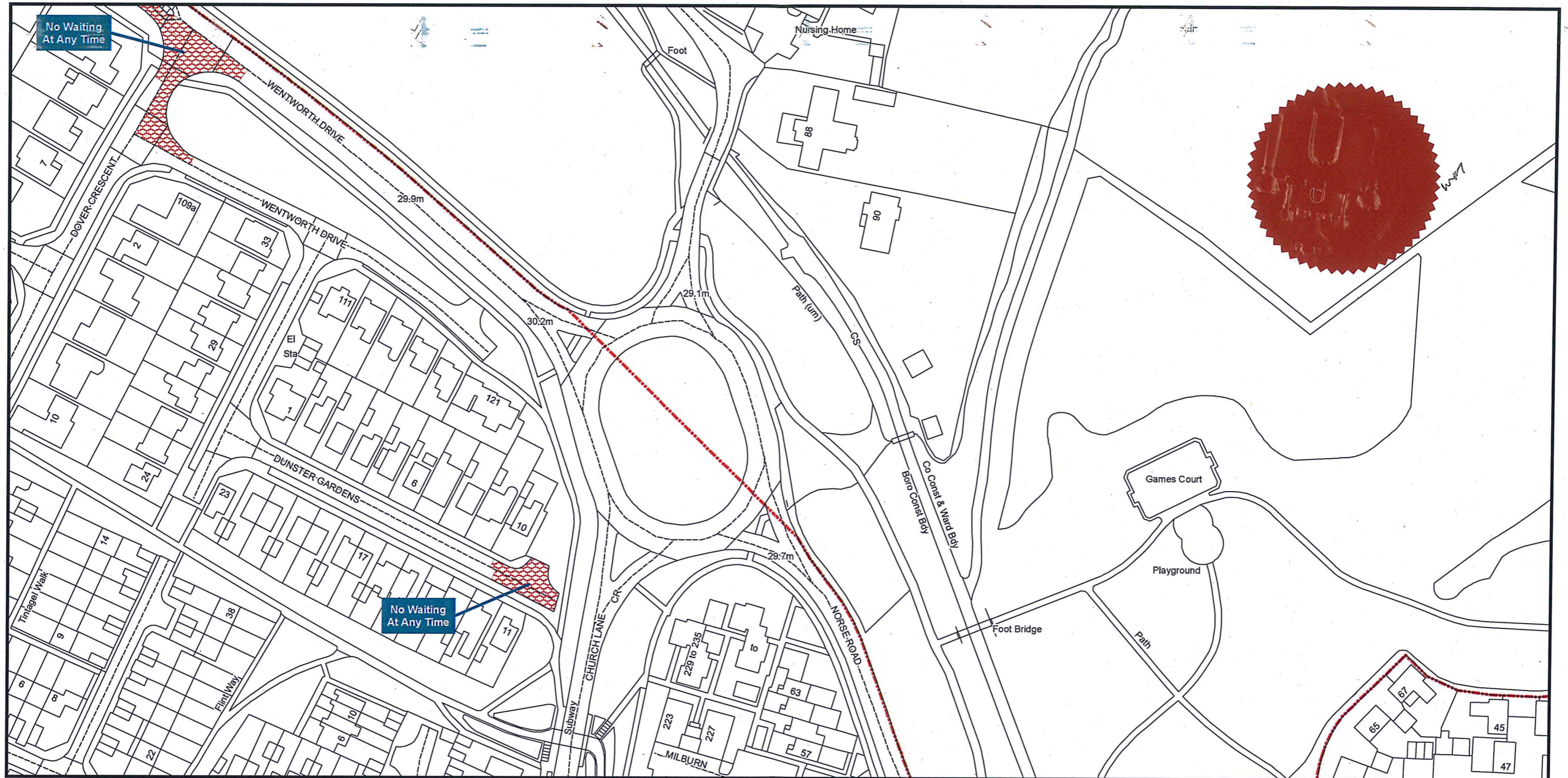

Bedford Borough Council (Bedford Urban Area (North of the River excluding Queens Park and CPZ areas)) (Prohibition and Restriction of Waiting and Loading and Parking Places) Order 2009



Bedford Borough Council
Borough Hall
Cauldwell Street
Bedford MK42 9AP

Reproduced from the Ordnance Survey map with the permission of Her Majesty's Stationary Office © Crown Copyright Licence No. LA077127 (2023). Unauthorised reproduction infringes Crown Copyright and may lead to prosecution or civil proceedings.

Scale - 1:1,250



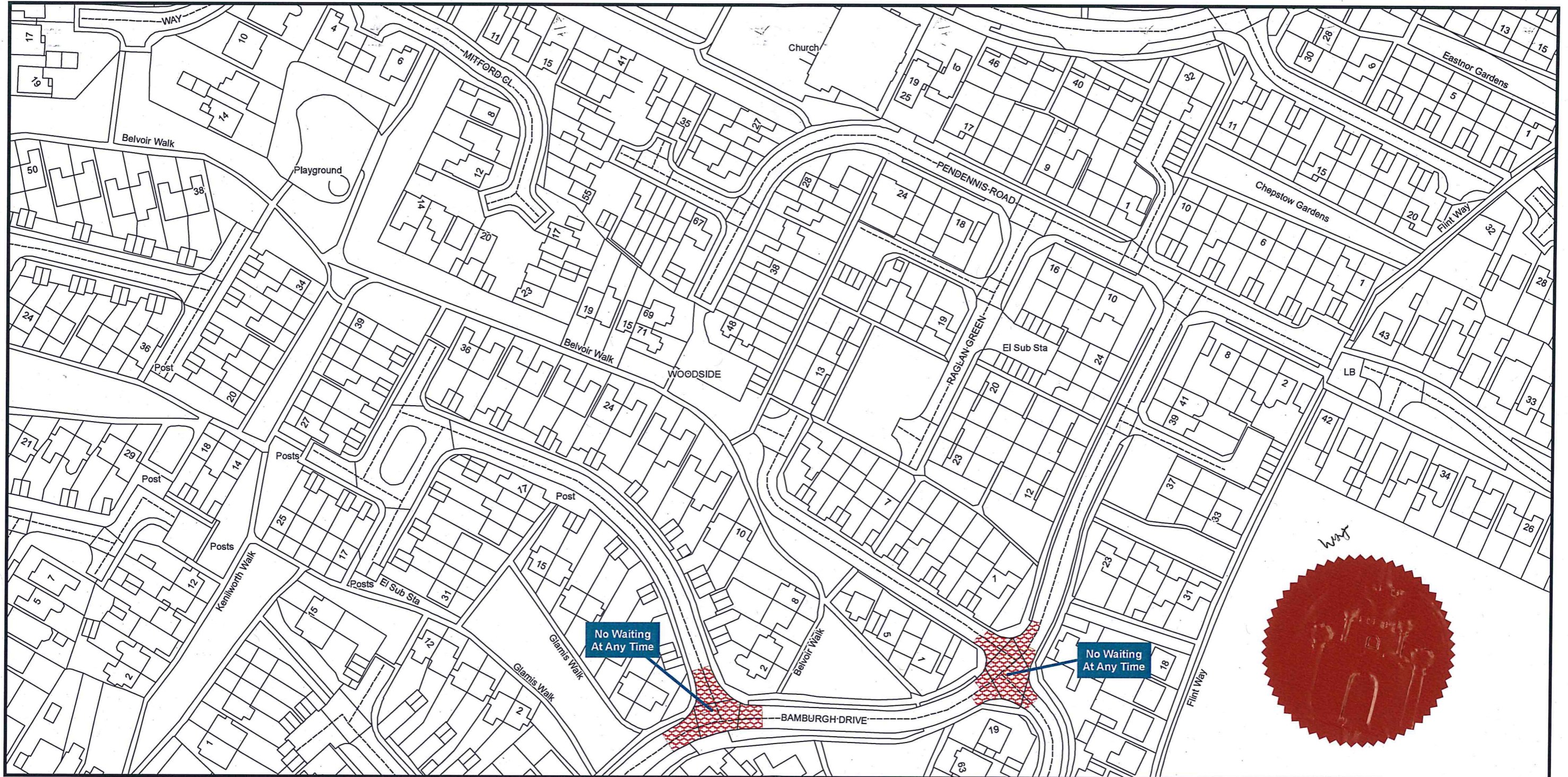

Bedford Borough Council (Bedford Urban Area (North of the River excluding Queens Park and CPZ areas)) (Prohibition and Restriction of Waiting and Loading and Parking Places) Order 2009



Bedford Borough Council
Borough Hall
Cauldwell Street
Bedford MK42 9AP

Reproduced from the Ordnance Survey map with the permission of Her Majesty's Stationary Office © Crown Copyright Licence No. LA077127 (2023). Unauthorised reproduction infringes Crown Copyright and may lead to prosecution or civil proceedings.

Scale - 1:1,250



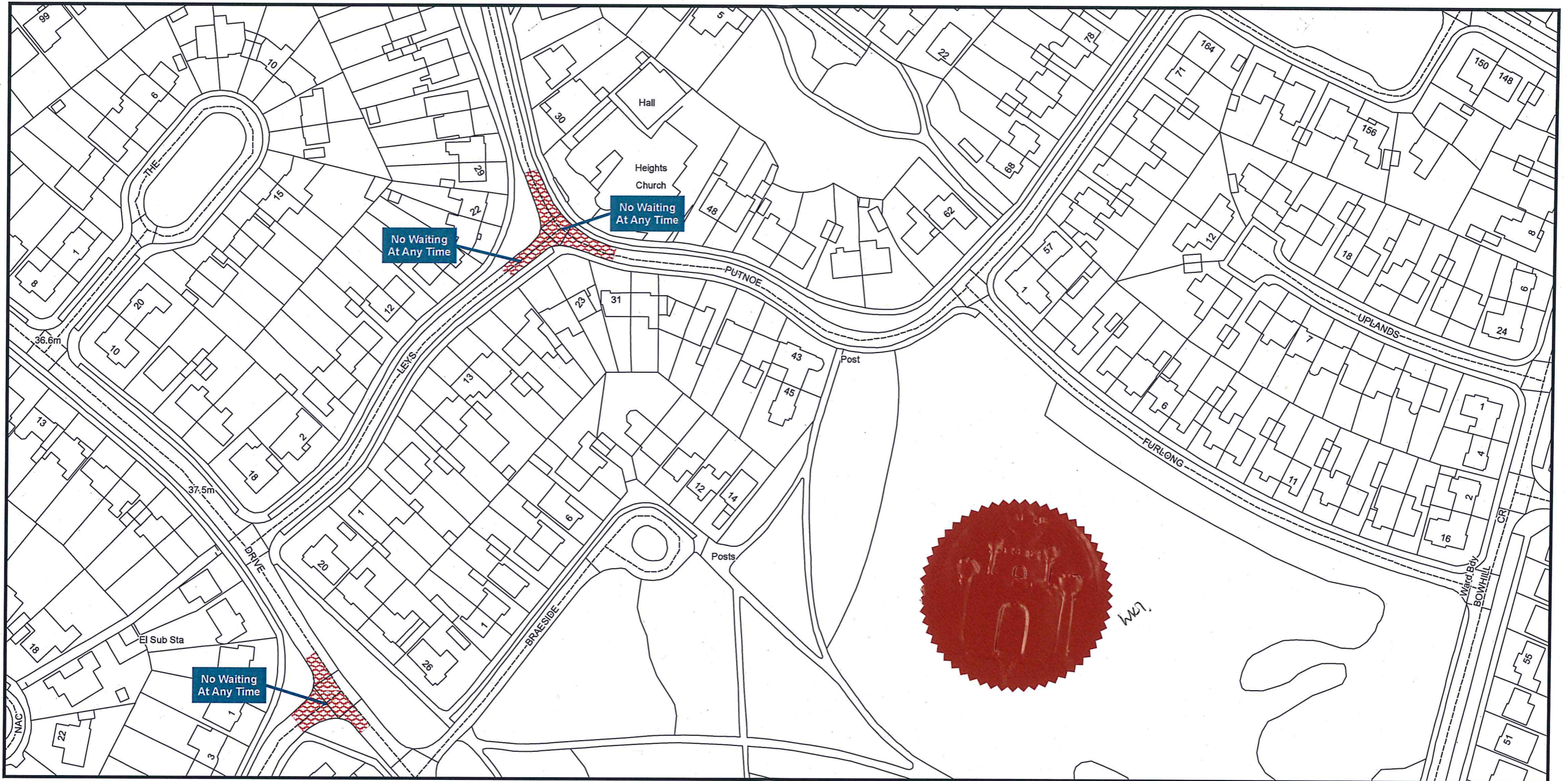

Bedford Borough Council (Bedford Urban Area (North of the River excluding Queens Park and CPZ areas)) (Prohibition and Restriction of Waiting and Loading and Parking Places) Order 2009

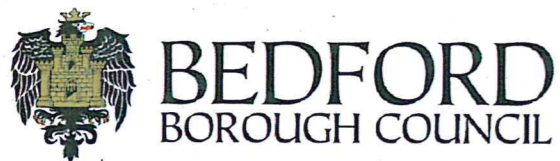

Bedford Borough Council
Borough Hall
Cauldwell Street
Bedford MK42 9AP

Reproduced from the Ordnance Survey map with the permission of Her Majesty's Stationary Office © Crown Copyright Licence No. LA077127 (2023). Unauthorised reproduction infringes Crown Copyright and may lead to prosecution or civil proceedings.

Scale - 1:1,250



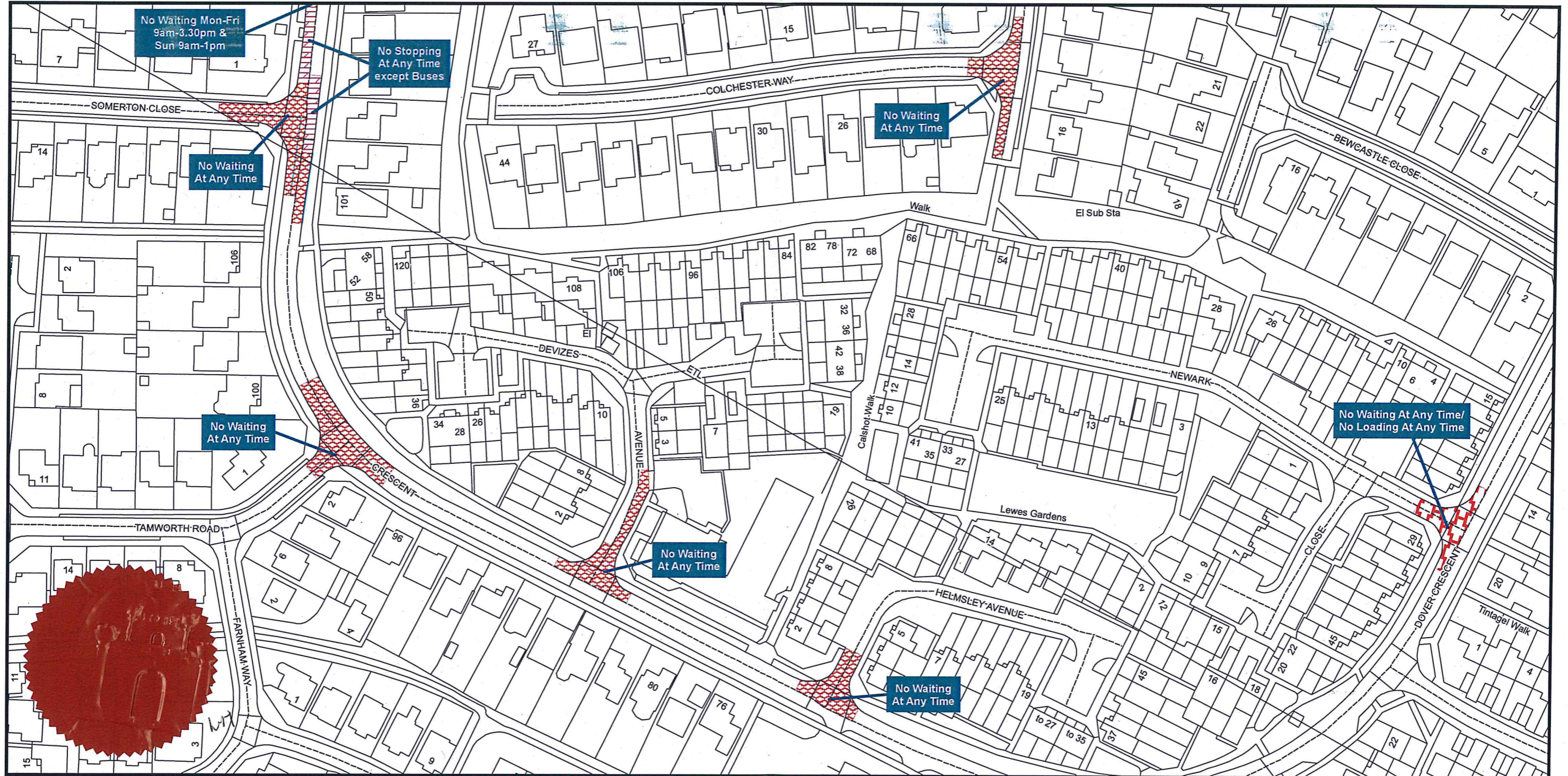

Bedford Borough Council (Bedford Urban Area (North of the River excluding Queens Park and CPZ areas)) (Prohibition and Restriction of Waiting and Loading and Parking Places) Order 2009

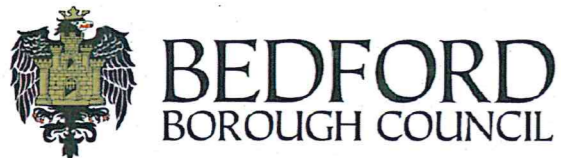

Bedford Borough Council
Borough Hall
Cauldwell Street
Bedford MK42 9AP

Reproduced from the Ordnance Survey map with the permission of Her Majesty's Stationary Office © Crown Copyright Licence No. LA077127 (2023). Unauthorised reproduction infringes Crown Copyright and may lead to prosecution or civil proceedings.

Scale - 1:1,250







NEW

PRINTS FROM THIS DRAWING ARE UNCONTROLLED UNLESS OTHERWISE STATED

A3

KEY:

-  Existing double yellow lines
-  New 75mm wide double yellow lines to Diagram 1018.1 of the Traffic Signs Regulations and General Directions 2016

NOTES

Extend existing double yellow lines at the start of Greenacres on both sides by an additional 10 metres, giving a total distance of 26 metres from the perpendicular of the junction.



PUTNOE LANE

GREENACRES

16m

26m

10m

87

62

06/04/2023	TRO	2	GM
07/02/2023	Consultation	1	GM
07/07/2022	First Issue	0	GM
DATE	AMENDMENTS	REV	BY



Traffic Management
BOROUGH HALL, CAULDWELL ST, BEDFORD, MK42 9AP
Tel. (01234) 267422

CLIENT
Environment

SCHEME
Putnoe Lane / Greenacres, Bedford

DRAWING TITLE
Proposed extension to existing 'No waiting at any time' restriction

(Double Yellow Lines)

DRG STATUS
TRO

SCALE @ A3	DATE	DRAWN	CHECKED
NTS	07/07/2022	GM	AP

NEW

PRINTS FROM THIS DRAWING ARE UNCONTROLLED UNLESS OTHERWISE STATED

A3

KEY:



New 75mm wide double yellow lines to Diagram 1018.1 of the Traffic Signs Regulations and General Directions 2016



WM

06/04/2023	TRO	2	GM
07/02/2023	Consultation	1	GM
05/07/2022	First Issue	0	GM
DATE	AMENDMENTS	REV	BY



BEDFORD
BOROUGH COUNCIL

Traffic Management

BOROUGH HALL, CAULDWELL ST, BEDFORD, MK42 9AP
Tel. (01234) 267422

CLIENT

Environment

SCHEME

Greenacres, Bedford

DRAWING TITLE

Proposed 'No waiting at any time'
(Double Yellow Lines)

DRG STATUS

TRO

SCALE @ A3	DATE	DRAWN	CHECKED
NTS	05/07/2022	GM	AP

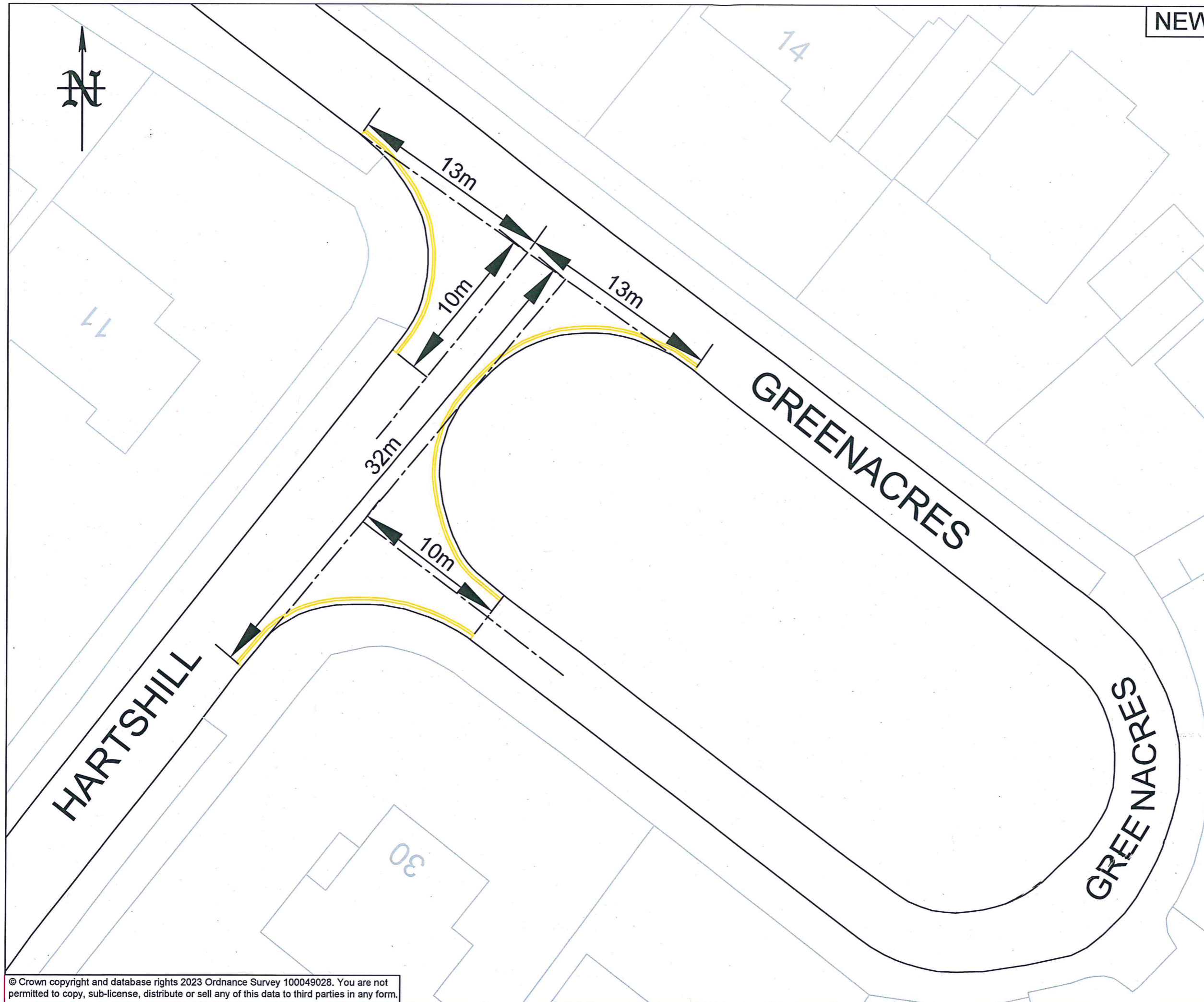

© Crown copyright and database rights 2023 Ordnance Survey 100049028. You are not permitted to copy, sub-license, distribute or sell any of this data to third parties in any form.

NEW

PRINTS FROM THIS DRAWING ARE UNCONTROLLED UNLESS OTHERWISE STATED

A3



KEY:

 New 75mm wide double yellow lines to Diagram 1018.1 of the Traffic Signs Regulations and General Directions 2016



W1



06/04/2023	TRO	2	GM
07/02/2023	Consultation	1	GM
05/07/2022	First Issue	0	GM
DATE	AMENDMENTS	REV	BY



Traffic Management
BOROUGH HALL, CAULDWELL ST, BEDFORD, MK42 9AP
Tel. (01234) 267422

CLIENT
Environment

SCHEME
Birkdale Road, Bedford

DRAWING TITLE
**Proposed 'No waiting at any time'
(Double Yellow Lines)**

DRG STATUS
TRO

SCALE @ A3	DATE	DRAWN	CHECKED
NTS	05/07/2022	GM	AP