



PUBLIC NOTICE

BEDFORD BOROUGH COUNCIL PROPOSE TO INTRODUCE NEW PARKING RESTRICTIONS IN LEIGHFIELD CLOSE, NEEDWOOD ROAD AND STAINMORE ROAD, BEDFORD

Reason for Proposal:

Bedford Borough Council has received a request from Ward councillors for new parking restrictions at the junction of Needwood Road with Stainmore Road, and in Leighfield Close opposite the entrance to a parking area. This is in response to concerns raised over inconsiderate parking at these locations which affects visibility and safety, so these restrictions are intended to remedy that.

Effect of the Order:

1. To introduce “No waiting at any time” restrictions (double yellow lines) on the following lengths of roads:

A	Leighfield Close, Bedford
(i)	On its western kerb, extending from the projected southern boundary of no.23 Leighfield Close for a distance of approx. 17 metres in a northerly direction.
B	Needwood Road, Bedford
(i)	On its north-eastern kerb, extending from the centre of Stainmore Road for a distance of approx. 14 metres in both a north-westerly direction and south-easterly direction.
C	Stainmore Road, Bedford
(i)	On both sides, extending from its junction with Needwood Road for a distance of approx. 12 metres in a north-easterly direction.

Relevant proposal documents are available for viewing on the council's website at www.bedford.gov.uk/proposedtro, and may also be examined during normal office hours at Borough Hall, Cauldwell Street, Bedford, MK42 9AP. The documents will be placed on deposit until 6 weeks after the Order is made or until it is decided not to continue with the proposal. For further information, please contact Andrew Prigmore at Bedford Borough Council on 01234 276691.

Comments supporting or objecting to the proposal should be put in an email, stating the grounds on which they are made, and sent no later than 18th July 2024 to highway.consultations@bedford.gov.uk.

Order Title if made will be:

1. Bedford Borough Council (Bedford Urban Area (North of the River Excluding Queens Park and CPZ Areas)) (Prohibition and Restriction of Waiting and Loading and Parking Places) Order 2009 (Amendment No.***) Order 20**.

Dated: 20th June 2024

Borough Hall, Cauldwell Street
Bedford, MK42 9AP

Craig Austin
Director of Environment



BEDFORD BOROUGH COUNCIL
(BEDFORD URBAN AREA (NORTH OF THE RIVER EXCLUDING QUEENS PARK
AND CPZ AREAS)) (PROHIBITION AND RESTRICTION OF WAITING AND
LOADING AND PARKING PLACES) ORDER 2009
(AMENDMENT NO.106) ORDER 2024

BEDFORD BOROUGH COUNCIL ("the Council") in exercise of the powers conferred by Sections 1(1), 2(1) to (3) and 4(2) of, and Part IV of Schedule 9 to, the Road Traffic Regulation Act 1984 ("the Act") and of all other powers enabling them in that behalf, and after consultation with the Chief Officer of Police in accordance with Part III of Schedule 9 to the Act, hereby make the following Order:-

1. This Order may be cited as the "Bedford Borough Council (Bedford Urban Area (North of the River Excluding Queens Park and CPZ Areas)) (Prohibition and Restriction of Waiting and Loading and Parking Places) Order 2009 (Amendment No.106) Order 2024" and shall come into force on 29th July 2024.
2. As from the date upon which this Order comes into force the provisions of the Bedford Borough Council (Bedford Urban Area (North of the River Excluding Queens Park and CPZ Areas)) (Prohibition and Restriction of Waiting and Loading and Parking Places) Order 2009 as amended shall be varied as follows:
 - (i) The plan schedule reference "Grid Ref: Q 20 Revision No: 3" shall be deleted and the plan schedule reference "Grid Ref: Q 20 Revision No: 4" shall be inserted.
 - (ii) The plan schedule reference "Grid Ref: Q 21 Revision No: 3" shall be deleted and the plan schedule reference "Grid Ref: Q 21 Revision No: 4" shall be inserted.

- (iii) The plan schedule reference “Grid Ref: Q 22 Revision No: 3” shall be deleted and the plan schedule reference “Grid Ref: Q 22 Revision No: 4” shall be inserted.

3. This Amendment shall be read and construed as one with the Bedford Borough Council (Bedford Urban Area (North of the River Excluding Queens Park and CPZ Areas)) (Prohibition and Restriction of Waiting and Loading and Parking Places) Order 2009 as amended.

**THE COMMON SEAL of the
BEDFORD BOROUGH COUNCIL**

was hereunto affixed this
25th day of July 2024
in the presence of:



Wai K. Tsang
Solicitor
Legal Services
Bedford Borough Council

Authorised Signatory

AUTHORITY FOR EXECUTION		
COUNCIL/COMMITTEE	MINUTE No.	DATE
DELEGATED POWER	By whom executed ENVIRONMENT	19/07/2024
	OFFICERS INITIALS	DATE
ORIGINATED AND CHECKED BY	GM	19/07/2024
APPROVED BY	AP	19/07/2024



BEDFORD BOROUGH COUNCIL
(BEDFORD URBAN AREA (NORTH OF THE RIVER EXCLUDING QUEENS PARK
AND CPZ AREAS)) (PROHIBITION AND RESTRICTION OF WAITING AND
LOADING AND PARKING PLACES) ORDER 2009
(AMENDMENT NO.106) ORDER 2024

STATEMENT OF REASONS

Bedford Borough Council has received a request from Ward councillors for new parking restrictions at the junction of Needwood Road with Stainmore Road, and in Leighfield Close opposite the entrance to a parking area. This is in response to concerns raised over inconsiderate parking at these locations which affects visibility and safety, so these restrictions are intended to remedy that.

Signed: [Signature]
[Name]
[Title]
[Date]

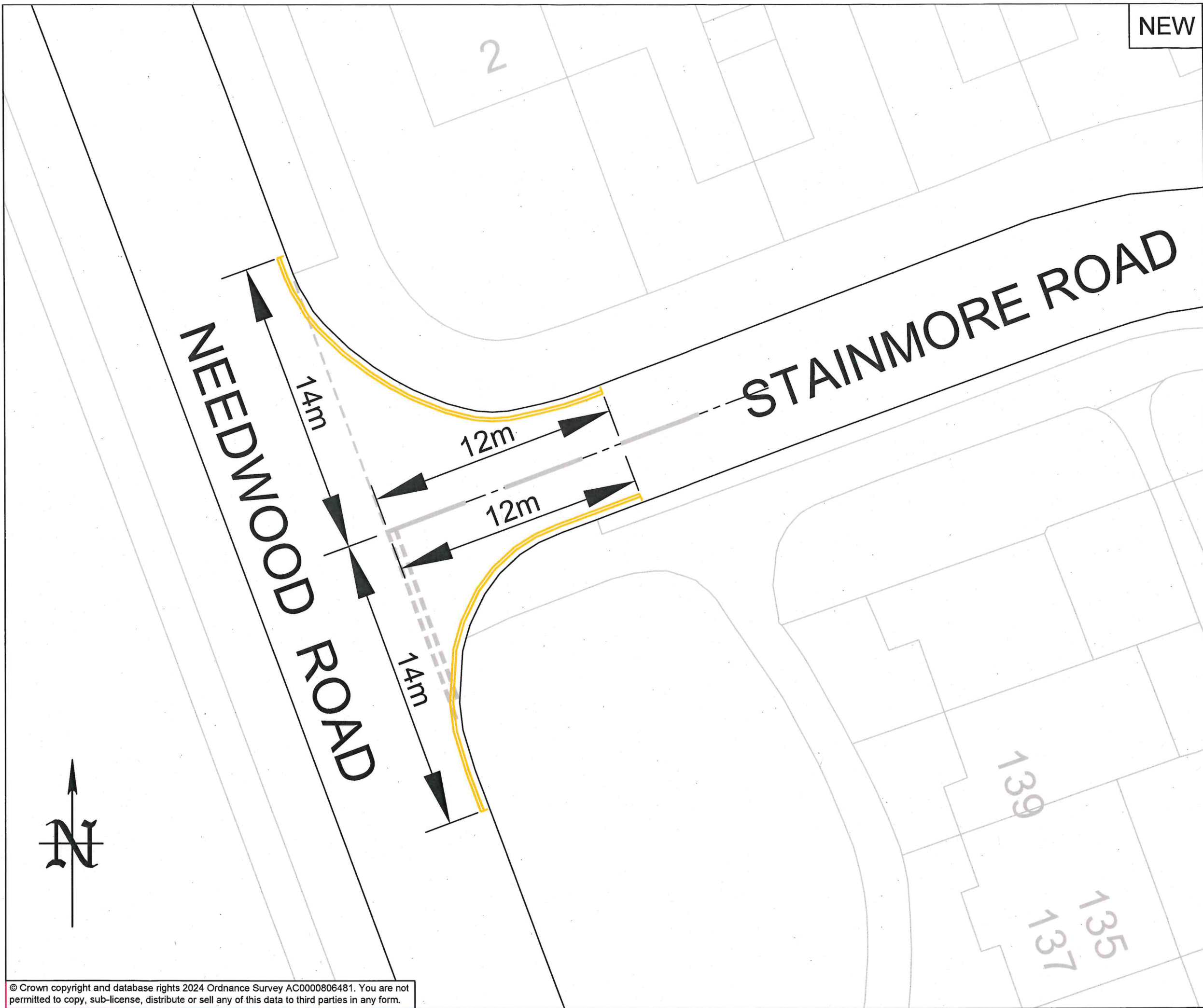

NEW

- KEY:**
- Existing road markings
 - New 75mm wide double yellow lines to Diagram 1018.1 of the Traffic Signs Regulations and General Directions 2016

NOTES

Double yellow lines at the start of Stainmore Road extend for a distance of 12 metres from the perpendicular of the junction.



23/07/2024	TRO	2	GM
14/06/2024	Consultation	1	GM
27/09/2022	First Issue	0	GM
DATE	AMENDMENTS	REV	BY

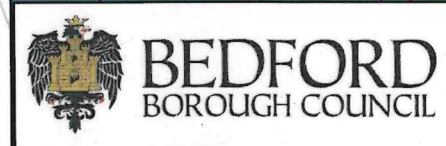

Traffic Management
BOROUGH HALL, CAULDWELL ST, BEDFORD, MK42 9AP
Tel. (01234) 267422

CLIENT
Environment

SCHEME
Stainmore Road, Bedford

DRAWING TITLE
New 'No waiting at any time' restriction (Double Yellow Lines)

DRG STATUS TRO			
SCALE @ A3 NTS	DATE 27/09/2022	DRAWN GM	CHECKED AP

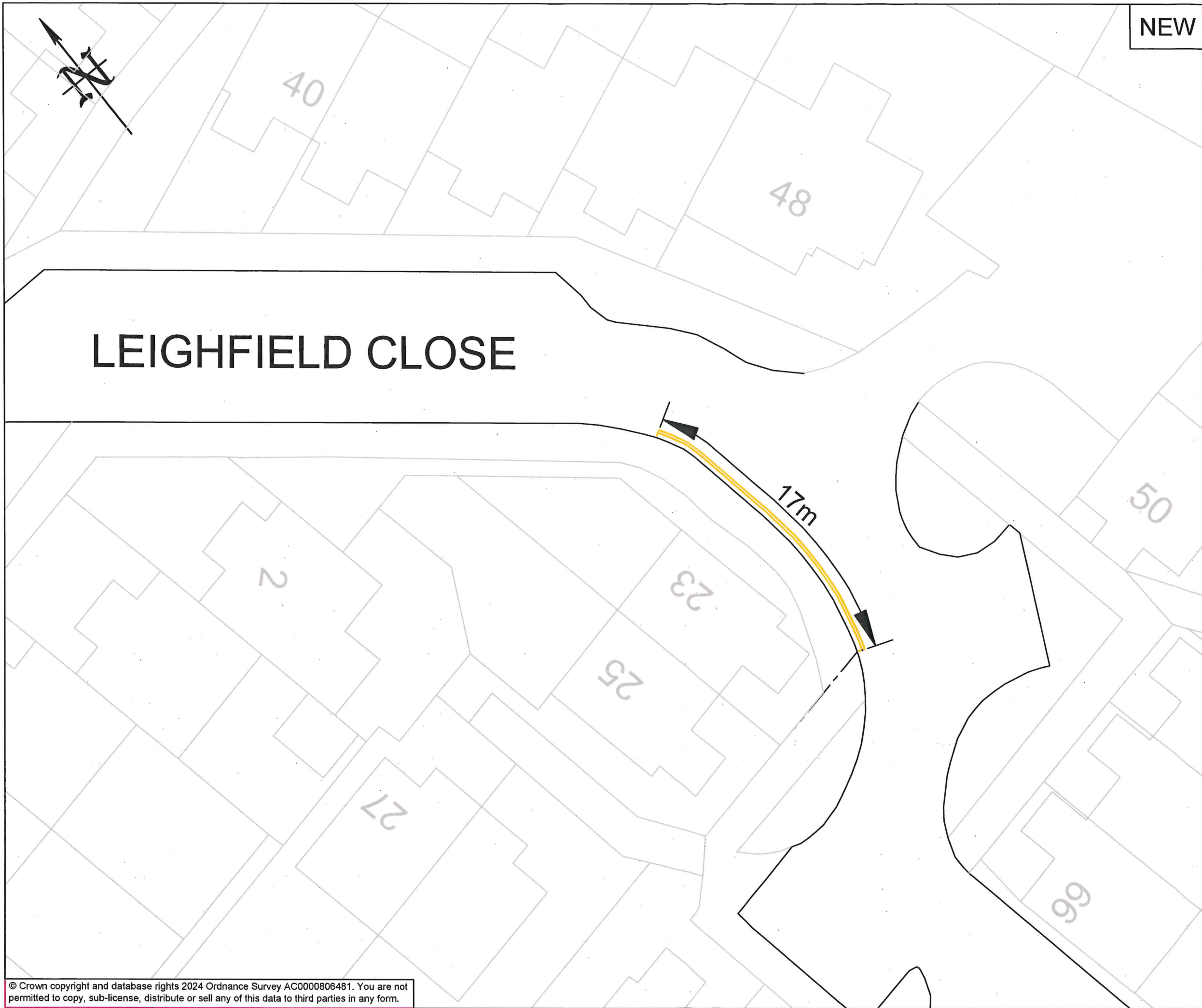

NEW

KEY:
New 75mm wide double yellow lines to Diagram 1018.1 of the Traffic Signs Regulations and General Directions 2016

NOTES
Double yellow lines on the western kerb of Leighfield Close at the projected southern boundary of number 23 Leighfield Close extend for a distance of 17 metres in a northerly direction.



23/07/2024	TRO	2	GM
14/06/2024	Consultation	1	GM
27/09/2022	First Issue	0	GM
DATE	AMENDMENTS	REV	BY



Traffic Management
BOROUGH HALL, CAULDWELL ST, BEDFORD, MK42 9AP
Tel. (01234) 267422

CLIENT
Environment

SCHEME
Leighfield Close, Bedford

DRAWING TITLE
New 'No waiting at any time' restriction (Double Yellow Lines)

DRG STATUS TRO			
SCALE @ A3 NTS	DATE 27/09/2022	DRAWN GM	CHECKED AP

Grid Ref: Q 21

Revision No: 4
Date: 29/07/2024

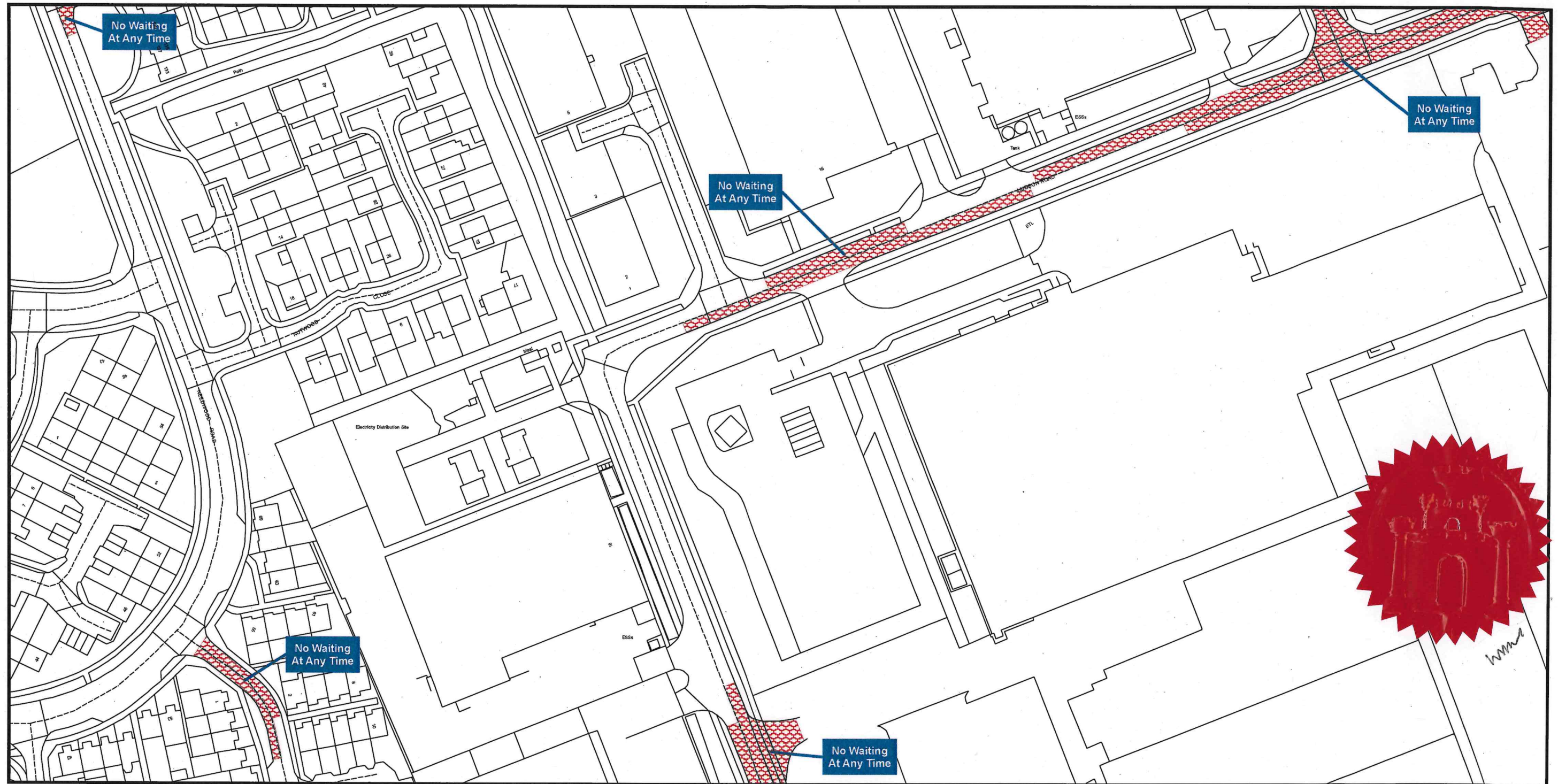

**Bedford Borough Council (Bedford Urban Area (North of the
River excluding Queens Park and CPZ areas)) (Prohibition
and Restriction of Waiting and Loading and Parking Places)
Order 2009**

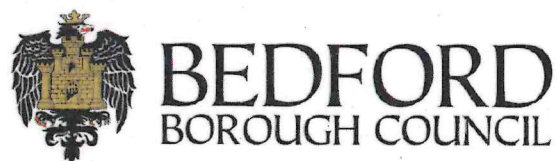

Bedford Borough Council
Borough Hall
Cauldwell Street
Bedford MK42 9AP

Reproduced from the Ordnance Survey map with the permission of Her Majesty's Stationary Office © Crown Copyright Licence
No. AC0000806481 2024. Unauthorised reproduction infringes Crown Copyright and may lead to prosecution or civil proceedings.

Scale - 1:1,250



Grid Ref: Q 22

Revision No: 4
Date: 29/07/2024

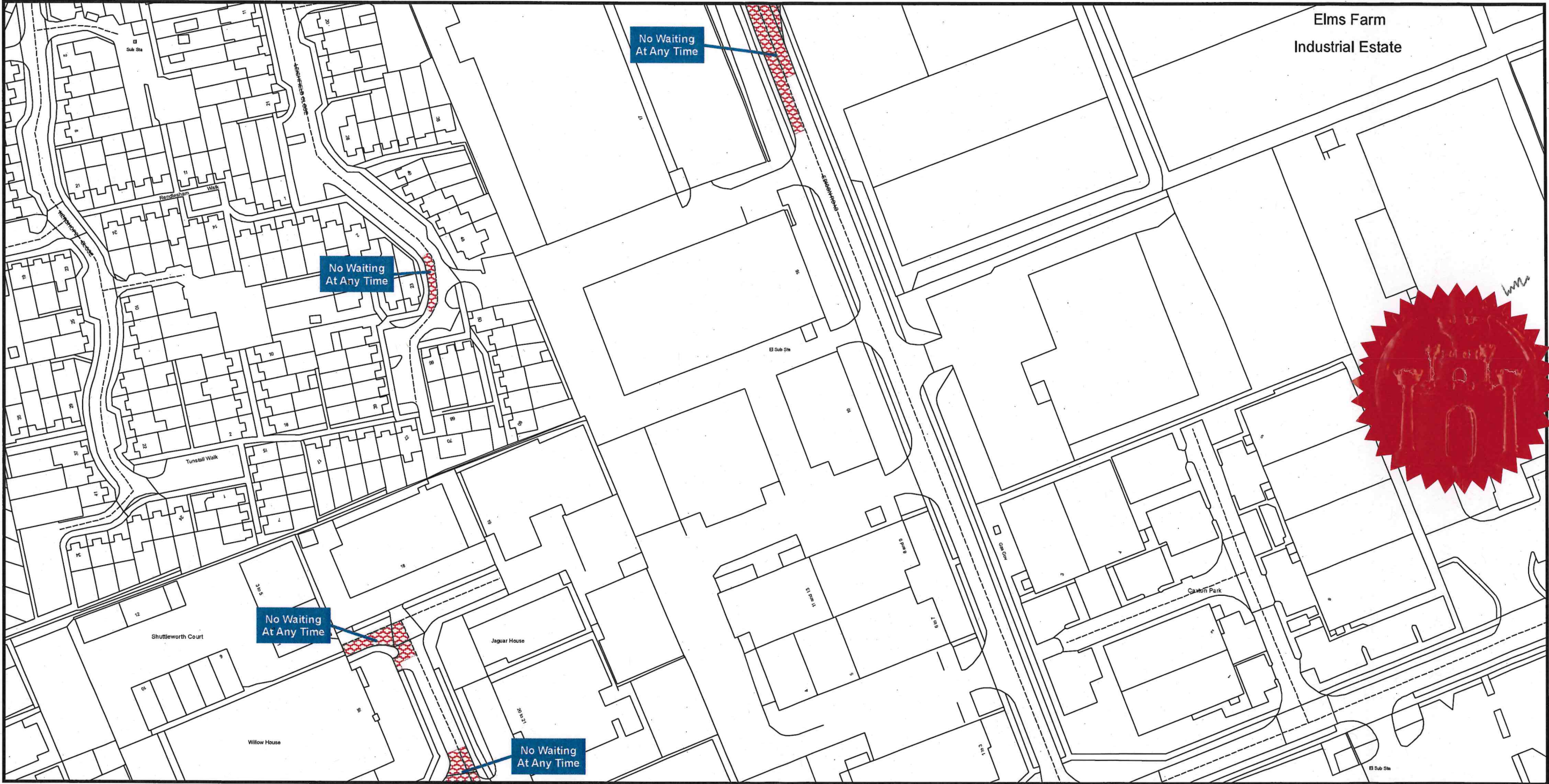

Bedford Borough Council (Bedford Urban Area (North of the River excluding Queens Park and CPZ areas)) (Prohibition and Restriction of Waiting and Loading and Parking Places) Order 2009

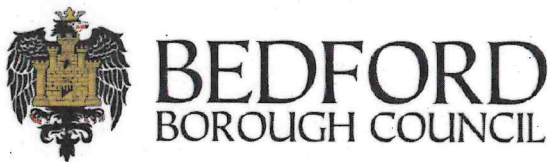

Bedford Borough Council
Borough Hall
Cauldwell Street
Bedford MK42 9AP

Reproduced from the Ordnance Survey map with the permission of Her Majesty's Stationary Office © Crown Copyright Licence No. AC0000806481 2024. Unauthorised reproduction infringes Crown Copyright and may lead to prosecution or civil proceedings.

Scale - 1:1,250



Grid Ref: Q 20

Revision No: 4
Date: 29/07/2024



Bedford Borough Council (Bedford Urban Area (North of the River excluding Queens Park and CPZ areas)) (Prohibition and Restriction of Waiting and Loading and Parking Places) Order 2009



Bedford Borough Council
Borough Hall
Cauldwell Street
Bedford MK42 9AP

Reproduced from the Ordnance Survey map with the permission of Her Majesty's Stationary Office © Crown Copyright Licence No. AC0000806481 2024. Unauthorised reproduction infringes Crown Copyright and may lead to prosecution or civil proceedings.

Scale - 1:1,250

