



PUBLIC NOTICE

BEDFORD BOROUGH COUNCIL PROPOSE TO AMEND SOME PARKING RESTRICTIONS IN IDDESLEIGH ROAD, MARLBOROUGH ROAD AND WESTBOURNE ROAD, BEDFORD

Reason for Proposals:

Bedford Borough Council propose to introduce some electric vehicle recharging points and bays in Iddesleigh Road, Bedford to help encourage the use of electric vehicles instead of conventionally-fuelled vehicles. This is also intended to help cut emissions, promote sustainable transport and improve local air quality, as electric vehicles have zero tailpipe emissions.

A time-limited "Loading only" bay is proposed for Iddesleigh Road near to some business premises to assist with the loading and unloading of goods.

It is also proposed to revoke some parking restrictions in Iddesleigh Road and Marlborough Road, Bedford to create some additional parking areas, thus increasing the on-street parking capacity.

As well as the above, there is a proposal to extend some parking restrictions by 10 metres outside All Saints Church in Westbourne Road. This is intended to help improve safety for visitors to the church and pedestrians in general by keeping that area clear of parked vehicles.

Effect of the Order:

- 1. To introduce two "Electric vehicle recharging point only" bays at the following location and subject to the following restrictions:**

Road:	Iddesleigh Road, Bedford
Location:	On its southern kerb, extending from a point approx. 8 metres east of Westbourne Road for a distance of approx. 10 metres in an easterly direction.
Restrictions:	At all times: Only electric vehicles that are recharging will be permitted to park in these bays. 8 am - 6 pm: Maximum stay 4 hours, no return within 1 hour. 6 pm - 8 am: No time restrictions.

- 2. To revoke part of a single yellow line restriction (No waiting Mon - Sat, 8 am - 6.30 pm) and to mark a "Loading only" bay in its place at the following location and subject to the following restrictions:**

Road:	Iddesleigh Road, Bedford
Location:	On its northern kerb, extending from the projected common boundary of property numbers 51 and 49 Iddesleigh Road for a distance of approx. 7.3 metres in a westerly direction.
Restrictions:	8 am - 6.30 pm: Loading only, maximum stay 15 minutes, no return within 1 hour. 6.30 pm - 8 am: No restrictions.

3. To revoke a single yellow line restriction (No waiting Mon - Sat, 8 am - 6.30 pm) and to mark a parking area in its place at the following location and subject to the following restrictions:

Road:	Iddesleigh Road, Bedford
Location:	On its northern kerb, extending from a point approx. 11 metres east of Westbourne Road for a distance of approx. 36 metres in an easterly direction.
Restrictions:	8 am - 6.30 pm: Maximum stay 2 hours, no return within 1 hour. 6.30 pm - 8 am: No restrictions. This parking area will be partially marked on the footway to help maximise the remaining carriageway width for traffic.

4. To revoke a double yellow line restriction (No waiting at any time) and to mark a parking area in its place at the following location:

Road:	Marlborough Road, Bedford
Location:	On its eastern kerb, extending from a point approx. 3.4 north of the centre of Westbourne Road for a distance of approx. 16 metres in a northerly direction. This parking area will be partially marked on the footway to help maximise the remaining carriageway width for traffic.

5. To extend existing “No waiting at any time” and “No loading at any time” restrictions on the following length of road:

A	Westbourne Road, Bedford
(i)	On its eastern kerb, extending from a point approx. 13 metres north of the centre of Iddesleigh Road for a distance of approx. 10 metres in a northerly direction.

Relevant proposal documents may be examined during normal office hours at Borough Hall, Cauldwell Street, Bedford, MK42 9AP. They will also be available for viewing on the council’s website at www.bedford.gov.uk/proposedtro. The documents will be placed on deposit until 6 weeks after the Order is made or until it is decided not to continue with the proposal. For further information, please contact Andrew Prigmore at Bedford Borough Council on 01234 276691.

Comments supporting or objecting to the proposal should be put in an email, stating the grounds on which they are made, and sent no later than 6th July 2023 to highway.consultations@bedford.gov.uk.

Order Title if made will be:

1. Bedford Borough Council (Bedford Urban Area (South of the River and Queens Park)) (Prohibition and Restriction of Waiting and Loading and Parking Places) Order 2009 (Amendment No.***) Order 20**.

Dated: 8th June 2023

Borough Hall, Cauldwell Street
Bedford, MK42 9AP

Craig Austin
Director of Environment



BEDFORD BOROUGH COUNCIL
(BEDFORD URBAN AREA (SOUTH OF THE RIVER AND QUEENS PARK))
(PROHIBITION AND RESTRICTION OF WAITING AND LOADING
AND PARKING PLACES) ORDER 2009
(AMENDMENT NO.53) ORDER 2023

BEDFORD BOROUGH COUNCIL (“the Council”) in exercise of the powers conferred by Sections 1(1), 2(1) to (3) and 4(2) of, and Part IV of Schedule 9 to, the Road Traffic Regulation Act 1984 as amended (“the Act”) and of all other powers enabling them in that behalf, and after consultation with the Chief Officer of Police in accordance with Part III of Schedule 9 to the Act, hereby make the following Order:-

1. This Order may be cited as the “Bedford Borough Council (Bedford Urban Area (South of the River and Queens Park)) (Prohibition and Restriction of Waiting and Loading and Parking Places) Order 2009 (Amendment No.53) Order 2023” and shall come into force on 31st July 2023.

2. As from the date upon which this Order comes into force the provisions of the Bedford Borough Council (Bedford Urban Area (South of the River and Queens Park)) (Prohibition and Restriction of Waiting and Loading and Parking Places) Order 2009 as amended shall be varied as follows:
 - (i) The plan schedule reference “Grid Ref: H 28 Revision No: 9” shall be deleted and the plan schedule reference “Grid Ref: H 28 Revision No: 10” shall be inserted.

 - (ii) The plan schedule reference “Grid Ref: H 29 Revision No: 5” shall be deleted and the plan schedule reference “Grid Ref: H 29 Revision No: 6” shall be inserted

3. This Amendment shall be read and construed as one with the Bedford Borough Council (Bedford Urban Area (South of the River and Queens Park)) (Prohibition and Restriction of Waiting and Loading and Parking Places) Order 2009 as amended.

**THE COMMON SEAL of the
BEDFORD BOROUGH COUNCIL**

was hereunto affixed this
27th day of July 2023
in the presence of:



**Wai K. Tsang
Solicitor
Legal Services
Bedford Borough Council**

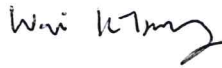

Authorised Signatory

AUTHORITY FOR EXECUTION		
COUNCIL/COMMITTEE	MINUTE No.	DATE
DELEGATED POWER	By whom executed ENVIRONMENT	26/07/2023
	OFFICERS INITIALS	DATE
ORIGINATED AND CHECKED BY	GM	26/07/2023
APPROVED BY	AP	26/07/2023



BEDFORD BOROUGH COUNCIL
(BEDFORD URBAN AREA (SOUTH OF THE RIVER AND QUEENS PARK))
(PROHIBITION AND RESTRICTION OF WAITING AND LOADING
AND PARKING PLACES) ORDER 2009
(AMENDMENT NO.53) ORDER 2023

STATEMENT OF REASONS

Bedford Borough Council propose to introduce some electric vehicle recharging points and bays in Iddesleigh Road, Bedford to help encourage the use of electric vehicles instead of conventionally-fuelled vehicles. This is also intended to help cut emissions, promote sustainable transport and improve local air quality, as electric vehicles have zero tailpipe emissions.

A time-limited “Loading only” bay is proposed for Iddesleigh Road near to some business premises to assist with the loading and unloading of goods.

It is also proposed to revoke some parking restrictions in Iddesleigh Road and Marlborough Road, Bedford to create some additional parking areas, thus increasing the on-street parking capacity.

As well as the above, there is a proposal to extend some parking restrictions by 10 metres outside All Saints Church in Westbourne Road. This is intended to help improve safety for visitors to the church and pedestrians in general by keeping that area clear of parked vehicles.

- KEY:**
- TP Existing telegraph pole
 - LC Existing lamp column
 - NSP New 89mm diameter sign post
 - ESP Existing sign post

- □ New dual electric vehicle charging point
 - S1 Sign number
1. All dimensions to be site measured. No scaling is to be carried out from this drawing.
 2. All works to be carried out to the Specification for Highway Works.
 3. Diagram numbers shown refer to The Traffic Signs Regulations and General Directions 2016. All signs and road markings to be designed in accordance with that document unless stated otherwise.
 4. Sign positions and markings to be agreed with Engineer or Clerk of Works on site.

25/07/2023	TRO	1	GM
28/10/2021	First Issue	0	GM
DATE	AMENDMENTS	REV	BY



Traffic Management
 BOROUGH HALL, CAULDWELL ST, BEDFORD, MK42 9AP
 Tel. (01234) 267422

CLIENT
Environment

SCHEME
Iddesleigh Road, Bedford

DRAWING TITLE
EV Charging Bays

TRO			
SCALE @ A3 NTS	DATE 23/08/2022	DRAWN GM	CHECKED AP

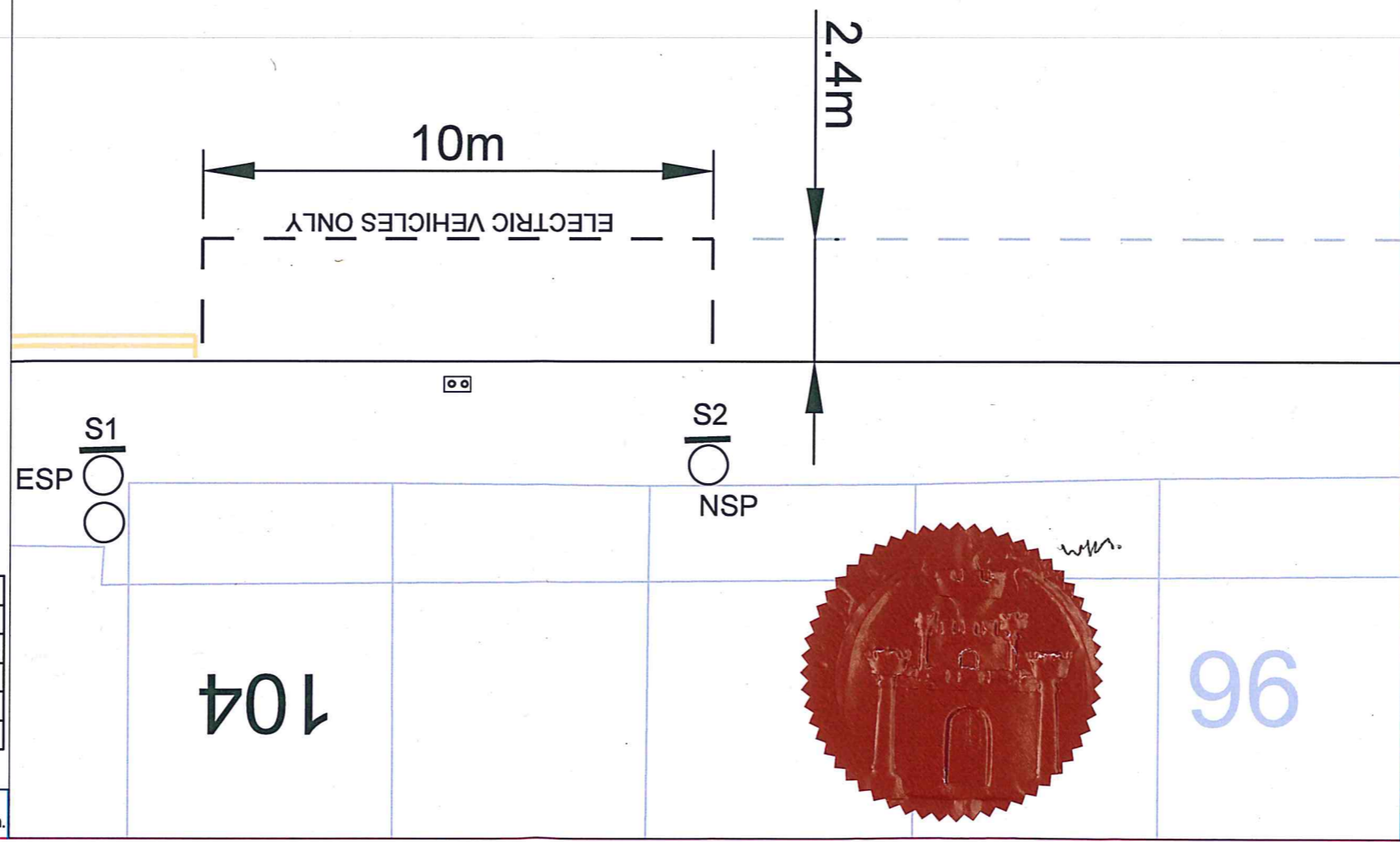
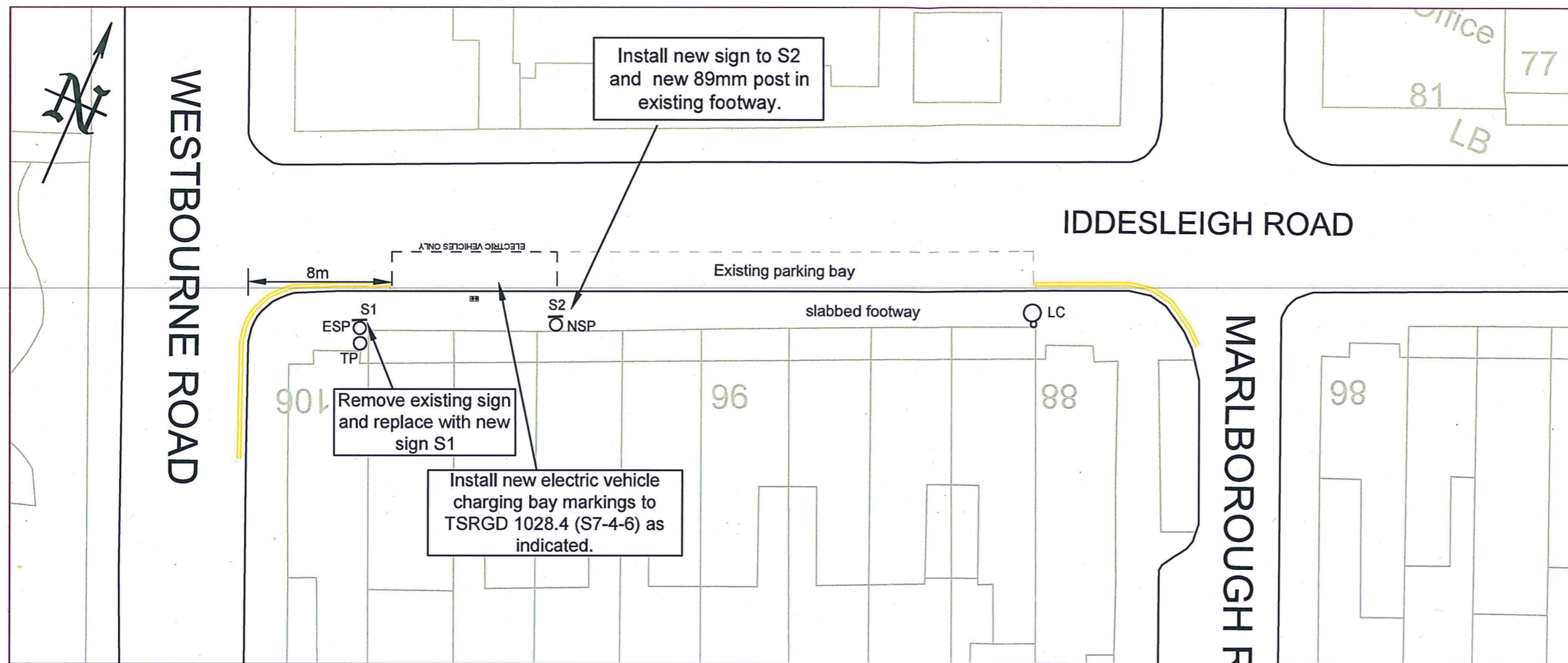

Scheme Ref. IDDESLEIGH ROAD SIGN S1	
Sign Ref. 660.9V	x-height 20.0
Letter colour BLACK	SIGN FACE
Background WHITE	Width 375 mm
Border BLACK	Height 460 mm
Material Class R3B-UK	Area 0.17 m ²

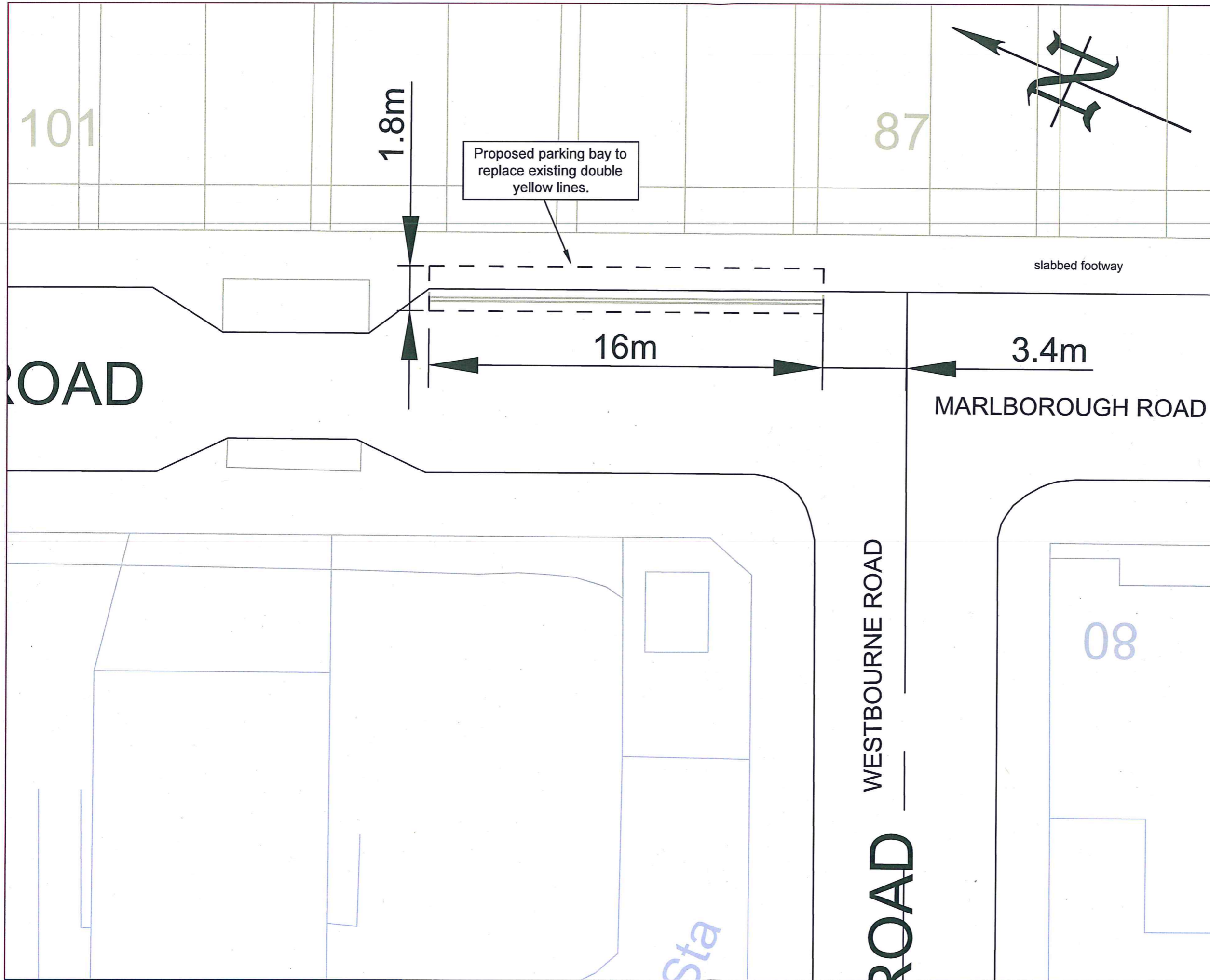

KEY:

- Existing double yellow lines to be removed
- Proposed parking bay markings

NOTES

Proposed parking bay markings:-
 50mm wide single white lines -
 600mm long line, 600mm gap, to
 Diagram 1028.4 of the Traffic Signs
 Regulations and General Directions
 2016.
 Parking bay to be marked 50% on
 carriageway, 50% on footway.



25/07/2023	TRO	2	GM
11/08/2022	Second Issue	1	GM
08/02/2022	First Issue	0	GM
DATE	AMENDMENTS	REV	BY



Traffic Management
 BOROUGH HALL, CAULDWELL ST, BEDFORD, MK42 9AP
 Tel. (01234) 267422

CLIENT
Environment

SCHEME
**Ward Fund Transport projects
 Marlborough Road, Bedford**

DRAWING TITLE
**Replacement of existing
 waiting restriction**

DRG STATUS
TRO

SCALE @ A3	DATE	DRAWN	CHECKED
NTS	08/02/2022	GM	AP

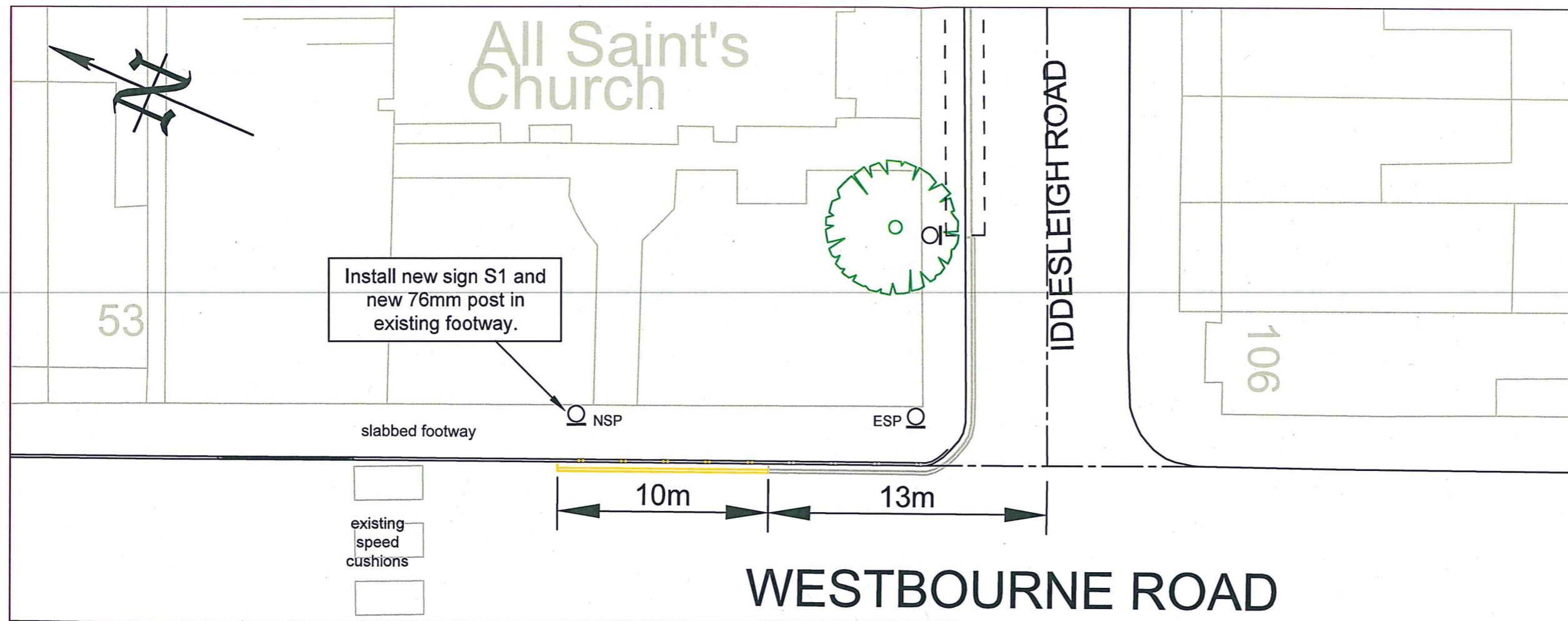

- KEY:**
- Existing double yellow lines
 - Existing 'No loading at any time' marks
 - New double yellow lines
 - New 'No loading at any time' marks
 - Existing 'No loading at any time' sign & post
 - New sign post & sign

NOTES
 75mm wide double yellow lines to Diagram 1018.1 of the Traffic Signs Regulations and General Directions 2016.
 Extend double yellow lines, 10m length, on the north-eastern side of Westbourne Road. Re-paint existing 'No loading at any time' marks, extend marks at 2m intervals, to Diagram 1020.1 (to match existing) for the extent of the double yellow lines extension. No loading sign in accordance with the Traffic Signs Regulations and General Directions 2016. New sign to be fixed to new 76mm galvanised steel post, min. height above ground 2.3m, oriented to face the carriageway. Post to protrude no higher than top edge of sign. Re-instate footway.

25/07/2023	TRO	2	GM
11/08/2022	Second Issue	1	GM
04/02/2022	First Issue	0	GM
DATE	AMENDMENTS	REV	BY



Traffic Management
 BOROUGH HALL, CAULDWELL ST, BEDFORD, MK42 9AP
 Tel. (01234) 267422

CLIENT
 Environment

SCHEME
 Ward Fund Transport projects
 Westbourne Road, Bedford

DRAWING TITLE
 Extension to existing 'No waiting'
 & 'No loading' restriction

DRG STATUS			
TRO			
SCALE @ A3	DATE	DRAWN	CHECKED
NTS	04/02/2022	GM	AP

WESTBOURNE ROAD



S1 x 1

Scheme Ref.	Westbourne Road		
Sign Ref.	No loading sign S1	x-height	20.0
Letter colour	BLACK	SIGN FACE	
Background	WHITE	Width	255 mm
Border	BLACK	Height	115 mm
Material	Class R3B-UK	Area	0.03 m ²



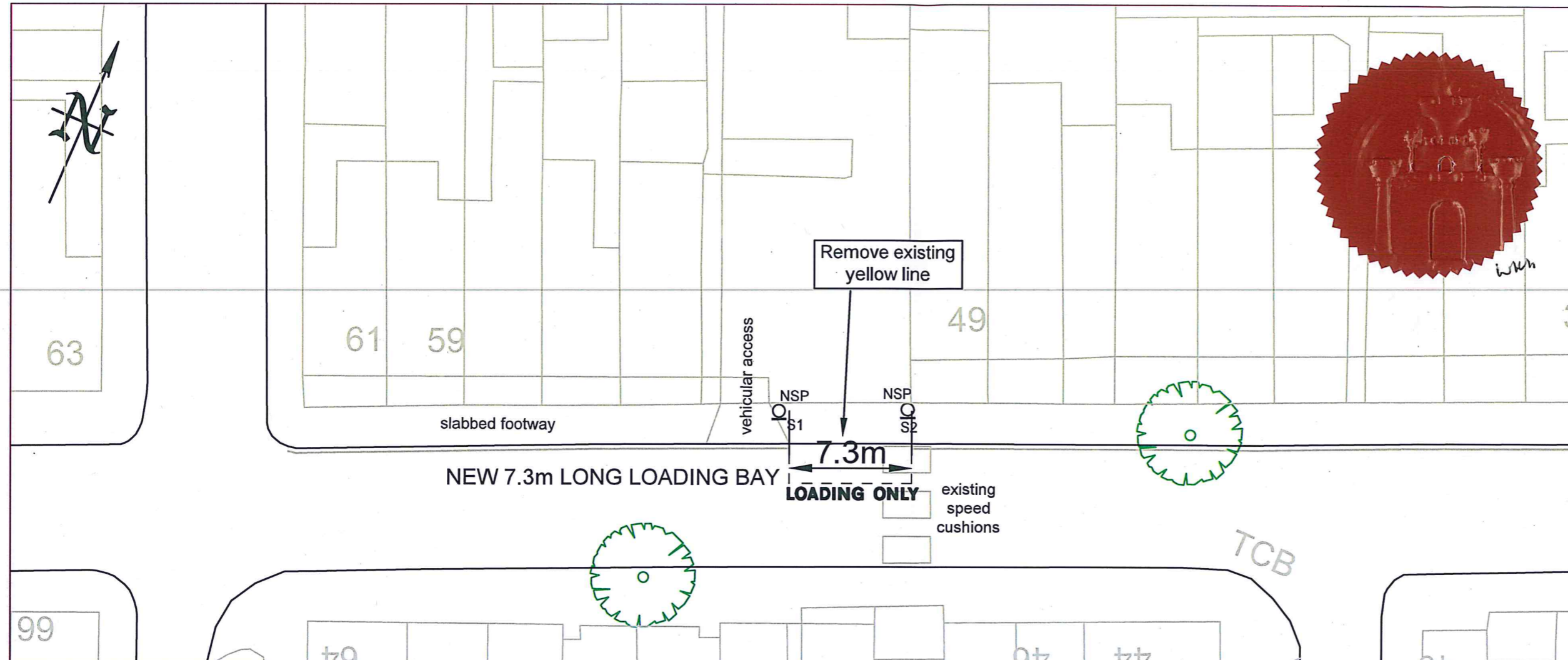

KEY:

- Existing single yellow line - No waiting Mon - Sat 8am - 6.30pm
- New 76mm diameter sign post
- S1** Sign number

NOTES

Remove yellow line within proposed loading bay, all other yellow lines to remain.
Proposed new signs and loading bay markings (to Diagram 1028.4) in accordance with the Traffic Signs Regulations and General Directions 2016.

SIGN SCHEDULE:

2 no. signs on new posts to be erected at a minimum height of 2.3m from ground level, and positioned clear of windows and doors.

POST SCHEDULE:

76mm galvanised steel posts with associated end caps. Posts to be cut to length (if necessary on site). Ensure posts protrudes no higher than the top edge of the traffic sign.

DATE	AMENDMENTS	REV	BY
25/07/2023	TRO	3	GM
05/05/2022	Third Issue	2	GM
05/05/2022	Second Issue	1	GM
12/01/2022	First Issue	0	GM



Traffic Management
BOROUGH HALL, CAULDWELL ST, BEDFORD, MK42 9AP
Tel. (01234) 267422

CLIENT
Environment

SCHEME
51 Iddesleigh Road, Bedford

DRAWING TITLE
New Loading Bay and amended Waiting Restriction

DRG STATUS
TRO

SCALE @ A3	DATE	DRAWN	CHECKED
NTS	12/01/2022	GM	AP

Mon - Sat
8 am - 6.30 pm

Loading only
8 am - 6.30 pm
15 mins
No return within 1 hour

Loading only
8 am - 6.30 pm
15 mins
No return within 1 hour

Mon - Sat
8 am - 6.30 pm

Scheme Ref. 51 Iddesleigh Road, Bedford			
Sign Ref.	No waiting & Loading sign S1	x-height	20.0
Letter colour	BLACK	SIGN FACE	
Background	YELLOW	Width	650 mm
Border	BLACK	Height	340 mm
Material	Class R3B-UK	Area	0.22 m ²

Scheme Ref. 51 Iddesleigh Road, Bedford			
Sign Ref.	No waiting & Loading sign S2	x-height	20.0
Letter colour	BLACK	SIGN FACE	
Background	YELLOW	Width	655 mm
Border	BLACK	Height	340 mm
Material	Class R3B-UK	Area	0.22 m ²

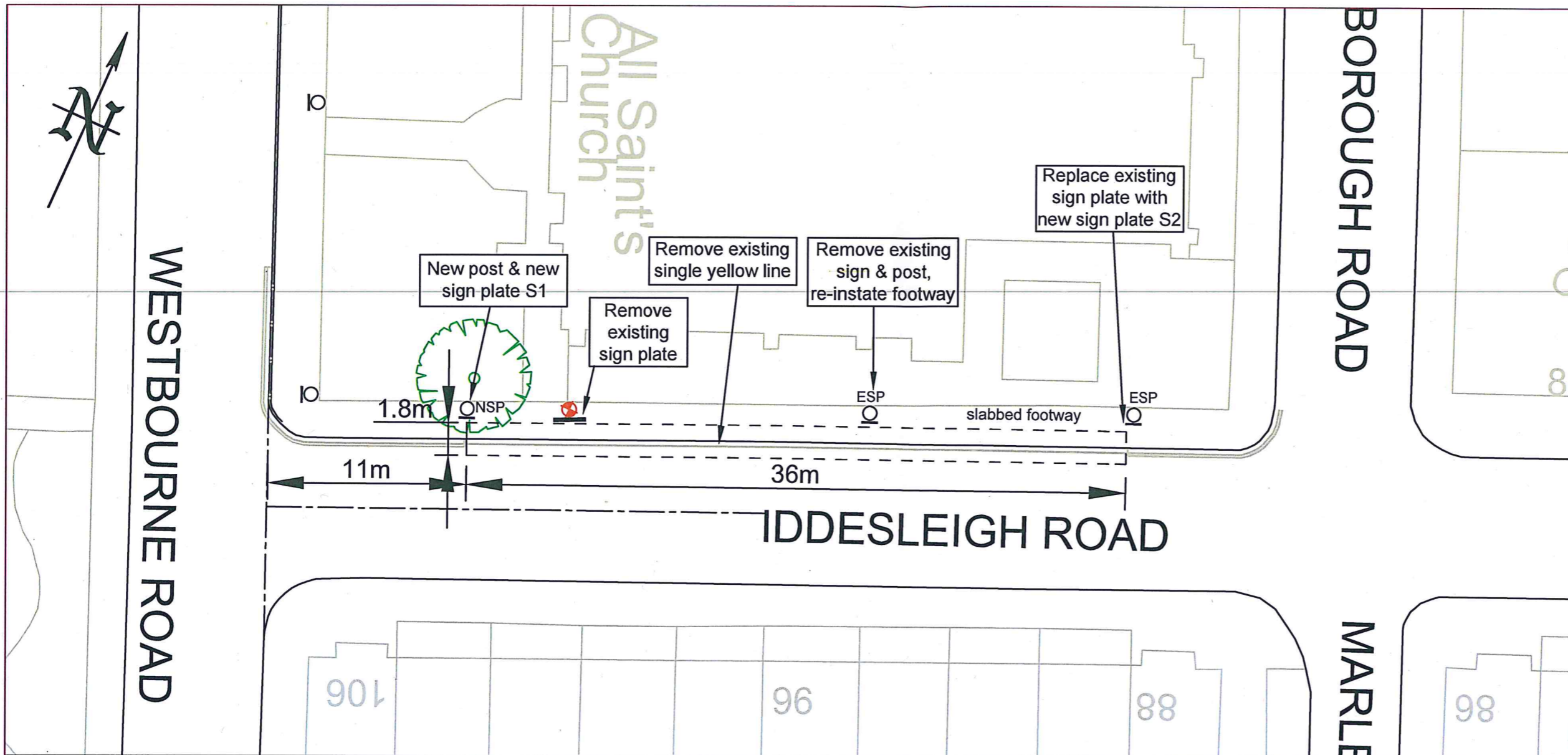

- KEY:**
- Existing double yellow lines
 - Proposed parking bay markings
 - Existing lamp column
 - Existing 'No loading at any time' sign & post
 - New No loading / Parking sign S1 & 76mm diameter galvanised steel post

NOTES
 Proposed parking bay markings:-
 50mm wide single white lines -
 600mm long line, 600mm gap, to
 Diagram 1028.4 of the Traffic Signs
 Regulations and General Directions
 2016.
 1.8m wide parking bay to be marked
 50% on carriageway, 50% on
 footway.
 Remove existing signs from post and
 lamp column, and replace with new
 signs where shown, signs oriented to
 face the carriageway.
 Fix new sign S1 to new 76mm
 diameter galvanised steel post (with
 end cap), 3.67m long, 1.0m deep
 foundation. Sign mounted 2.3m
 above ground, orientated to face the
 carriageway.
 Re-instate footway.

25/07/2023	TRO	2	GM
12/08/2022	Second Issue	1	GM
20/05/2022	First Issue	0	GM
DATE	AMENDMENTS	REV	BY



Traffic Management
 BOROUGH HALL, CAULDWELL ST, BEDFORD, MK42 9AP
 Tel. (01234) 267422

CLIENT
 Environment

SCHEME
 Ward Fund Transport projects
 Iddesleigh Road, Bedford

DRAWING TITLE
 Replacement of existing waiting
 & loading restriction

DRG STATUS
TRO

SCALE @ A3	DATE	DRAWN	CHECKED
NTS	20/05/2022	GM	AP

No loading at any time

8 am - 6.30 pm
2 hours
No return within 1 hour

S1 x 1

8 am - 6.30 pm
2 hours
No return within 1 hour

No loading at any time

S2 x 1

Scheme Ref.	Iddesleigh Road, Bedford		
Sign Ref.	Parking bay sign S1	x-height	20.0
Letter colour	BLACK	SIGN FACE	
Background	YELLOW	Width	570 mm
Border	BLACK	Height	365 mm
Material	Class R3B-UK	Area	0.21 m ²

Scheme Ref.	Iddesleigh Road, Bedford		
Sign Ref.	Parking bay sign S2	x-height	20.0
Letter colour	BLACK	SIGN FACE	
Background	WHITE	Width	570 mm
Border	BLACK	Height	370 mm
Material	Class R3B-UK	Area	0.21 m ²

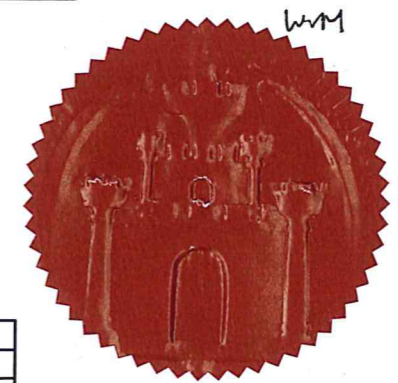

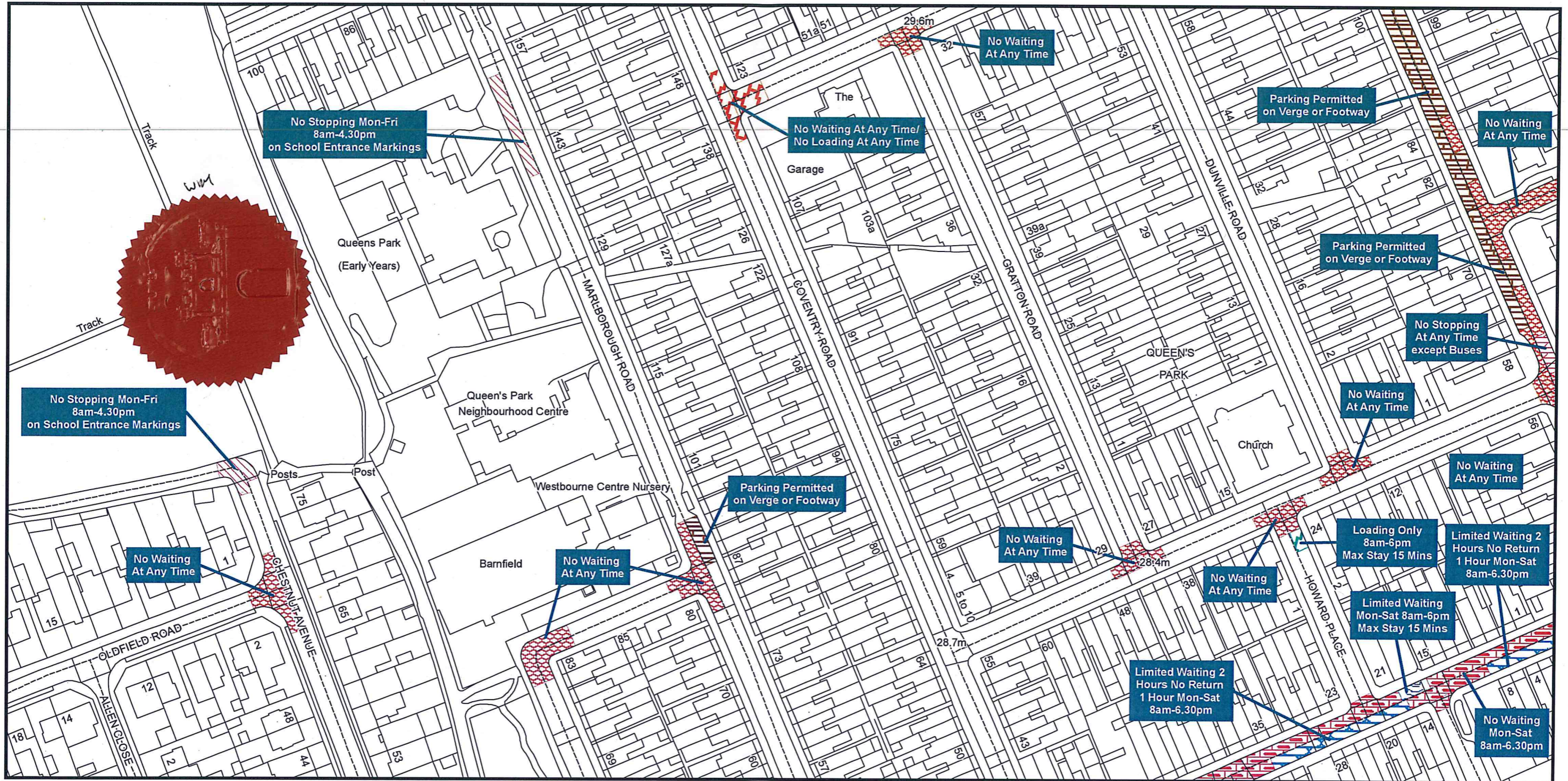

Bedford Borough Council (Bedford Urban Area (South of the River and Queens Park)) (Prohibition and Restriction of Waiting and Loading and Parking Places) Order 2009

Bedford Borough Council
Borough Hall
Cauldwell Street
Bedford MK42 9AP



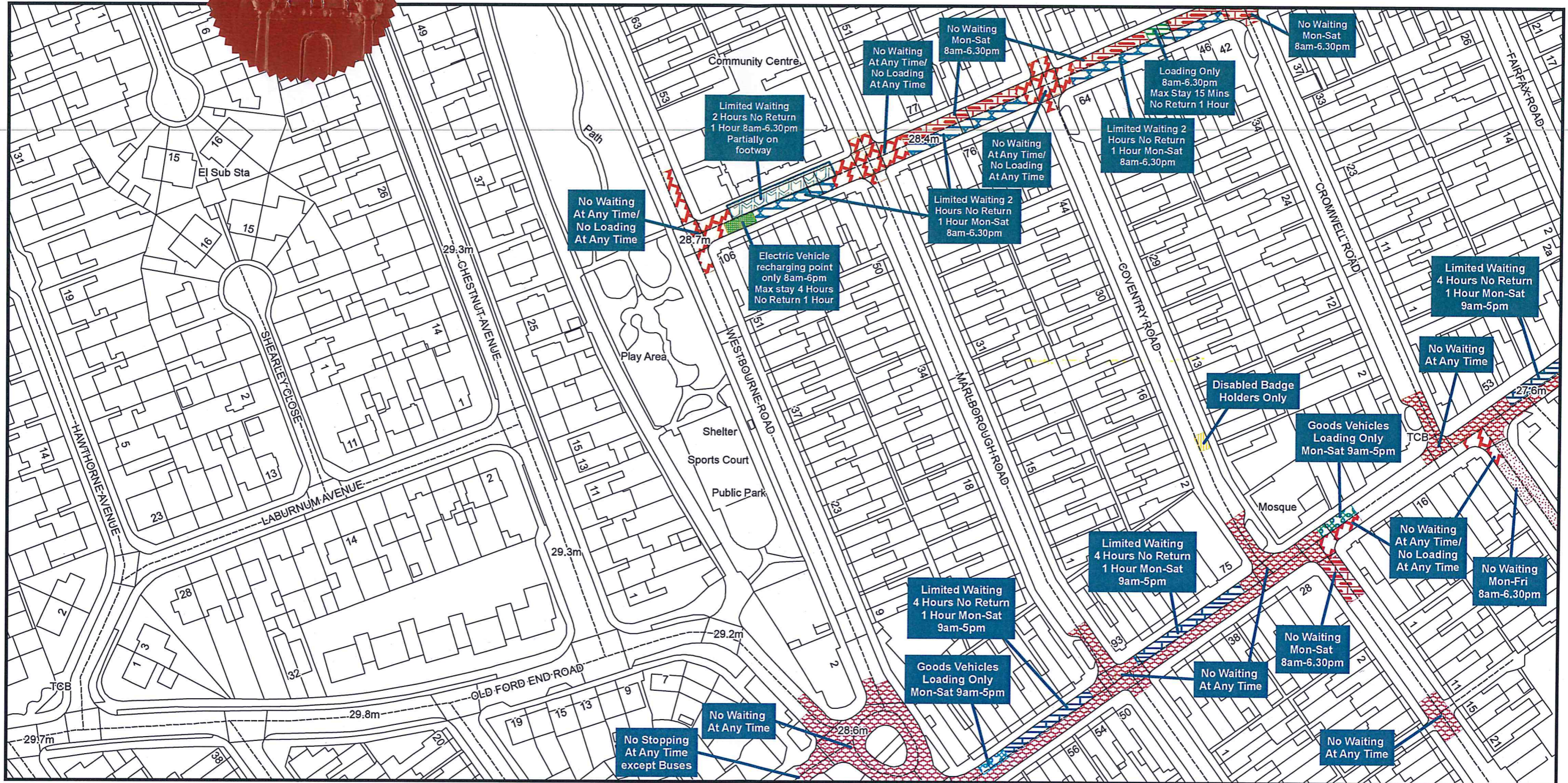
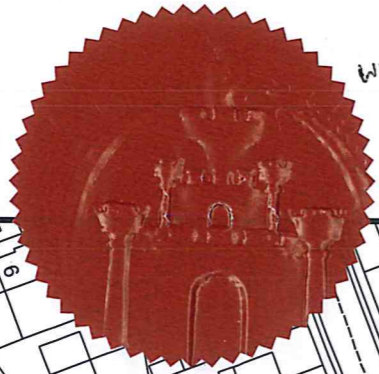

Bedford Borough Council (Bedford Urban Area (South of the River and Queens Park)) (Prohibition and Restriction of Waiting and Loading and Parking Places) Order 2009

Bedford Borough Council
Borough Hall
Cauldwell Street
Bedford MK42 9AP

