



PUBLIC NOTICE

BEDFORD BOROUGH COUNCIL PROPOSE TO INTRODUCE AND FORMALISE SOME PARKING RESTRICTIONS AND PARKING AREAS IN COLLEGE STREET AND NEWNORTH COURT, KEMPSTON

Reason for Proposal:

Concerns have been raised over inconsiderate parking in College Street, Kempston which is affecting access and egress for businesses located along the road, and also safety.

To help alleviate these issues, Bedford Borough Council propose to introduce some parking restrictions and restricted parking bays in College Street, and also to formalise some parking restrictions in Newnorth Court, Kempston.

Effect of the Order:

1. To revoke a section of 'No waiting Mon-Sat 7am-7pm' restriction (single yellow line) on the following length of road:

A	College Street, Kempston
(i)	On its southern and eastern kerb, extending from a point approx. 17 metres east of the centre of Newnorth Court for a distance of approx. 69 metres in an easterly and then northerly direction.

2. To introduce 'No waiting at any time' restrictions (double yellow lines) on the following lengths of roads:

A	College Street, Kempston
(i)	Starting on its southern kerb at the projected easternmost boundary of property number 8 Newnorth Court and extending in an anti-clockwise direction along the kerblines of College Street in an easterly, northerly, westerly and then southerly direction to a point on its western kerb approx. 32.4 metres south of the northernmost point of the road.
(ii)	On its western kerb, extending from a point approx. 57.4 metres south of the northernmost point of the road for a distance of approx. 13 metres in a southerly direction.
(iii)	On its western kerb, extending from a point approx. 75.9 metres south of the northernmost point of the road for a distance of approx. 44.5 metres in a southerly direction.
(iv)	On its western kerb, extending from a point approx. 136.4 metres south of the northernmost point of the road for a distance of approx. 11.6 metres in a southerly direction.
(v)	On its western kerb, extending from a point approx. 180 metres south of the northernmost point of the road for a distance of approx. 21.4 metres in a southerly direction.
(vi)	On its western kerb, extending from a point approx. 214.4 metres south of the northernmost point of the road for a distance of approx. 7.4 metres in a southerly direction.
(vii)	On its northern and western kerb, extending from the projected easternmost

	boundary of property number 8 Newnorth Court for a distance of approx. 107 metres in an easterly and then northerly direction.
B	Newnorth Court, Kempston
(i)	Starting on its western kerb at its junction with College Street and extending in an anti-clockwise direction along the kerblines of Newnorth Court to the projected easternmost boundary of property number 14 Newnorth Court on its southern kerb.
(ii)	Starting on its southern kerb from a point approx. 6 metres east of the projected easternmost boundary of property number 14 Newnorth Court and extending in an anti-clockwise direction along the kerblines of Newnorth Court for a distance of approx. 14.5 metres in an easterly and then northerly direction.
(iii)	Starting on its eastern kerb at its junction with College Street and extending in a clockwise direction along the kerblines of Newnorth Court for a distance of approx. 40 metres in a southerly and then easterly direction.

3. To introduce six restricted parking areas as detailed below:

A	College Street, Kempston	Hours of Operation	Restrictions
(i)	On its western kerb, extending from a point approx. 32.4 metres south of the northernmost point of the road for a distance of approx. 25 metres in a southerly direction.	6am – 9pm	No restrictions.
		9pm – 6am	Parking limited to 2 hours maximum, no return within 1 hour.
(ii)	On its western kerb, extending from a point approx. 70.4 metres south of the northernmost point of the road for a distance of approx. 5.5 metres in a southerly direction.	6am – 9pm	No restrictions.
		9pm – 6am	Parking limited to 2 hours maximum, no return within 1 hour.
(iii)	On its western kerb, extending from a point approx. 120.4 metres south of the northernmost point of the road for a distance of approx. 16 metres in a southerly direction.	6am – 9pm	No restrictions.
		9pm – 6am	Parking limited to 2 hours maximum, no return within 1 hour.
(iv)	On its western kerb, extending from a point approx. 148 metres south of the northernmost point of the road for a distance of approx. 32 metres in a southerly direction.	6am – 9pm	No restrictions.
		9pm – 6am	Parking limited to 2 hours maximum, no return within 1 hour.
(v)	On its western kerb, extending from a point approx. 201.4 metres south of the northernmost point of the road for a distance of approx. 13 metres in a southerly direction.	6am – 9pm	No restrictions.
		9pm – 6am	Parking limited to 2 hours maximum, no return within 1 hour.
(vi)	On its western kerb, extending from a point approx. 221.8 metres south of the northernmost point of the road	6am – 9pm	No restrictions.

	for a distance of approx. 5.7 metres in a southerly direction.	9pm – 6am	Parking limited to 2 hours maximum, no return within 1 hour.
--	--	-----------	--

Relevant proposal documents are available for viewing on the council's website at www.bedford.gov.uk/proposedtro, and may also be examined during normal office hours at Borough Hall, Cauldwell Street, Bedford, MK42 9AP. The documents will be placed on deposit until 6 weeks after the Order is made or until it is decided not to continue with the proposal. For further information, please contact Andrew Prigmore at Bedford Borough Council on 01234 276691.

Comments supporting or objecting to the proposal should be put in an email, stating the grounds on which they are made, and sent no later than 6th July 2023 to highway.consultations@bedford.gov.uk.

Order Title if made will be:

1. Bedford Borough Council (Kempston) (Prohibition and Restriction of Waiting and Loading and Parking Places) (Consolidation) Order 2018 (Amendment No.***) Order 2023.

Dated: 8th June 2023

Borough Hall, Cauldwell Street
Bedford, MK42 9AP

Craig Austin
Director of Environment



BEDFORD
BOROUGH COUNCIL

BEDFORD BOROUGH COUNCIL

**(KEMPSTON) (PROHIBITION AND RESTRICTION OF WAITING AND LOADING
AND PARKING PLACES) (CONSOLIDATION) ORDER 2018
(AMENDMENT NO.10) ORDER 2023**

BEDFORD BOROUGH COUNCIL (“the Council”) in exercise of the powers conferred by Sections 1(1), 2(1) to (3) and 4(2) of, and Part IV of Schedule 9 to, the Road Traffic Regulation Act 1984 as amended (“the Act”) and of all other powers enabling them in that behalf, and after consultation with the Chief Officer of Police in accordance with Part III of Schedule 9 to the Act, hereby make the following Order:-

1. This Order may be cited as the “Bedford Borough Council (Kempston) (Prohibition and Restriction of Waiting and Loading and Parking Places) (Consolidation) Order 2018 (Amendment No.10) Order 2023” and shall come into force on 21st August 2023.

2. As from the date upon which this Order comes into force the provisions of the Bedford Borough Council (Kempston) (Prohibition and Restriction of Waiting and Loading and Parking Places) (Consolidation) Order 2018 as amended shall be varied as follows:
 - (i) The plan schedule reference “Grid Ref: I 33 Revision No: 1” shall be deleted and the plan schedule reference “Grid Ref: I 33 Revision No: 2” shall be inserted.

 - (ii) The plan schedule reference “Grid Ref: I 34 Revision No: 0” shall be deleted and the plan schedule reference “Grid Ref: I 34 Revision No: 1” shall be inserted.

 - (iii) The plan schedule reference “Grid Ref: I 35 Revision No: 1” shall be deleted and the plan schedule reference “Grid Ref: I 35 Revision No: 2” shall be inserted.

3. This Amendment shall be read and construed as one with the Bedford Borough Council (Kempston) (Prohibition and Restriction of Waiting and Loading and Parking Places) (Consolidation) Order 2018 as amended.

**THE COMMON SEAL of the
BEDFORD BOROUGH COUNCIL**

was hereunto affixed this
17th day of August 2023
in the presence of:



M. Facchiano
Interim Service Manager
(GPPZ)

**-Solicitor
Legal Services
Bedford Borough Council**

Authorised Signatory

AUTHORITY FOR EXECUTION		
COUNCIL/COMMITTEE	MINUTE No.	DATE
DELEGATED POWER	By whom executed ENVIRONMENT	15/08/2023
	OFFICERS INITIALS	DATE
ORIGINATED AND CHECKED BY	GM	15/08/2023
APPROVED BY	AP	15/08/2023



BEDFORD
BOROUGH COUNCIL

BEDFORD BOROUGH COUNCIL
(KEMPSTON) (PROHIBITION AND RESTRICTION OF WAITING AND LOADING
AND PARKING PLACES) (CONSOLIDATION) ORDER 2018
(AMENDMENT NO.10) ORDER 2023

STATEMENT OF REASONS

Concerns have been raised over inconsiderate parking in College Street, Kempston which is affecting access and egress for businesses located along the road, and also safety.

To help alleviate these issues, Bedford Borough Council propose to introduce some parking restrictions and restricted parking bays in College Street, and also to formalise some parking restrictions in Newnorth Court, Kempston.

NEW

PRINTS FROM THIS DRAWING ARE UNCONTROLLED UNLESS OTHERWISE STATED A3

COLLEGE STREET

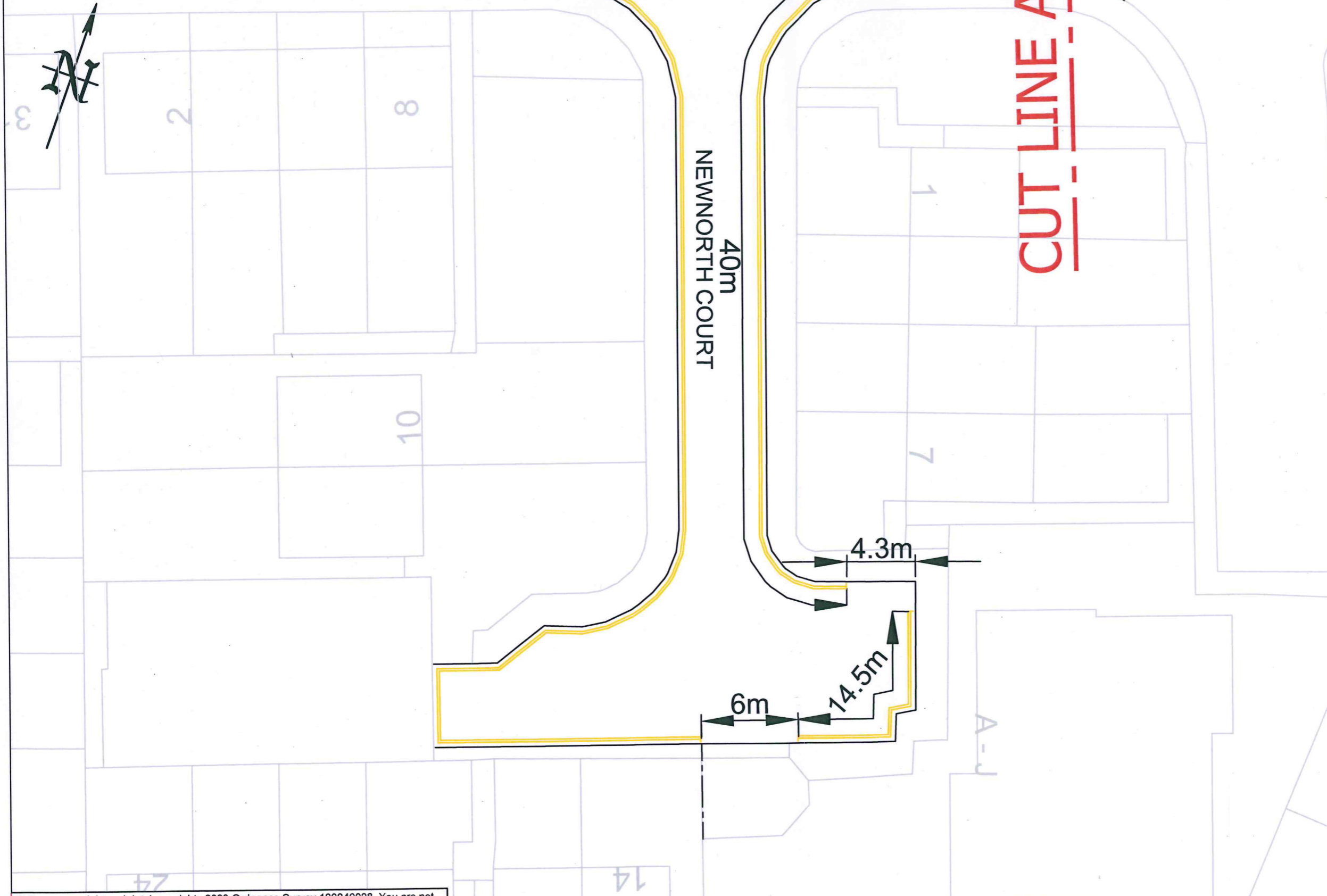

KEY:
New 75mm wide double yellow lines

NOTES
75mm wide double yellow lines to Diagram 1018.1 of the Traffic Signs Regulations and General Directions 2016.



15/08/2023	TRO	3	GM
13/04/2023	Consultation	2	GM
01/07/2022	Second Issue	1	GM
28/06/2022	First Issue	0	GM
DATE	AMENDMENTS	REV	BY



Traffic Management
BOROUGH HALL, CAULDWELL ST, BEDFORD, MK42 9AP
Tel. (01234) 267422

CLIENT
Environment

SCHEME
Newnorth Court & College Street,
Kempston

DRAWING TITLE
New Restricted Parking Areas
and "No waiting at any time"
Restrictions
(Double Yellow Lines) Sheet 1 of 3

DRG STATUS
TRO

SCALE @ A3	DATE	DRAWN	CHECKED
NTS	28/06/2022	GM	AP

EXISTING SINGLE YELLOW LINE TO BE REVOKED

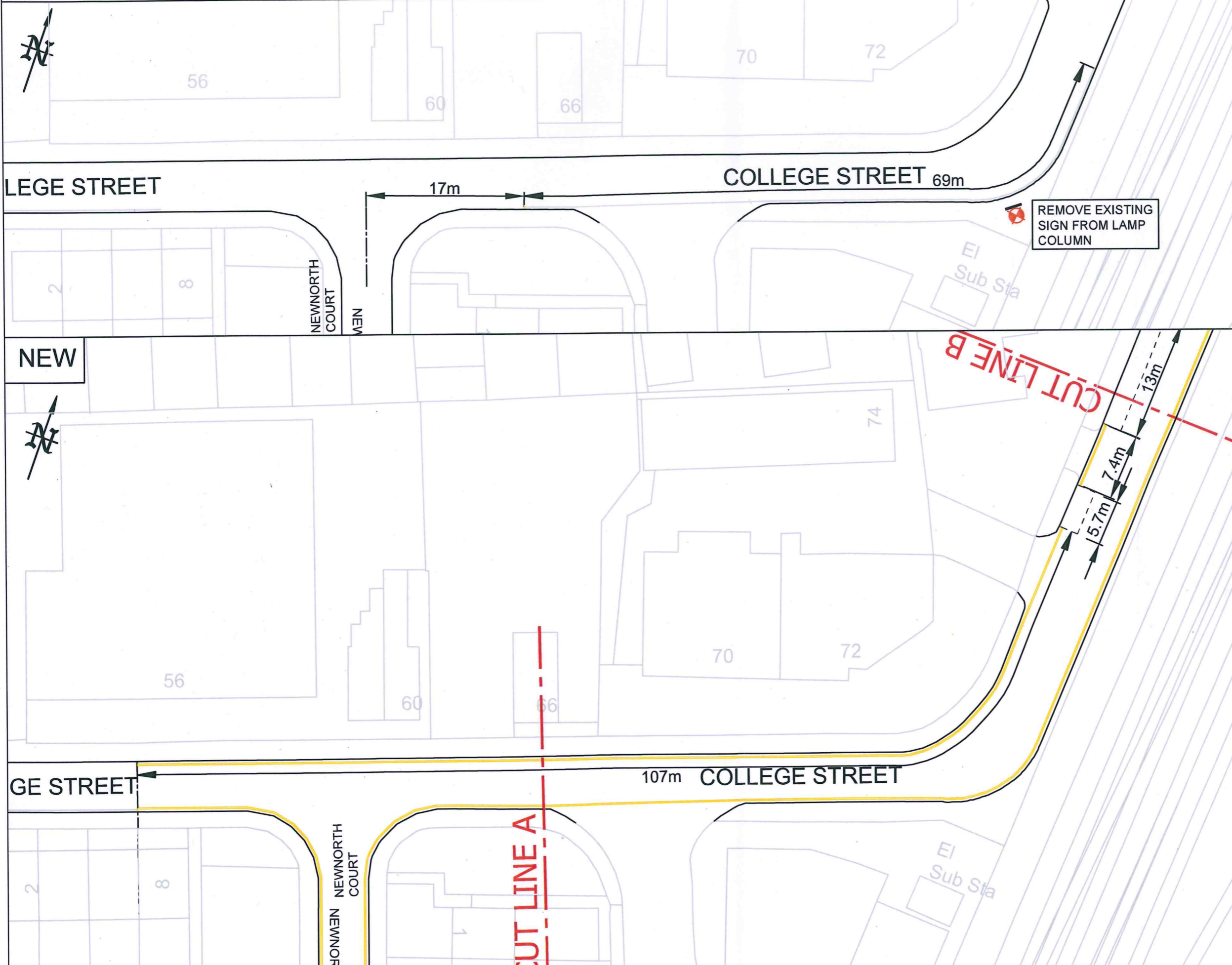

- KEY:**
- Single yellow line to be revoked
 - New 75mm wide double yellow lines
 - Proposed restricted parking area

NOTES

75mm wide double yellow lines to Diagram 1018.1, parking bay markings to Diagram 1028.4, all in accordance with the Traffic Signs Regulations and General Directions 2016.

Restricted parking areas to be 9pm to 6am, 2 hours, No return within 1 hour.

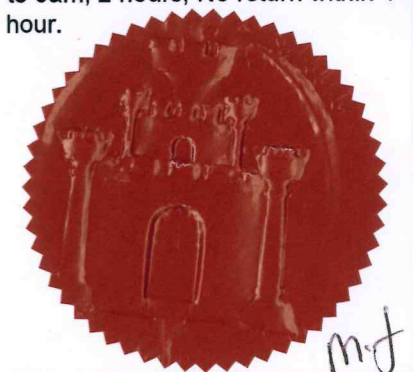

15/08/2023	TRO	3	GM
13/04/2023	Consultation	2	GM
30/06/2022	Second Issue	1	GM
29/06/2022	First Issue	0	GM
DATE	AMENDMENTS	REV	BY



Traffic Management
 BOROUGH HALL, CAULDWELL ST, BEDFORD, MK42 9AP
 Tel. (01234) 267422

CLIENT
Environment

SCHEME
 Newnorth Court & College Street,
 Kempston

DRAWING TITLE
 New Restricted Parking Areas
 and "No waiting at any time"
 Restrictions
 (Double Yellow Lines) Sheet 2 of 3

DRG STATUS
TRO

SCALE @ A3	DATE	DRAWN	CHECKED
NTS	29/06/2022	GM	AP

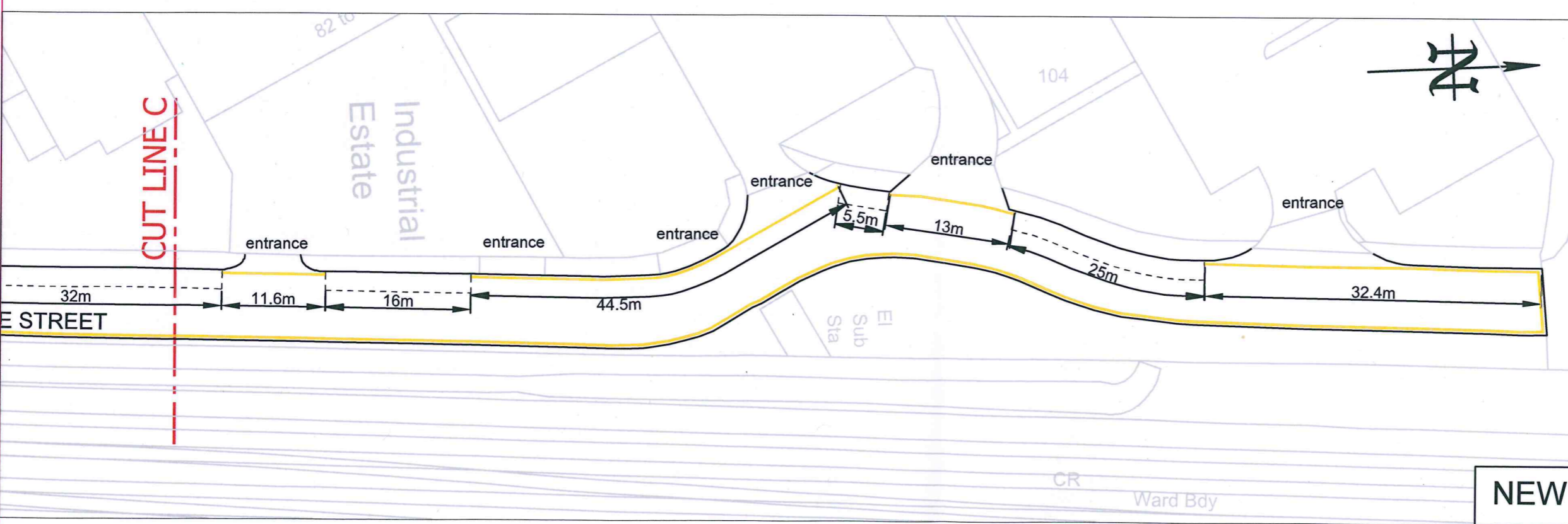
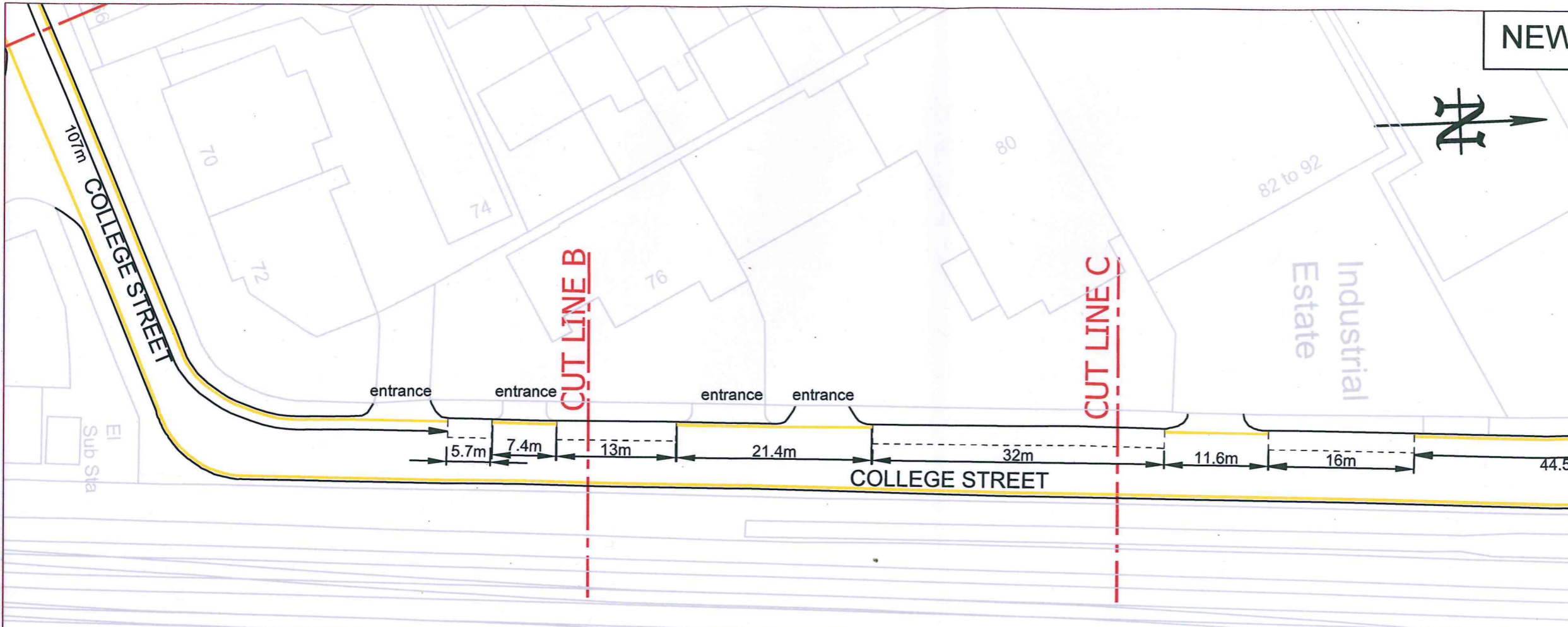

NEW

NEW

PRINTS FROM THIS DRAWING ARE UNCONTROLLED UNLESS OTHERWISE STATED A3

- KEY:**
- New 75mm wide double yellow lines
 - Proposed restricted parking area

NOTES

75mm wide double yellow lines to Diagram 1018.1, parking bay markings to Diagram 1028.4, all in accordance with the Traffic Signs Regulations and General Directions 2016.

Restricted parking areas to be 9pm to 6am, 2 hours, No return within 1 hour.

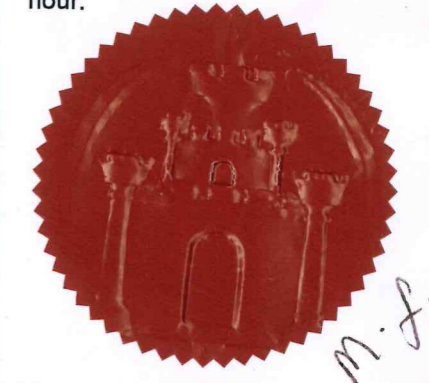

15/08/2023	TRO	6	GM
13/04/2023	Consultation		
01/07/2022	Fifth Issue		
07/06/2022	Fourth Issue		
29/04/2022	Third Issue		
22/04/2022	Second Issue	1	GM
21/04/2022	First Issue	0	GM
DATE	AMENDMENTS	REV	BY



Traffic Management
 BOROUGH HALL, CAULDWELL ST, BEDFORD, MK42 9AP
 Tel. (01234) 267422

CLIENT
Environment

SCHEME
Newnorth Court & College Street, Kempston

DRAWING TITLE
New Restricted Parking Areas and "No waiting at any time" Restrictions (Double Yellow Lines) sheet 3 of 3

SCALE @ A3	DATE	DRAWN	CHECKED
NTS	21/04/2022	GM	AP

© Crown copyright and database rights 2023 Ordnance Survey 100049028. You are not permitted to copy, sub-license, distribute or sell any of this data to third parties in any form.

Grid Ref: I 35

Revision No: 2
Date: 21/08/2023

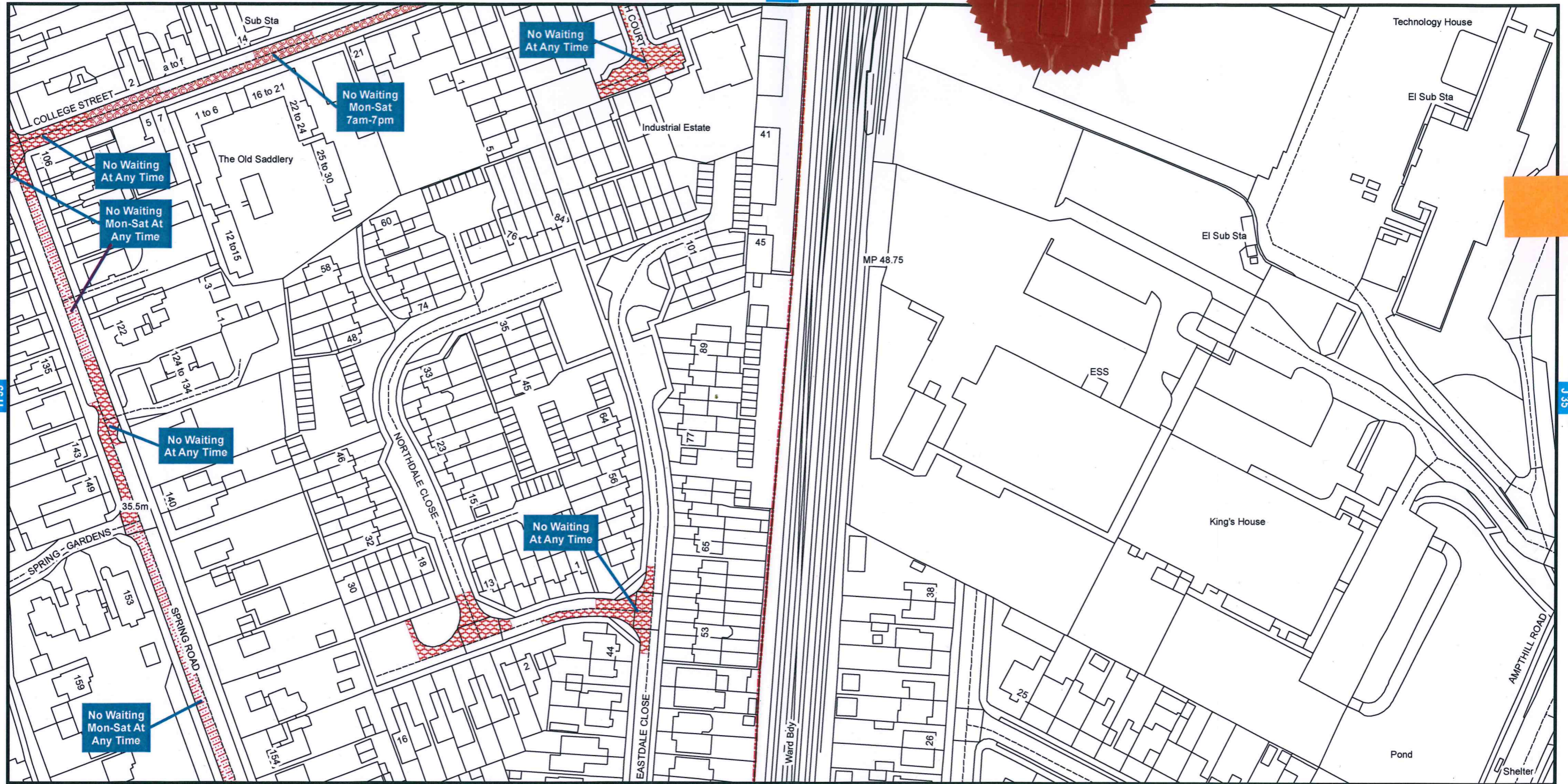

Bedford Borough Council (Kempston) (Prohibition and Restriction of Waiting and Loading and Parking Places) (Consolidation) Order 2018

**Bedford Borough Council
Borough Hall
Cauldwell Street
Bedford MK42 9AP**



Reproduced from the Ordnance Survey map with the permission of Her Majesty's Stationary Office © Crown Copyright Licence No. LA077127 (2022). Unauthorised reproduction infringes Crown Copyright and may lead to prosecution or civil proceedings.

Scale - 1:1,250 @ A3



Grid Ref: I 34

Revision No: 1
Date: 21/08/2023

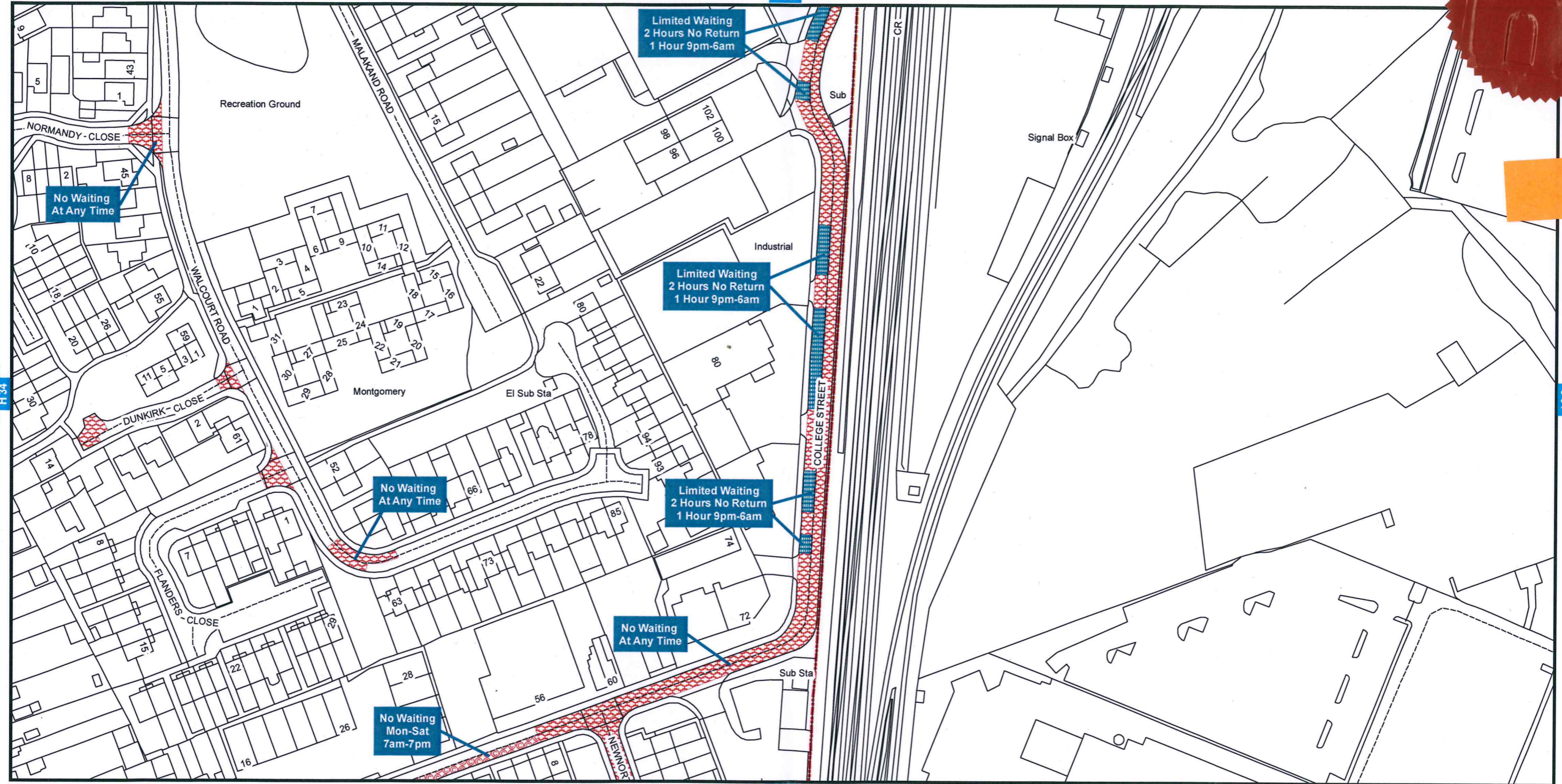

Bedford Borough Council (Kempston) (Prohibition and Restriction of Waiting and Loading and Parking Places) (Consolidation) Order 2018



Bedford Borough Council
Borough Hall
Cauldwell Street
Bedford MK42 9AP

Reproduced from the Ordnance Survey map with the permission of Her Majesty's Stationary Office © Crown Copyright Licence No. LA077127 (2022). Unauthorised reproduction infringes Crown Copyright and may lead to prosecution or civil proceedings.

Scale - 1:1,250 @ A3



Grid Ref: I 33

Revision No: 2
Date: 21/08/2023

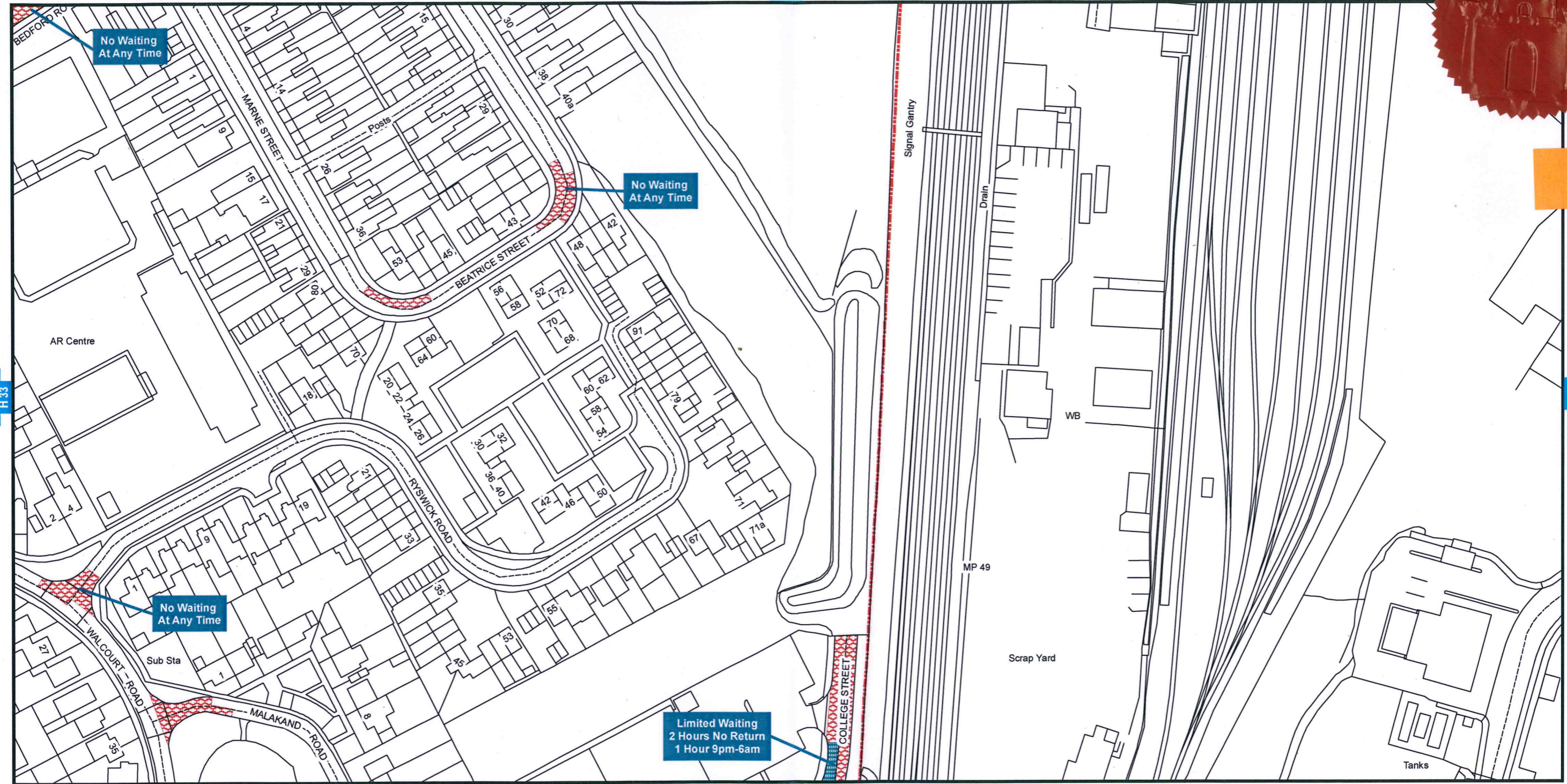

Bedford Borough Council (Kempston) (Prohibition and Restriction of Waiting and Loading and Parking Places) (Consolidation) Order 2018

Bedford Borough Council
Borough Hall
Cauldwell Street
Bedford MK42 9AP



Reproduced from the Ordnance Survey map with the permission of Her Majesty's Stationary Office © Crown Copyright Licence No. LA077127 (2022). Unauthorised reproduction infringes Crown Copyright and may lead to prosecution or civil proceedings.

Scale - 1:1,250 @ A3

