



## **PUBLIC NOTICE**

### **BEDFORD BOROUGH COUNCIL PROPOSE TO INTRODUCE NEW PARKING RESTRICTIONS IN BROMHAM ROAD, BEDFORD**

#### **Reason for Proposal:**

Bedford Borough Council has received a request from Ward Councillors for an extension to existing parking restrictions at the Bromham Road junction with Cutcliffe Grove, Bedford. This is in response to concerns raised over inconsiderate parking at this location which affects access to and egress from driveways, visibility and safety, so these restrictions are intended to remedy that.

#### **Effect of the Proposal:**

1. To extend existing 'No waiting at any time' restriction (double yellow lines) on the following length of road:-

A	Bromham Road, Bedford
(i)	On its southern kerb, from a point approx. 27 metres east of the projected north-eastern side of Cutcliffe Grove (the end of the existing 'No waiting at any time' restriction) extending for a distance of approx. 67.5 metres in an easterly direction (to the end of the existing 'No waiting at any time' restriction at Hurst Grove).

**Relevant proposal documents** may be examined during normal office hours at Borough Hall, Cauldwell Street, Bedford, MK42 9AP. They will also be available for viewing on the council's website at [www.bedford.gov.uk/proposedtro](http://www.bedford.gov.uk/proposedtro). The documents will be placed on deposit until 6 weeks after the Order is made or until it is decided not to continue with the proposal. For further information, please contact Andrew Prigmore at Bedford Borough Council on 01234 228341.

**Comments supporting or objecting to the proposal** should be put in an email, stating the grounds on which they are made, and sent no later than 28<sup>th</sup> November 2024 to [highway.consultations@bedford.gov.uk](mailto:highway.consultations@bedford.gov.uk).

#### **Order Title for the parking restriction changes if made will be:**

1. Bedford Borough Council (Bedford Urban Area (South of the River and Queens Park)) (Prohibition and Restriction of Waiting and Loading and Parking Places) Order 2009 (Amendment No.\*\*\*) Order 20\*\*.

Dated: 31<sup>st</sup> October 2024

Borough Hall, Cauldwell Street  
Bedford, MK42 9AP

Craig Austin  
Director of Environment



**BEDFORD BOROUGH COUNCIL**  
**(BEDFORD URBAN AREA (SOUTH OF THE RIVER AND QUEENS PARK))**  
**(PROHIBITION AND RESTRICTION OF WAITING AND**  
**LOADING AND PARKING PLACES) ORDER 2009**  
**(AMENDMENT NO.69) ORDER 2024**

BEDFORD BOROUGH COUNCIL ("the Council") in exercise of the powers conferred by Sections 1(1), 2(1) to (3) and 4(2) of, and Part IV of Schedule 9 to, the Road Traffic Regulation Act 1984 ("the Act") and of all other powers enabling them in that behalf, and after consultation with the Chief Officer of Police in accordance with Part III of Schedule 9 to the Act, hereby make the following Order:-

1. This Order may be cited as the "Bedford Borough Council (Bedford Urban Area (South of the River and Queens Park)) (Prohibition and Restriction of Waiting and Loading and Parking Places) Order 2009 (Amendment No.69) Order 2024" and shall come into force on 16<sup>th</sup> December 2024.
2. As from the date upon which this Order comes into force the provisions of the Bedford Borough Council (Bedford Urban Area (South of the River and Queens Park)) (Prohibition and Restriction of Waiting and Loading and Parking Places) Order 2009 as amended shall be varied as follows:
  - (i) The plan schedule reference "Grid Ref: H 26 Revision No: 9" shall be deleted and the plan schedule reference "Grid Ref: H 26 Revision No: 10" shall be inserted.
3. This Amendment shall be read and construed as one with the Bedford Borough Council (Bedford Urban Area (South of the River and Queens Park)) (Prohibition and Restriction of Waiting and Loading and Parking Places) Order 2009 as amended.

**THE COMMON SEAL of the  
BEDFORD BOROUGH COUNCIL**

was hereunto affixed this

12<sup>th</sup> day of December 2024

in the presence of:

**Wai K. Tsang  
Solicitor  
Legal Services  
Bedford Borough Council**

*Wai K Tsang*



Authorised Signatory

AUTHORITY FOR EXECUTION		
COUNCIL/COMMITTEE	MINUTE No.	DATE
DELEGATED POWER	By whom executed <b>ENVIRONMENT</b>	29/11/2024
	OFFICERS INITIALS	DATE
ORIGINATED AND CHECKED BY	<b>GM</b>	29/11/2024
APPROVED BY	<b>AP</b>	29/11/2024



**BEDFORD BOROUGH COUNCIL**  
**(BEDFORD URBAN AREA (SOUTH OF THE RIVER AND QUEENS PARK))**  
**(PROHIBITION AND RESTRICTION OF WAITING AND**  
**LOADING AND PARKING PLACES) ORDER 2009**  
**(AMENDMENT NO.69) ORDER 2024**

**STATEMENT OF REASONS**

Bedford Borough Council has received a request from Ward Councillors for an extension to existing parking restrictions at the Bromham Road junction with Cutcliffe Grove, Bedford. This is in response to concerns raised over inconsiderate parking at this location which affects access to and egress from driveways, visibility and safety, so these restrictions are intended to remedy that.





KEY:

- Existing 100mm wide double yellow lines
- New 100mm wide double yellow lines (to match existing) to Diagram 1018.1 of the Traffic Signs Regulations and General Directions 2016.

29/11/2024	TRO	2	GM
24/10/2024	Consultation	1	GM
23/10/2024	Draft	0	GM
DATE	AMENDMENTS	REV	BY



**BEDFORD**  
BOROUGH COUNCIL

**Traffic Management**  
BOROUGH HALL, CAULDWELL ST, BEDFORD, MK42 9AP  
Tel. (01234) 267422

CLIENT  
**Environment**

SCHEME  
**Bromham Road, Bedford**

DRAWING TITLE  
Extension to existing  
'No waiting at any time' restriction  
  
(Double yellow lines)

DRG STATUS <b>TRO</b>	SCALE @ A3 NTS	DATE 03/10/2024	DRAWN GM	CHECKED AP
--------------------------	-------------------	--------------------	-------------	---------------



**Grid Ref: H 26**

**Revision No: 10**  
**Date:16/12/2024**

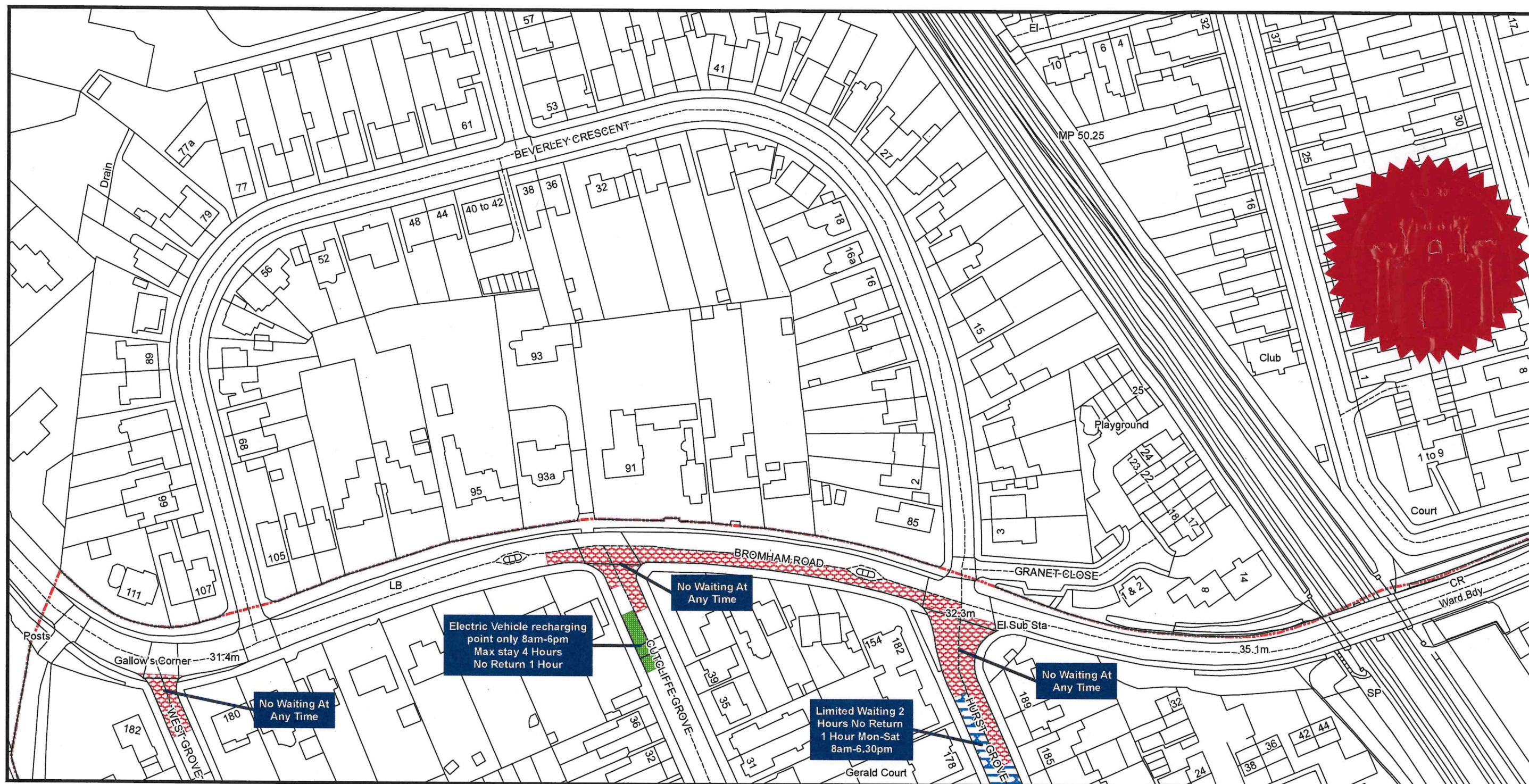

# **Bedford Borough Council (Bedford Urban Area (South of the River and Queens Park)) (Prohibition and Restriction of Waiting and Loading and Parking Places) Order 2009**

**Bedford Borough Council  
Borough Hall  
Cauldwell Street  
Bedford MK42 9AP**



Reproduced from the Ordnance Survey map with the permission of Her Majesty's Stationary Office © Crown Copyright Licence No. AC0000806481 2024. Unauthorised reproduction infringes Crown Copyright and may lead to prosecution or civil proceedings.

**Scale - 1:1,250**

