



**BEDFORD BOROUGH COUNCIL**  
**OFF STREET PARKING PLACES ORDER 2019**  
**(AMENDMENT NO.8) ORDER 2025**

Bedford Borough Council ("the Council") in exercise of the powers conferred by Sections 1(1), 2(1) to (3), 4(2), 32, 35(1) and 35(3) of, and Part IV of Schedule 9 to, the Road Traffic Regulation Act 1984 as amended ("the Act"), the Traffic Management Act 2004, The Civil Enforcement of Parking Contraventions (Bedford) Designation Order 2009 and of all other powers enabling them in that behalf, and after consultation with the Chief Officer of Police in accordance with Part III of Schedule 9 to the Act, hereby make the following Order:-

- 1) This Order may be cited as the "Bedford Borough Council Off Street Parking Places Order 2019 (Amendment No.8) Order 2025" and shall come into force on 19<sup>th</sup> January 2026.
- 2) As from the date upon which this Order comes into operation the provisions of the Bedford Borough Council Off Street Parking Places Order 2019 as amended shall be varied as follows:
  - (i) The section listed in Schedule 1 to this Order shall be deleted.
  - (ii) The sections listed in Schedule 2 to this Order shall be inserted in place of the deleted sections listed in Schedule 1 to this Order.
- 3) This amendment shall be read and construed as one with the Bedford Borough Council Off Street Parking Places Order 2019 as amended.

## SCHEDULE 1

### Sections to be deleted from the Bedford Borough Council Off Street Parking Places Order 2019 as amended:

Borough Hall	Monday to Friday 09:00 – 17:00	Vehicle height limit Vehicle weight limit  <u>Maximum parking period</u> Disabled parking spaces – 2 hours Electric vehicle charging spaces – 3 hours with no return within 1 hour General parking spaces – 1 hour with no return within 3 hours  No Borough Hall staff parking	2.2 metres (7'2") 2.5 tonnes
--------------	--------------------------------	---	---------------------------------

## SCHEDULE 2

### Sections to be inserted into the Bedford Borough Council Off Street Parking Places Order 2019 as amended:

Borough Hall	Monday to Friday 09:00 – 17:00	Vehicle height limit Vehicle weight limit  <u>Maximum parking period</u> Visitor Disabled parking spaces – 2 hours where specified Electric vehicle charging spaces – 3 hours with no return within 1 hour Visitor parking spaces – 1 hour with no return within 3 hours  Vehicles must be parked in marked bays only	2.2 metres (7'2") 2.5 tonnes
--------------	--------------------------------	---	---------------------------------

**THE COMMON SEAL of the  
BEDFORD BOROUGH COUNCIL**

was hereunto affixed this

8<sup>th</sup> day of January 2026

in the presence of:



David Doorne  
Solicitor  
Service Manager (GPPL)  
Legal Services  
Bedford Borough Council



Authorised Signatory

AUTHORITY FOR EXECUTION		
COUNCIL/COMMITTEE	MINUTE No.	DATE
DELEGATED POWER	By whom executed <b>ENVIRONMENT</b>	24/08/2022
	OFFICERS INITIALS	DATE
ORIGINATED AND CHECKED BY	<b>DG</b>	05/01/2026
APPROVED BY	<b>AP</b>	05/01/2026



**BEDFORD BOROUGH COUNCIL**  
**OFF STREET PARKING PLACES ORDER 2019**  
**(AMENDMENT NO.8) ORDER 2025**

**STATEMENT OF REASONS**

To improve safety, accessibility, and efficient use of parking space by ensuring all vehicles parked within designated bays.



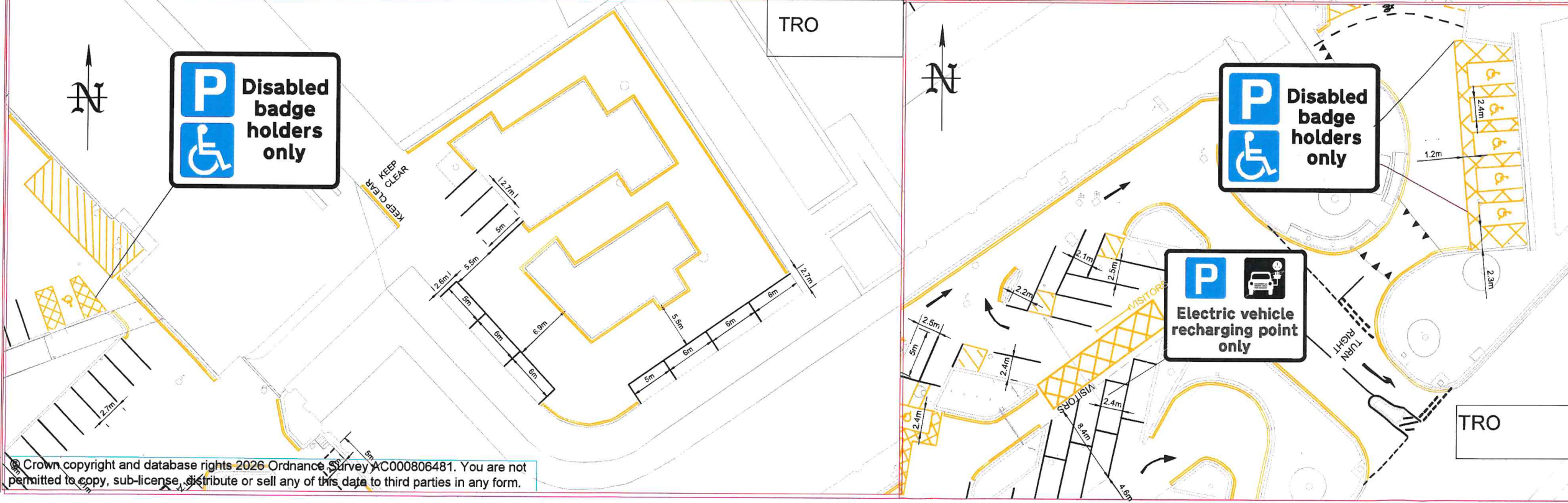
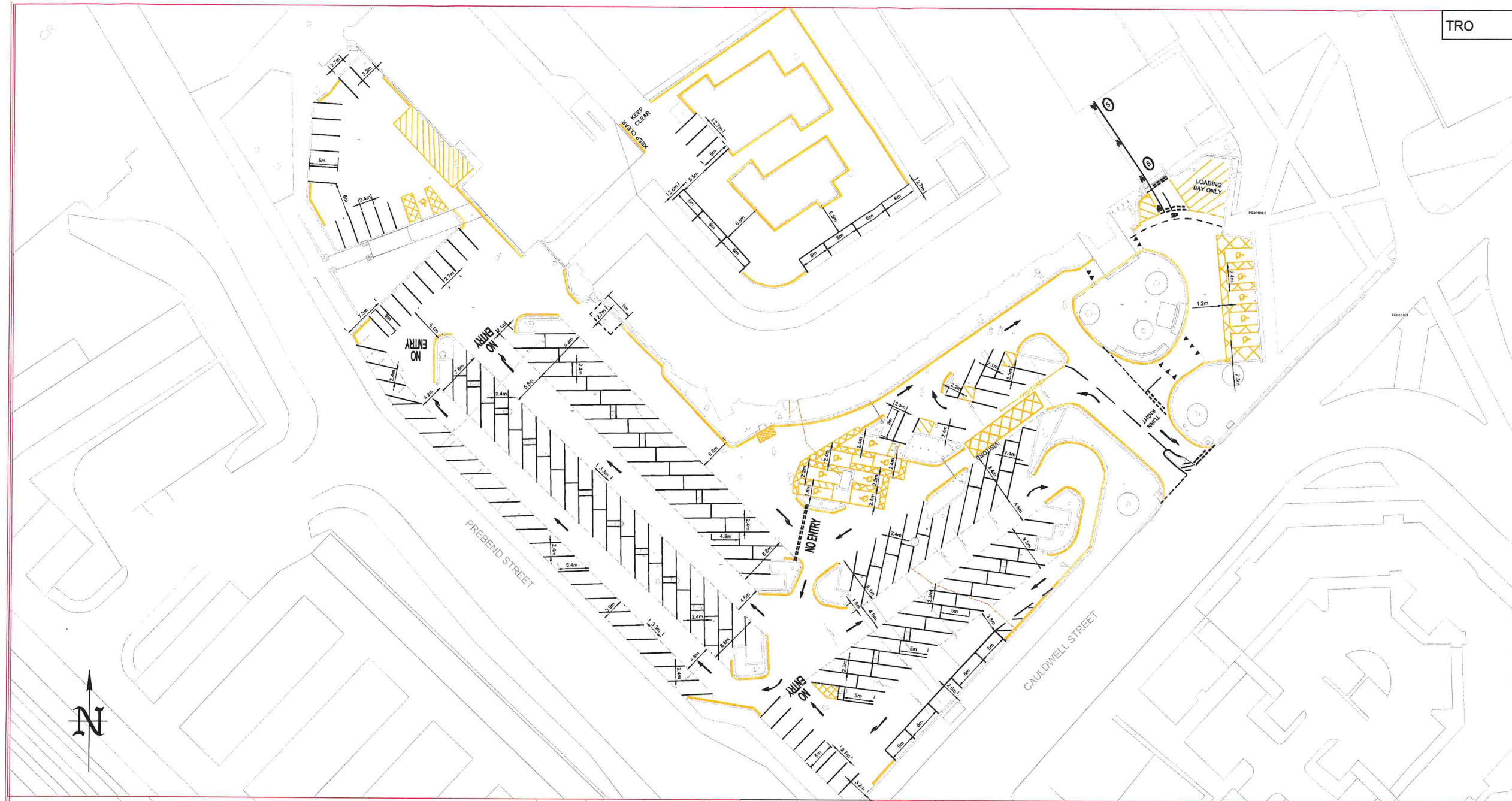

TRO

PRINTS FROM THIS DRAWING ARE UNCONTROLLED UNLESS OTHERWISE STATED

A3

All existing parking restrictions to remain

All vehicles must park within marked bays

08/01/2026

TRO

2

DG

24/11/2025

Consultation

1

DG

DATE

AMENDMENTS

REV

BY

**BEDFORD**  
BOROUGH COUNCIL

Traffic Management

BOROUGH HALL, CAULDWELL ST, BEDFORD, MK42 9AP  
Tel. (01234) 267422

CLIENT

Environment

SCHEME

Borough Hall Car Park  
PPO

DRAWING TITLE

Implementation of existing  
bays and restrictions

DRG STATUS

TRO

SCALE @ A3  
NTS

DATE  
10/11/2025

DRAWN  
SA

CHECKED  
DG