

10mm
0
-10mm

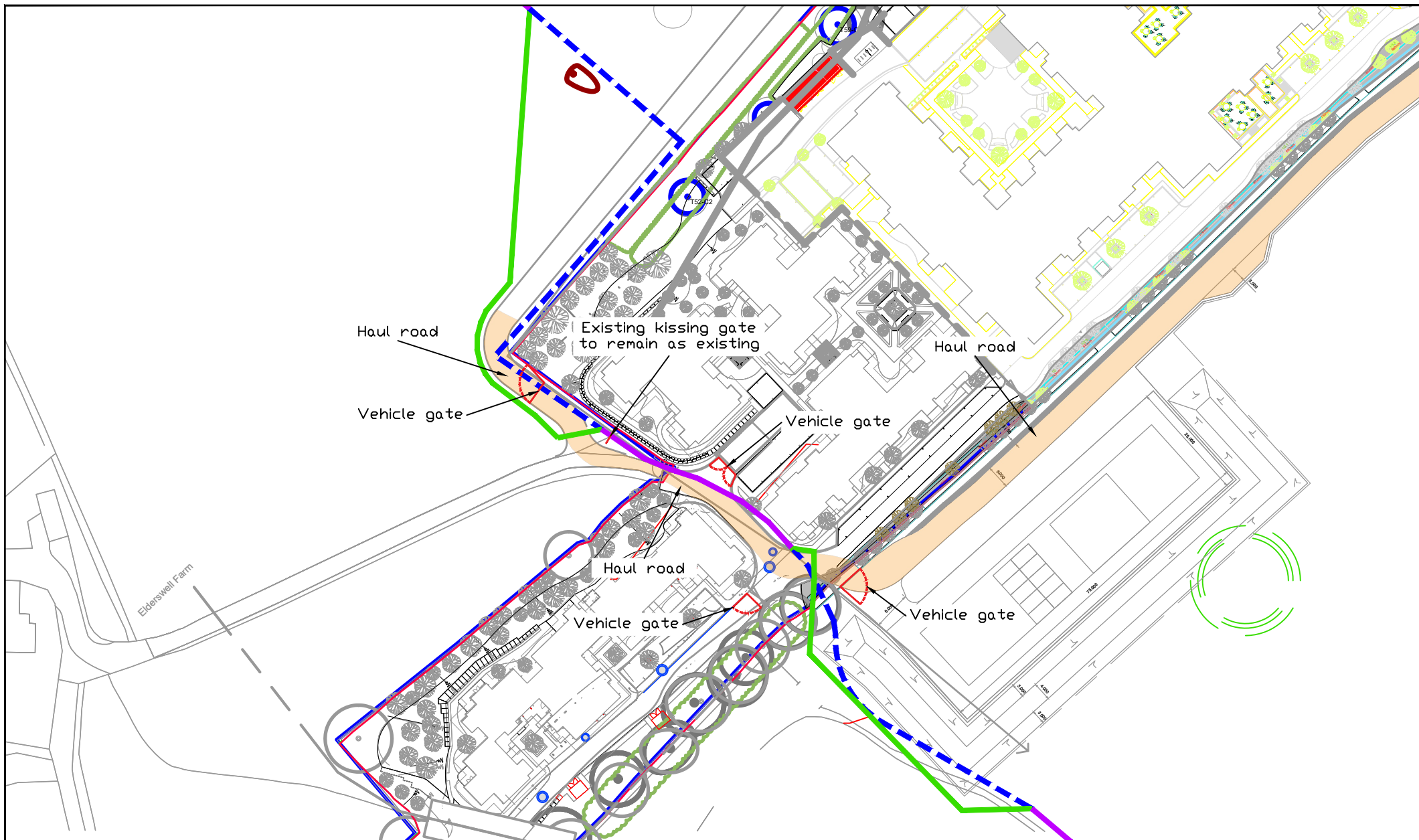

Based upon the Ordnance Survey Map with the permission of the Controller of H.M. Stationary Office @ Crown Copyright Contract No. 100048330

Key

- Footpath to remain as existing during construction
- Footpath to temporarily be diverted to new alignment during construction
- Temporary alignment of footpath during construction
- Construction haul road

PROJECT
CARE VILLAGE, TURVEY

DRAWING TITLE
PROPOSED TEMPORARY FOOTPATH
DIVERSION DURING PHASE 2
CONSTRUCTION

DRAWN BY	CHECKED BY	APPROVED BY	DATE	SCALES @ A3 SIZE	ISSUE STATUS
BL	JN	JN	19.11.24	1:750	PLANNING

CLIENT
INSPIRED VILLAGES

sdd
SUSTAINABLE DEVELOPMENT AND DELIVERY
A specialist team within DLP Planning Ltd

dip
DLP PLANNING LIMITED
A specialist team within DLP Planning Ltd

DRAWING NUMBER	REV.
BE691-61PD-001	A

CAD FILE NAME : BE691-61PD-001

A	Updated based on client comments	BL	JN	JN	22.11.24
REV		DR	CH	AP	DATE