



## PUBLIC NOTICE

### **BEDFORD BOROUGH COUNCIL PROPOSE TO INTRODUCE NEW PARKING RESTRICTIONS IN ABBEYFIELDS, BEDFORD**

#### **Reason for Proposal:**

Bedford Borough Council has received a request from Elstow Parish Council for new parking restrictions in Abbeyfields. This is in response to concerns raised over parking which affects free movement of vehicles, visibility and safety, so these restrictions are intended to remedy that.

#### **Effect of the Order:**

1. To introduce “No waiting at any time” restrictions (double yellow lines) on the following lengths of road:

A	Abbeyfields, Bedford
(i)	On its southern kerb, extending from a point approx. 2 metres east of the projected boundary between nos. 3 and 5 Abbeyfields in an easterly direction to a point approx. 4 metres east of the projected western flank wall of no. 2 Abbeyfields.
(ii)	On its southern kerb, extending from a point approx. 40 metres east of the projected western flank wall of no. 2 Abbeyfields for a distance of approx. 20 metres in an easterly direction.
(iii)	On the eastern side of the access road between nos. 1 and 2 Abbeyfields, extending from the junction with Abbeyfields for a distance of approx. 10 metres in a southerly direction (up to the northern edge of the rumble strip).
(iv)	On the western side of the access road between nos. 1 and 2 Abbeyfields, extending from the junction with Abbeyfields for a distance of approx. 8.5 metres in a southerly direction (up to the northern edge of the rumble strip).
(v)	On its southern kerb, extending from the projected western flank wall of no. 62 Sandleford Drive for a distance of approx. 37.5 metres in a westerly direction.

**Relevant proposal documents** may be examined during normal office hours at Borough Hall, Cauldwell Street, Bedford, MK42 9AP. They will also be available for viewing on the council's website at [www.bedford.gov.uk/proposedtro](http://www.bedford.gov.uk/proposedtro). The documents will be placed on deposit until 6 weeks after the Order is made or until it is decided not to continue with the proposal. For further information, please contact Andrew Prigmore at Bedford Borough Council on 01234 228341.

**Comments supporting or objecting to the proposal** should be put in an email, stating the grounds on which they are made, and sent no later than 31<sup>st</sup> October 2024 to [highway.consultations@bedford.gov.uk](mailto:highway.consultations@bedford.gov.uk).

#### **Order Title if made will be:**

1. Bedford Borough Council (Bedford Urban Area (South of the River and Queens Park)) (Prohibition and Restriction of Waiting and Loading and Parking Places) Order 2009 (Amendment No.\*\*\*) Order 20\*\*.

Dated: 3<sup>rd</sup> October 2024

Borough Hall, Cauldwell Street  
Bedford, MK42 9AP

Craig Austin  
Director of Environment



**BEDFORD**  
BOROUGH COUNCIL

**BEDFORD BOROUGH COUNCIL**  
**(BEDFORD URBAN AREA (SOUTH OF THE RIVER AND QUEENS PARK))**  
**(PROHIBITION AND RESTRICTION OF WAITING AND**  
**LOADING AND PARKING PLACES) ORDER 2009**  
**(AMENDMENT NO.64) ORDER 2024**

BEDFORD BOROUGH COUNCIL ("the Council") in exercise of the powers conferred by Sections 1(1), 2(1) to (3) and 4(2) of, and Part IV of Schedule 9 to, the Road Traffic Regulation Act 1984 ("the Act") and of all other powers enabling them in that behalf, and after consultation with the Chief Officer of Police in accordance with Part III of Schedule 9 to the Act, hereby make the following Order:-

1. This Order may be cited as the "Bedford Borough Council (Bedford Urban Area (South of the River and Queens Park)) (Prohibition and Restriction of Waiting and Loading and Parking Places) Order 2009 (Amendment No.64) Order 2024" and shall come into force on 11<sup>th</sup> November 2024.
2. As from the date upon which this Order comes into force the provisions of the Bedford Borough Council (Bedford Urban Area (South of the River and Queens Park)) (Prohibition and Restriction of Waiting and Loading and Parking Places) Order 2009 as amended shall be varied as follows:
  - (i) The plan schedule reference "Grid Ref: M 37 Revision No: 0" shall be inserted.
3. This Amendment shall be read and construed as one with the Bedford Borough Council (Bedford Urban Area (South of the River and Queens Park)) (Prohibition and Restriction of Waiting and Loading and Parking Places) Order 2009 as amended.

**THE COMMON SEAL of the  
BEDFORD BOROUGH COUNCIL**

was hereunto affixed this  
7<sup>th</sup> day of November 2024  
in the presence of:



**Wai K. Tsang**  
**Solicitor**  
**Legal Services**  
**Bedford Borough Council**

*W. K. Tsang*

Authorised Signatory

AUTHORITY FOR EXECUTION		
COUNCIL/COMMITTEE	MINUTE No.	DATE
DELEGATED POWER	By whom executed <b>ENVIRONMENT</b>	01/11/2024
	OFFICERS INITIALS	DATE
ORIGINATED AND CHECKED BY	<b>GM</b>	01/11/2024
APPROVED BY	<b>AP</b>	01/11/2024



**BEDFORD BOROUGH COUNCIL**  
**(BEDFORD URBAN AREA (SOUTH OF THE RIVER AND QUEENS PARK))**  
**(PROHIBITION AND RESTRICTION OF WAITING AND**  
**LOADING AND PARKING PLACES) ORDER 2009**  
**(AMENDMENT NO.64) ORDER 2024**

**STATEMENT OF REASONS**

Bedford Borough Council has received a request from Elstow Parish Council for new parking restrictions in Abbeyfields. This is in response to concerns raised over parking which affects free movement of vehicles, visibility and safety, so these restrictions are intended to remedy that.



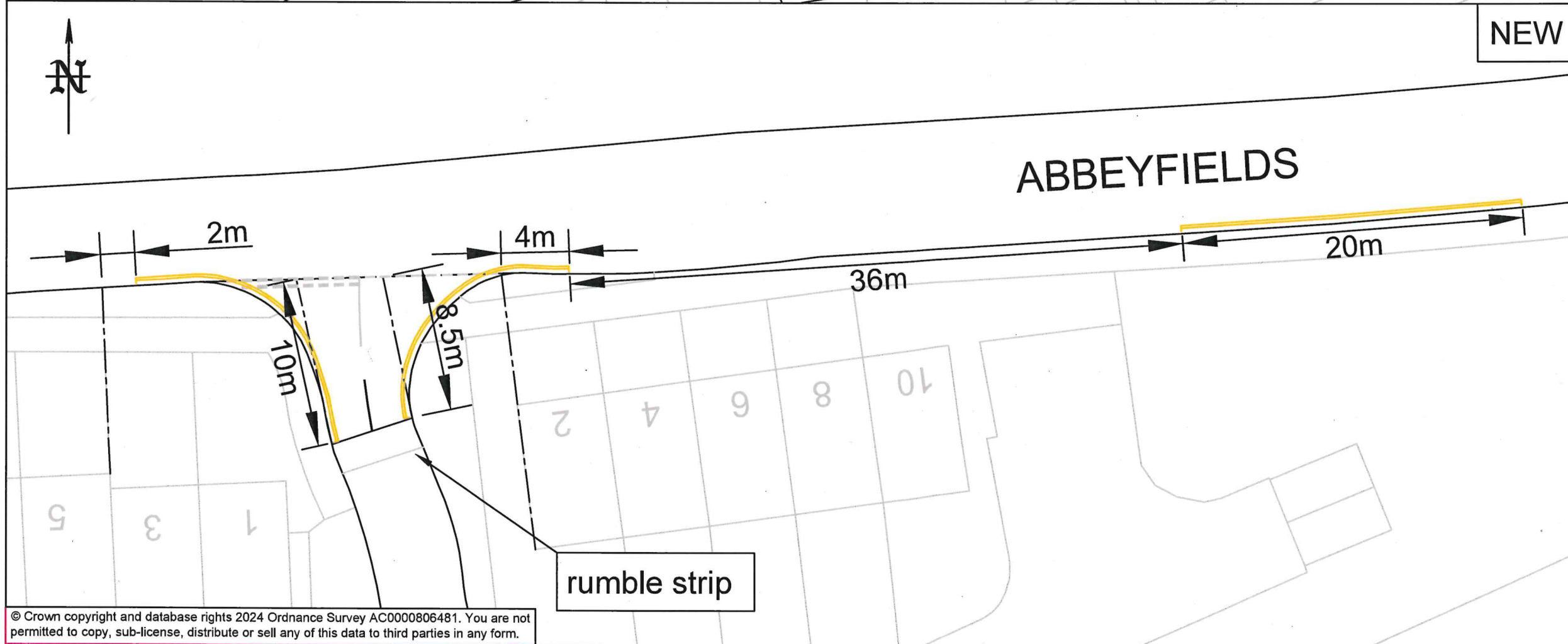

**KEY:**

- Existing road markings
- New 75mm wide double yellow lines to Diagram 1018.1 of the Traffic Signs Regulations and General Directions 2016.



01/11/2024	TRO	3	GM
04/09/2024	Additional restriction added	2	GM
18/07/2024	Consultation	1	GM
27/06/2024	First Issue	0	GM
DATE	AMENDMENTS	REV	BY



**Traffic Management**  
BOROUGH HALL, CAULDWELL ST, BEDFORD, MK42 9AP  
Tel. (01234) 267422

CLIENT  
**Environment**

SCHEME  
**Abbeyfields, Bedford.**

DRAWING TITLE  
**New 'No waiting at any time' restriction**

(Double yellow lines)

DRG STATUS  
**TRO**

SCALE @ A3	DATE	DRAWN	CHECKED
NTS	27/06/2024	GM	AP



Grid Ref: M 37

Revision No: 0  
Date: 11/11/2024

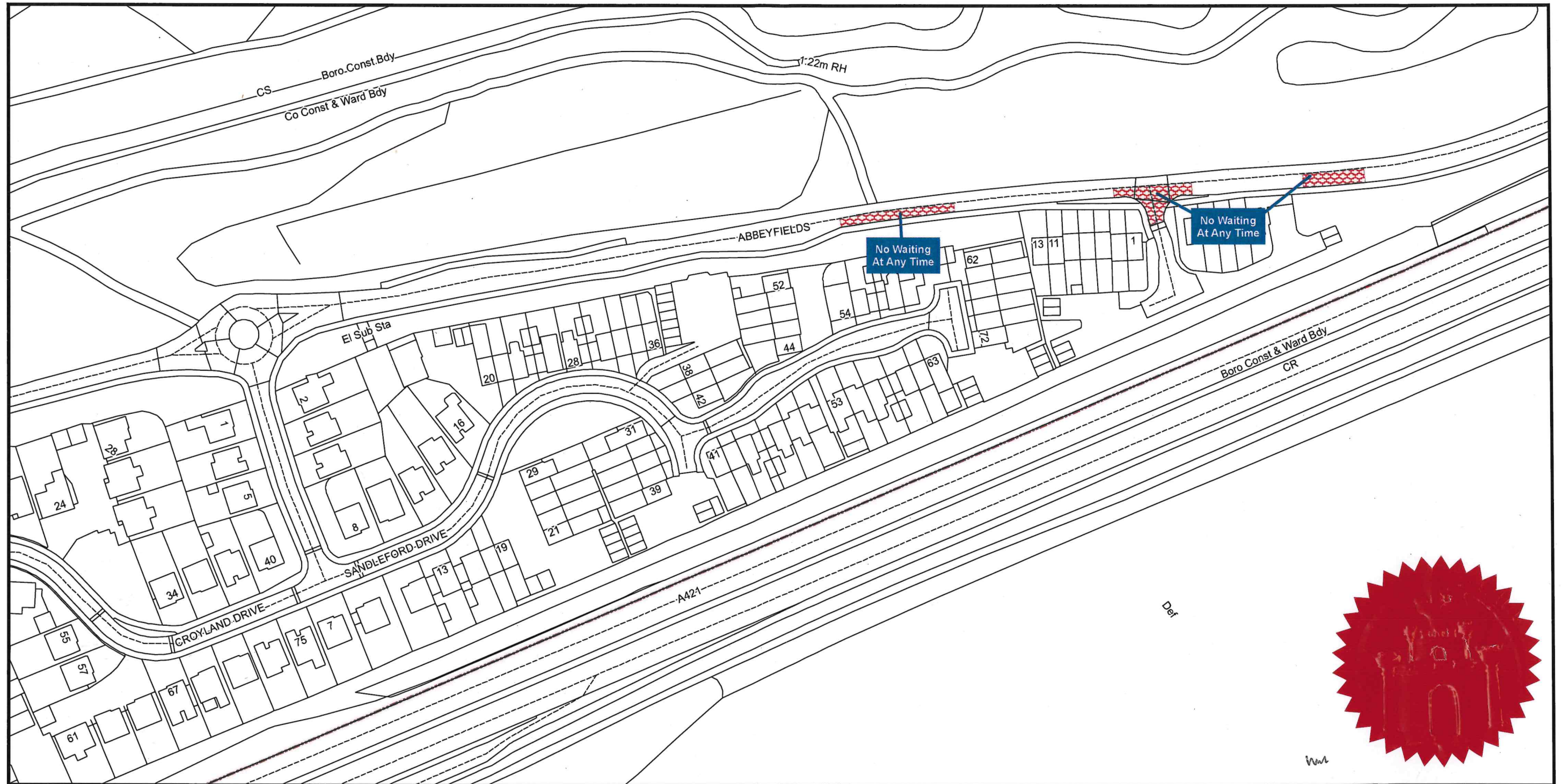

**Bedford Borough Council (Bedford Urban Area (South of the  
River and Queens Park)) (Prohibition and Restriction of  
Waiting and Loading and Parking Places) Order 2009**

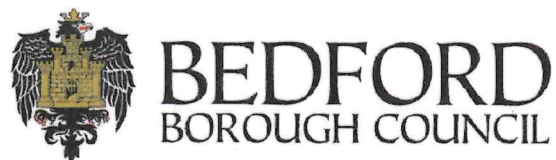

Bedford Borough Council  
Borough Hall  
Cauldwell Street  
Bedford MK42 9AP

Reproduced from the Ordnance Survey map with the permission of Her Majesty's Stationary Office © Crown Copyright Licence  
No. AC0000806481 2024. Unauthorised reproduction infringes Crown Copyright and may lead to prosecution or civil proceedings.

Scale - 1:1,250

